

Public Notice

US ARMY CORPS
OF ENGINEERS
St. Louis District
Gateway to Excellence

Reply To:
U.S. Army Corps of Engineers
Attn: CEMVS-OD-F
1222 Spruce Street
St. Louis, Missouri 63103-2833

Public Notice No.
P-2841

Public Notice Date:
May 21, 2013

Expiration Date:
June 10, 2013

Postmaster Please Post Conspicuously Until:

File Number: MVS-2012-668

Interested parties are hereby notified that an application has been received for a Department of the Army permit for certain work in waters of the United States, as described below and shown on the attached maps.

COMMENTS AND ADDITIONAL INFORMATION: Comments on the described work should reference the U.S. Army Corps of Engineers File Number shown above and must reach this office no later than the above expiration date of the Public Notice to become part of the record and be considered in the decision. Comments should be mailed to the following address:

U.S. Army Corps of Engineers
Regulatory Branch
1222 Spruce Street
St. Louis, Missouri 63103-2833
ATTN: Jennifer L. Brown

APPLICANT: City of Wildwood, Attention: Ryan Thomas, 183 Plaza Drive, Wildwood, Missouri 63040.

LOCATION: The project is located at 2051 Hwy 109 in the City of Wildwood. The project area is bordered to the east by Hwy 109 and to the north and west by a combination of forest and pasture. The project is located in Section 35, Township 45 North, Range 3 East, St. Louis County, Missouri.

PROJECT DESCRIPTION: The applicant seeks authorization to conduct grading and filling operations in waters of the United States for the creation of a community park in the City of Wildwood. The park will be constructed in several phases for funding purposes. Phase I construction includes the installation of a precast arch box culvert within Bonhomme Creek for the creation of a roadway through the site. In addition, plans include the installation of a culvert within an unnamed tributary to Bonhomme Creek for the construction of a sidewalk to access the dog park. Two outlet structures will also be constructed for onsite bioretention areas. One structure will outfall into the unnamed tributary to Bonhomme Creek and one will outfall into Bonhomme Creek. The only expected impact for future phases is an additional crossing of Bonhomme Creek, which will be similar to the structure proposed in Phase I.

In order to access the new community park, the City is proposing to construct an entrance road that connects

the park to Hwy 109. To install the entrance, the City is proposing to reroute an existing section of an unnamed tributary to Bonhomme Creek. The proposed tributary relocation would allow for the City of Wildwood to widen, extend and enhance the section of Pond Grover Loop Road (formerly known as Kress Lane) that exists to the west of Hwy 109. The existing road on this property is a single-lane road that once existed as a driveway to a residential property.

The tributary currently enters the site from the northern property boundary and flows east to west through the property, parallel to the existing Pond Grover Loop Road. The tributary has a muck, rock and cobble substrate and is approximately 10 feet wide. The unnamed tributary is considered an intermittent stream and is bordered to the north and west by a mature riparian corridor.

The applicant proposes to relocate a section of the channel to the north of its existing location to allow for the expansion of the roadway and trail. The relocated (constructed) section of channel is proposed to be approximately 425 linear feet in length. Upon completion of the channel relocation project, approximately 487 linear feet of the existing unnamed tributary is proposed to be filled

The channel relocation portion of the project will include the clearing of approximately 1.45-acres of the existing forested riparian corridor. The relocated section of channel will measure 8 feet wide and will have a flattened bottom. The applicant also proposes to incorporate several riffle and grade control structures composed of riprap and filter fabric.

Although the City of Wildwood researched alternatives and attempted to minimize proposed impacts to the unnamed tributary to Bonhomme Creek, they believe that the impacts are unavoidable. The applicant is currently exploring mitigation options with an emphasis on improvements to the relocated section of stream.

LOCATION MAPS AND DRAWINGS: See attached. In addition, the project plans may be viewed in color and in more detail by visiting the Public Notice section of our website at <http://www.mvs.usace.army.mil/ConOps/permits/pn.htm>

ADDITIONAL INFORMATION: Additional information may be obtained by contacting Jennifer L. Brown, Project Manager, U.S. Army Corps of Engineers, at (314) 331-8579. Your inquiries may also be sent by electronic facsimile to (314) 331-8741 or by e-mail to Jennifer.L.Brown@usace.army.mil.

AUTHORITY: This permit will be processed under Section 404 of the Clean Water Act (33 U.S.C. 1344).

WATER QUALITY CERTIFICATION: Section 401 of the Clean Water Act (33 USC 1341) requires that all discharges of dredged or fill material must be certified by the appropriate state agency as complying with applicable effluent limitations and water quality standards. The project plans will be submitted to the Missouri Department of Natural Resources, Water Protection Program (the Agency) in accordance with Section 401. While the Corps of Engineers may provide all relevant information to DNR and request Section 401 review on behalf of the applicant, the applicant assumes final responsibility to ensure that both agencies receive all information required to complete their independent review. If issued, Certification will express the Agency's opinion that the proposed activities will not violate applicable water quality standards. Written comments concerning possible impacts to waters of Missouri should be addressed to: Water Protection Program, P.O. Box 176, Jefferson City, Missouri 65102-0176, with a copy provided to the Corps of Engineers.

SECTION 404 (b)(1) EVALUATION: The impact of the activity on the public interest will be evaluated in

accordance with the Environmental Protection Agency guidelines pursuant to Section 404 (b)(1) of the Clean Water Act.

PUBLIC HEARING: Any person may request, in writing, within the comment period specified in this notice, that a public hearing be held to consider the applicant's proposal. Any request for a public hearing shall state, with particularity, the reason for the hearing, and must be based on issues that would warrant additional public review.

ENDANGERED SPECIES: The proposed project is within the range of the endangered Indiana bat (*Myotis sodalis*). A preliminary determination, in compliance with the Endangered Species Act as amended, has been made that this activity may affect the habitat of the listed species. In order to further complete our evaluation, written comments are solicited by this public notice from the U.S. Fish and Wildlife Service and other interested agencies and individuals.

CULTURAL RESOURCES: The St. Louis District will evaluate information provided by the State Historic Preservation Officer and the public in response to this public notice and we may require a reconnaissance survey of the project area.

EVALUATION: The decision whether to issue a permit will be based on an evaluation of the probable impact including cumulative impacts of the described activity on the public interest. That decision will reflect the national concern for both protection and utilization of important resources. The benefit that may reasonably be expected to accrue from the described activity must be balanced against its reasonably foreseeable detriments. All factors, which may be relevant to the activity described, will be considered including the cumulative effects. Among factors considered are: conservation; economics; aesthetics; general environmental concerns; wetlands; historic properties; fish and wildlife values; flood hazards; flood plain values; land use; navigation; shoreline erosion and accretion; recreation; water supply and conservation; water quality; energy needs; safety; food and fiber production; mineral needs; consideration of property ownership; and in general the needs and welfare of the people.

SOLICITATION OF COMMENTS: The U.S. Army Corps of Engineers is soliciting comments from the public; Federal, state, and local agencies and officials; Indian Tribes; and other interested parties in order to consider and evaluate the impacts of the proposed activity. Any comments received will be considered by the U.S. Army Corps of Engineers to determine whether to issue, modify, condition or deny a permit for this proposal. To make this decision, comments are used to assess impacts on endangered species, historic properties, water quality, general environmental effects, and other public interest factors listed above. Comments are used in the preparation of an Environmental Assessment and/or an Environmental Impact Statement pursuant to the National Environmental Policy Act. Comments are also used to determine the need for a public hearing and to determine the overall public interest of the proposed activity.



DANNY D. MCCLENDON
Chief, Regulatory Branch

Attachments

NOTICE TO POSTMASTERS:

It is requested that this notice be conspicuously and continually placed for 21 days from the date of this issuance of this notice.

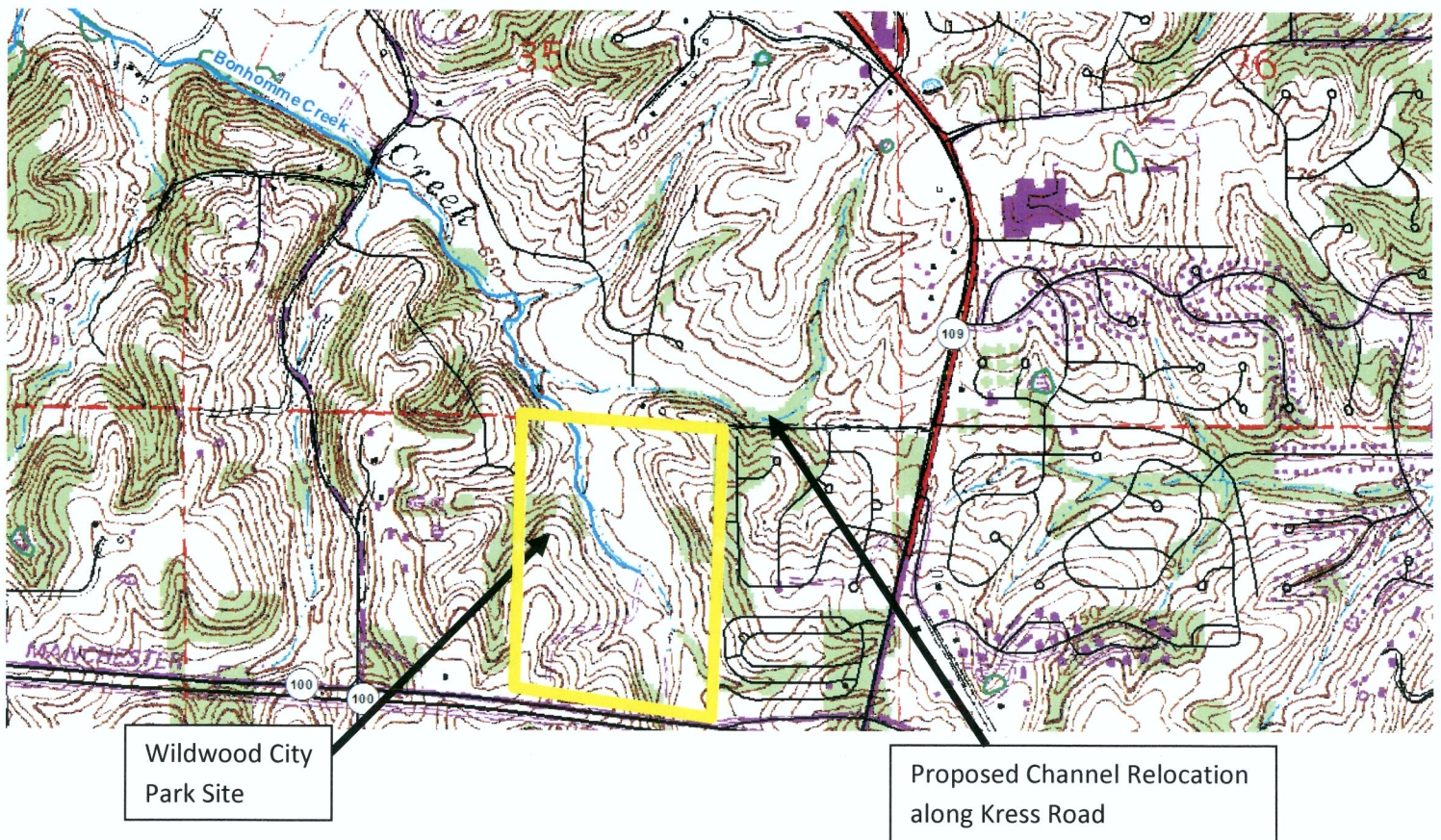
Attachment 1 of 5





30 November 2012: Facing downstream at the downstream portion of the Kress Road proposed relocation project.



30 November 2012: Facing downstream at the unnamed tributary along the Kress Road proposed relocation project.

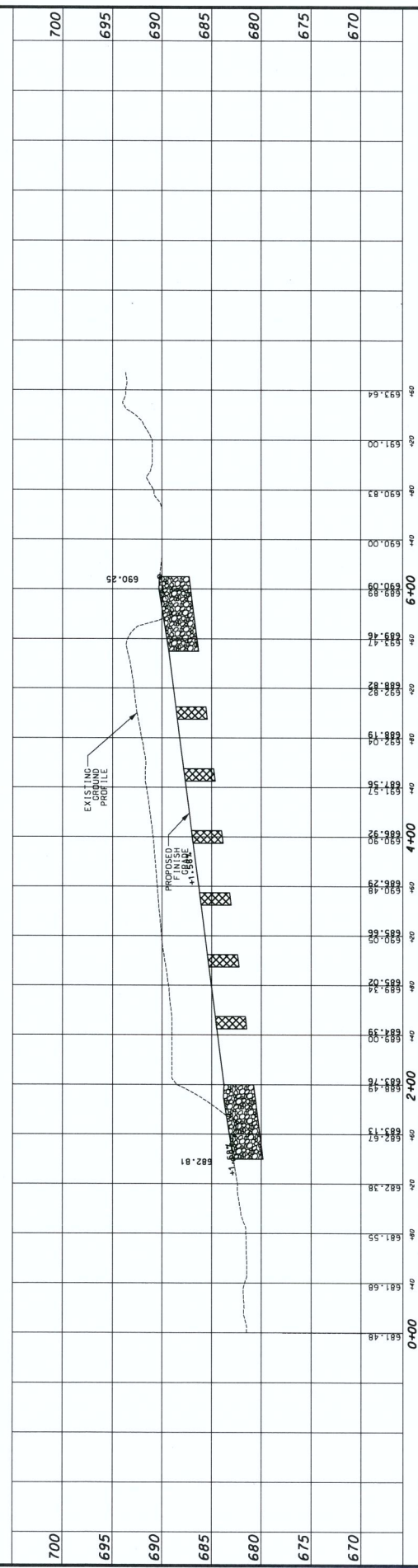
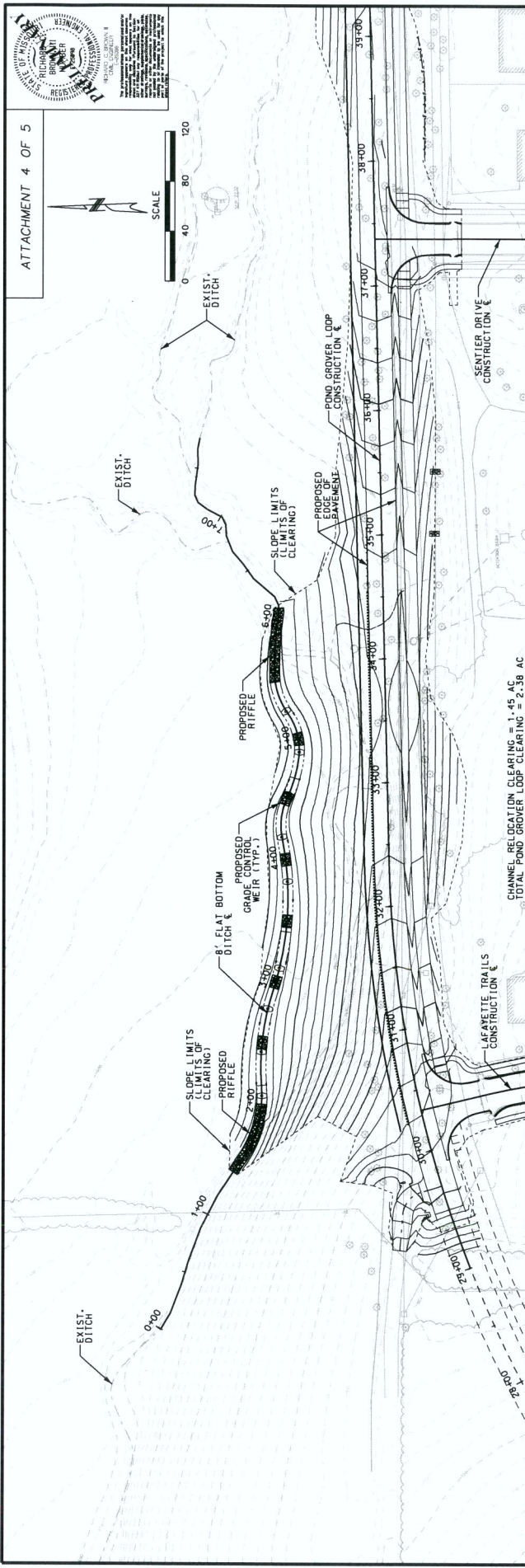

NO.	DATE	BY	REVISION DESCRIPTION

DRAWN BY: ERS
 APPROVED: RCB
 CAD DATE: 2/14/2013
 CAD FILE: UNCH02500.dwg

JOB DATE: SPRING 2012
 JOB NUMBER: 75100010
 12:47:51 PM
 UNCH02500.dwg

H2G
 H2Green
 445 GREEN, INC.
 18205 SANDY CREEK ROAD SUITE 202
 P.O. BOX 394990
 CORPORATE LICENSE #20206608

POND GROVER LOOP ROAD
 CITY OF WILDWOOD
 ST. LOUIS COUNTY, MISSOURI

CHANNEL GRADING PLANS
 PLAN AND PROFILE
 (Sheet 1 of X)
 SHEET NO.
CGP-01
 X of 27

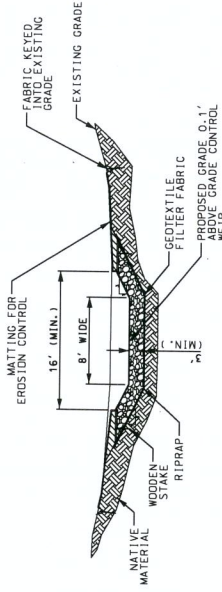

TYPICAL GRADE CONTROL WEIR CROSS SECTION
N.T.S.

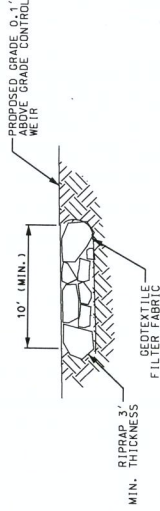

TYPICAL GRADE CONTROL WEIR PROFILE
N.T.S.

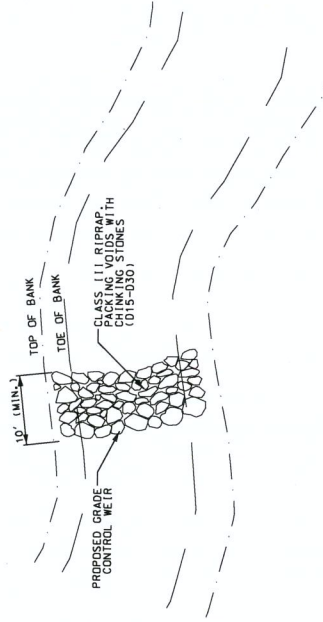

TYPICAL GRADE CONTROL WEIR PLAN
N.T.S.

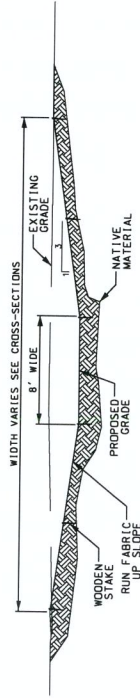

TYPICAL VEGETATED SWALE CROSS SECTION
N.T.S.

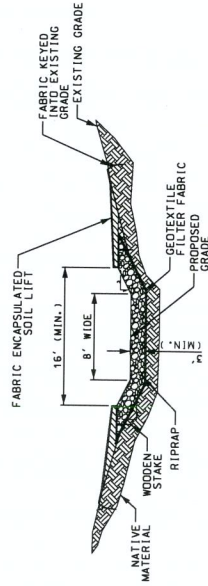

TYPICAL RIFFLE CROSS-SECTION
N.T.S.

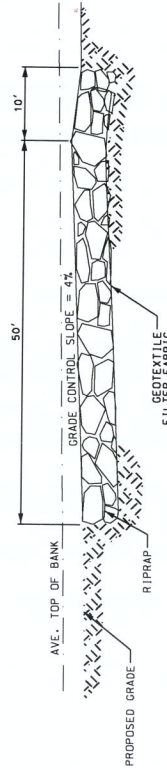

TYPICAL RIFFLE PROFILE
N.T.S.

DRAWN BY: ERS APPROVED: RCB CAD DATE: 2/14/2013 CAD FILE: \LUNBER\2004\lunber\250000\CD\lunber\CD 02 250000 002.dwg		JOB DATE: SPRING 2012 JOB NUMBER: 25100010 12:50:59 PM		NO. DATE BY REVISION DESCRIPTION	
HRGreen 1433 1433 GREEN, INC. SUITE 201 1800 SHAWLORE MISSOURI CITY ST. LOUIS, MISSOURI 63103 CORPORATE LICENSE # 000000008		POND GROVER LOOP ROAD CITY OF WILDWOOD ST. LOUIS COUNTY, MISSOURI		CHANNEL GRADING PLANS GRADE CONTROL DETAILS (Sheet 2 of X)	
SHEET NO. CGP-02 X of 27					

OUR PUBLIC NOTICES ARE NOW AVAILABLE ON THE WORLD WIDE WEB AT OUR ST. LOUIS DISTRICT HOME PAGE (<http://www.mvs.usace.army.mil/ConOps/permits/pn.htm>). If you have any trouble, please call Danny McClendon at (314) 331-8574 or by e-mail to: Danny.D.McClendon@usace.army.mil

WE ARE ATTEMPTING TO REDUCE OUR PUBLIC NOTICE MAILING COSTS; CHECK OUR WEB PAGE THEN CONTACT US TO HAVE YOUR NAMED REMOVED FROM OUR MAILING LIST, please call Jaynie Doerr at (314) 331-8581, or by email to: Jaynie.G.Doerr@usace.army.mil, or mail this cover-sheet to the St. Louis District, OD-F, 1222 Spruce Street, St. Louis, MO 63103-2833, ATTN: Regulatory Branch, indicating that your name or company named be removed. Changes to our mailing list may take a few weeks to take effect.

US ARMY ENGINEER DISTRICT, ST. LOUIS
ATTN: CEMVS-OD-F
1222 SPRUCE STREET
ST. LOUIS, MISSOURI 63103-2833