

AUGUST 6, 2014
INTERPOLATED WATER SURFACE ELEVATIONS

MILE	LWRP	WS 08:00	WS 09:00	LWRP DIFF	LWRP DIFF
185.3	LD27 (POOL)	396.00	400.90	08:00	09:00
				4.9	4.9



GAGE RECORD	
WATER SURFACE	L&D 27 (POOL)
ZERO N.C.V.D.	350.00
MILE	185.3
L.W.R.P.	396.00
DATE	06 AUGUST 2014
ST. LOUIS	379.94
ME/PRI/CE (TW)	395.48
	200.5
	395.30
	376.4
Elevations are referred to local - contours are below 195.27' low water reference plane LWRP (185.00' CFS)	

Survey Date:	August 06, 2014
Submitted by:	HANSON
Drawn by:	TCU
Reviewed by:	
APPROVED:	Chief, Geospatial Branch
File Name:	194_180604_Lwrp.dgn
Plot Date:	August 08, 2014
Plot Scale:	1"=400'

U.S. ARMY ENGINEER DIVISION	MISSISSIPPI RIVER
CORPS OF ENGINEERS	MISSISSIPPI RIVER
ST. LOUIS, MISSOURI	
UPPER MISSISSIPPI RIVER BASIN	

240 METERS	800 FEET
120	400
0	0
THE INFORMATION DEPICTED ON THIS MAP REPRESENTS THE RESULTS OF A CHANNEL SURVEY CONDUCTED UNDER THE GENERAL CONDITIONS LISTED AT THE END OF THIS REPORT.	
CHANNEL SURVEY	
MILE: 200.5-145.8	

PLATE NUMBER

MOSENTHIE REACH CONFLUENCE WEIRS

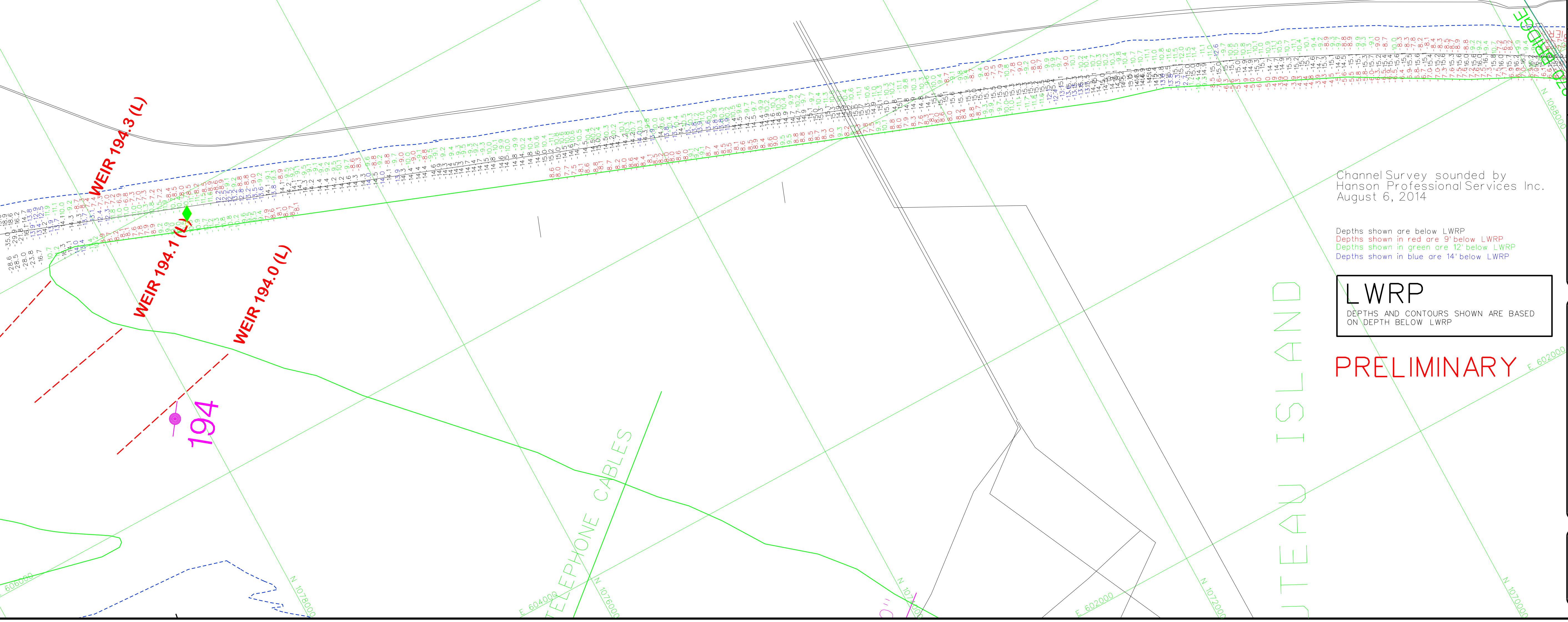

Channel Survey sounded by
Hanson Professional Services Inc.
August 6, 2014

Depths shown are below LWRP
Depths shown in red are 9' below LWRP
Depths shown in green are 12' below LWRP
Depths shown in blue are 14' below LWRP

LWRP
DEPTHS AND CONTOURS SHOWN ARE BASED
ON DEPTH BELOW LWRP

PRELIMINARY

JTEAU ISLAND

TELEPHONE CABLES

13

AUGUST 6, 2014
INTERPOLATED WATER SURFACE ELEVATIONS

MILE	LWRP	WS 08:00	WS 09:00	LWRP DIFF	LWRP DIFF
185.3	LD27 (POOL)	396.00	400.90	4.9	4.9



GAGE RECORD		ST. LOUIS	
WATER SURFACE	L&D 27 (POOL)	MEL. PRICE (L)	379.94
ZERO (A.C.V.D)	350.00	395.48	179.6
MILE	185.3	200.5	376.4
L. W. R. P.	396.00	396.30	
	06 AUGUST 2014	400.9	

ELEVATIONS ARE REFERRED TO LOCAL - CONTIGUOUS ARE BELOW 1956-57 LOW WATER REFERENCE PLANE (LWRP) (L&D 27)

Survey Date: August 06, 2014	Submitted: Chief, Engr. Data Mgmt. Sect.
Drawn by: TCU	Reviewed by:
Checked by: Hanson	APPROVED: Chief, Geospatial Branch

U.S. ARMY ENGINEER DIVISION CORPS OF ENGINEERS ST. LOUIS, MISSOURI	UPPER MISSISSIPPI RIVER BASIN MISSISSIPPI RIVER
--	--

240 METERS 120 0 400 800 FEET	CHANNEL SURVEY MILE: 200.5-145.8
---	-------------------------------------

PLATE NUMBER

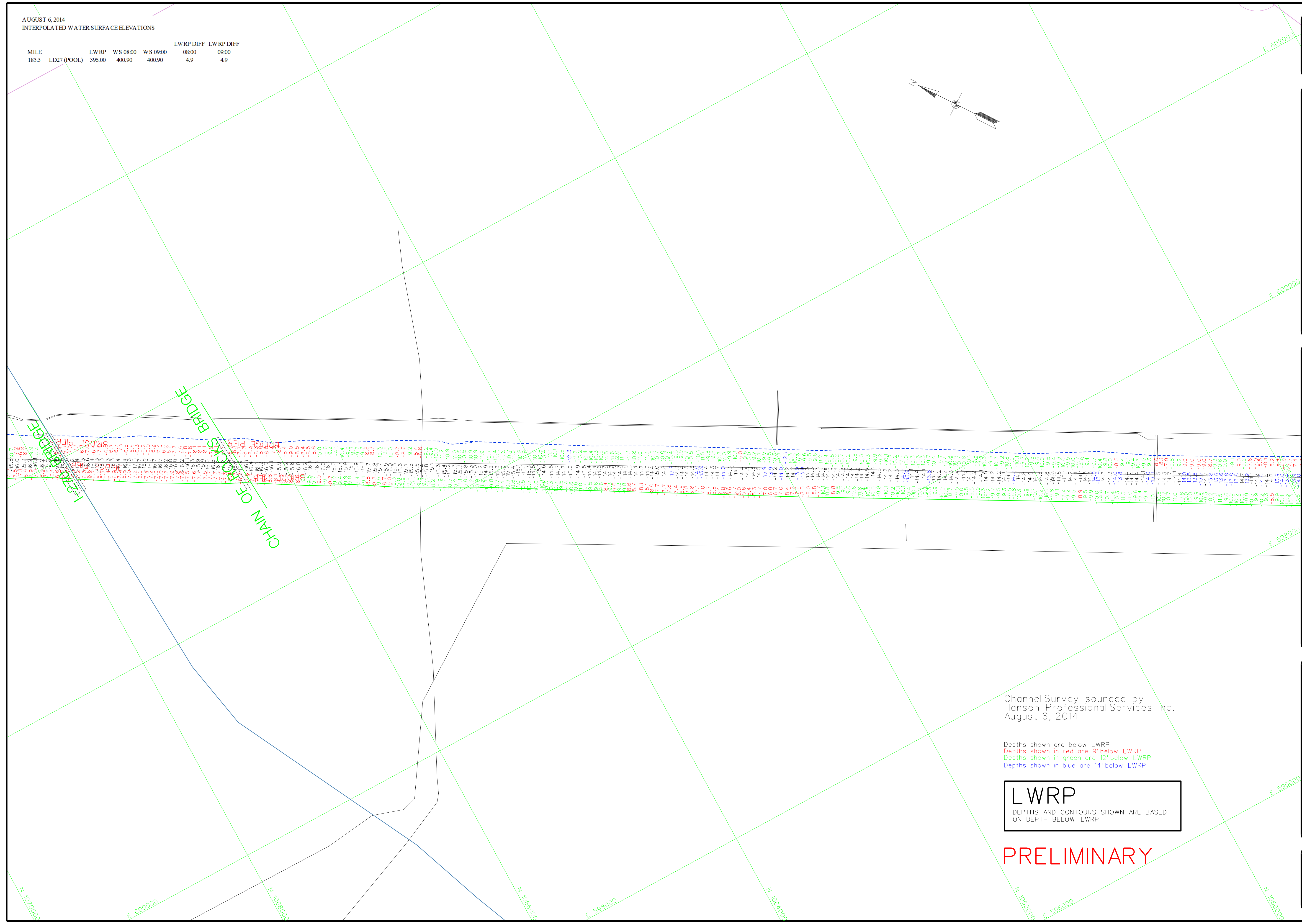
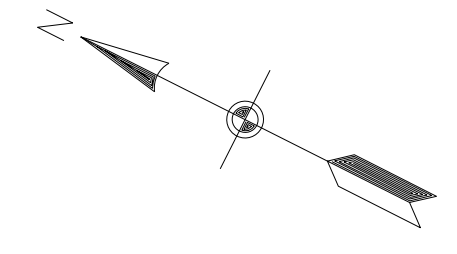

Channel Survey sounded by
Hanson Professional Services Inc.
August 6, 2014

Depths shown are below LWRP
Depths shown in red are 9' below LWRP
Depths shown in green are 12' below LWRP
Depths shown in blue are 14' below LWRP

LWRP
DEPTHS AND CONTOURS SHOWN ARE BASED
ON DEPTH BELOW LWRP

PRELIMINARY

AUGUST 6, 2014
INTERPOLATED WATER SURFACE ELEVATIONS

MILE	LWRP	WS 08:00	WS 09:00	LWRP DIFF	LWRP DIFF
185.3	LD27 (POOL)	396.00	400.90	08:00	09:00
				4.9	4.9



GAGE RECORD		ST. LOUIS	
WATER SURFACE	L&D 27 (POOL)	MEPRICE (L)	379.94
ZERO (I.C.V.D)	350.00	395.48	
MILE	185.3	200.5	179.6
L. W. R. P.	396.00	396.30	376.4
	06 AUGUST 2014	400.9	

Survey Date: August 06, 2014
SUBMITTED:
Chief, Engr. Data Mgmt. Sect.
File name: 194_188664_Lwrp.dgn
Plot date: August 08, 2014
Plot scale: 1"=400'

Surveyed by:	HANSON
Drawn by:	RCA
Reviewed by:	
APPROVED:	Chief, Geospatial Branch

U.S. ARMY ENGINEER DIVISION
CORPS OF ENGINEERS
ST. LOUIS, MISSOURI
UPPER MISSISSIPPI RIVER BASIN
MISSISSIPPI RIVER

240 METERS
800 FEET
400 FEET
0
THE INFORMATION DEPICTED ON THIS MAP REPRESENTS THE RESULTS OF A CHANNEL SURVEY CONDUCTED UNDER THE GENERAL CONDITIONS LISTED AT THE END OF THIS SHEET.

CHANNEL SURVEY
MILE: 200.5-145.8

PLATE NUMBER

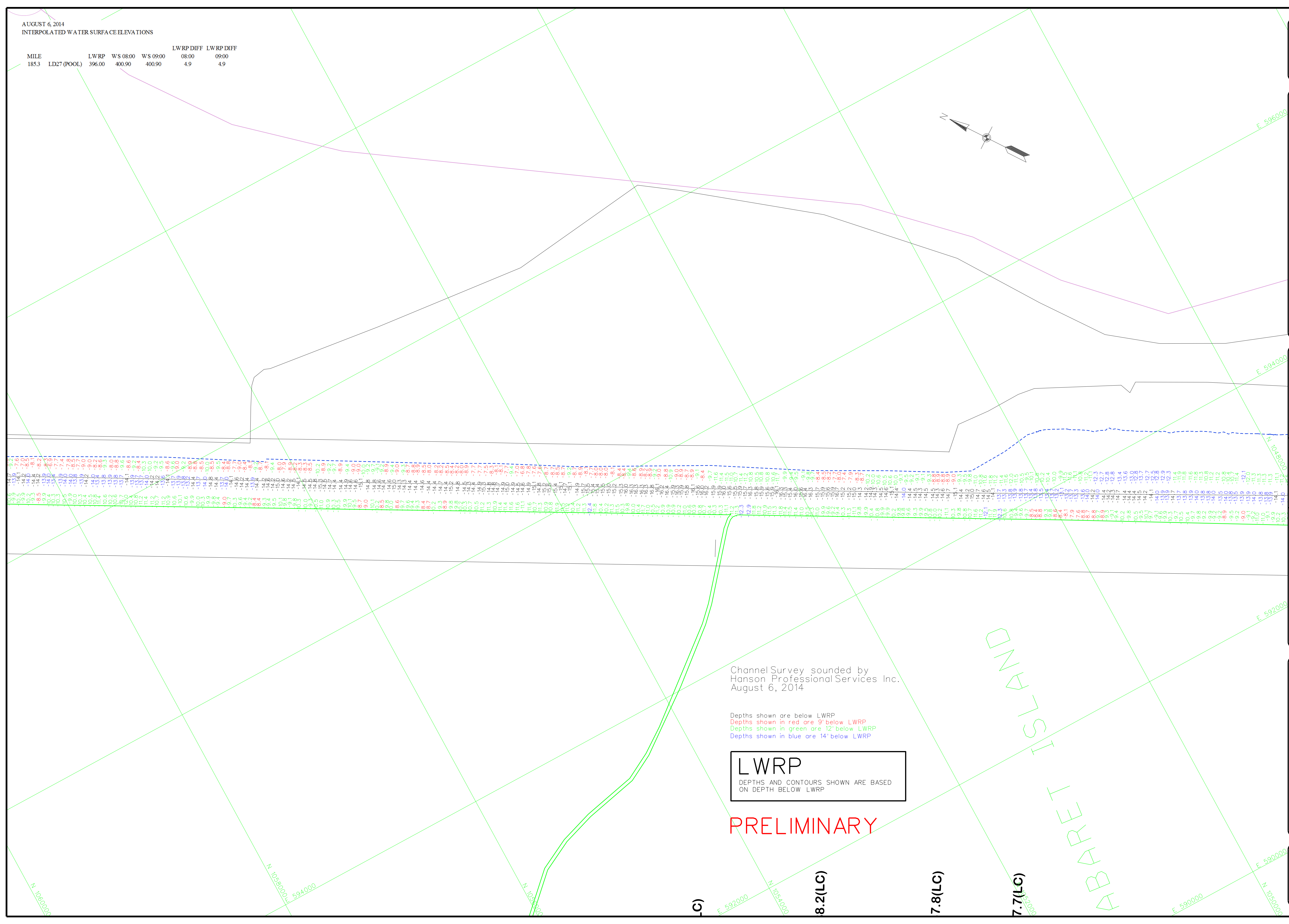

Channel Survey sounded by
Hanson Professional Services Inc.
August 6, 2014

Depths shown are below LWRP
Depths shown in red are 9' below LWRP
Depths shown in green are 12' below LWRP
Depths shown in blue are 14' below LWRP

LWRP
DEPTHS AND CONTOURS SHOWN ARE BASED
ON DEPTH BELOW LWRP

PRELIMINARY

8.2(LC)
7.8(LC)
7.7(LC)

