

GAGE RECORD	
MOSER	L&D 25 (U)
400.0	407.0
260.3	245
434.0	423.7
435.0 (08600)	431.0(8600)
435.0 (0600)	433.0(600)

Survey Date: August 28, 2020	Submitted:
Supervised by: PRAIRIE ENGINEERS	Chief, Engr. Data Mngt. Sect.
Drawn by: JLM	File: 25415-253.5.mxd
Reviewed by:	Plot Date: 8/31/2020
APPROVED:	Plot Scale: 1"=200'
U.S. ARMY ENGINEER DIVISION CORPS OF ENGINEERS ST. LOUIS, MISSOURI	
UPPER MISSISSIPPI RIVER BASIN MISSISSIPPI RIVER	

60 METERS	200 FEET
0	0
200	400
THE INFORMATION DEPICTED ON THIS MAP REPRESENTS THE RESULTS OF A SURVEY CONDUCTED UNDER THE GENERAL CONDITIONS EXISTING AT THAT TIME.	
PRE DREDGE SURVEY MILE# 254.5-253.5	

PLATE NUMBER	01
--------------	----

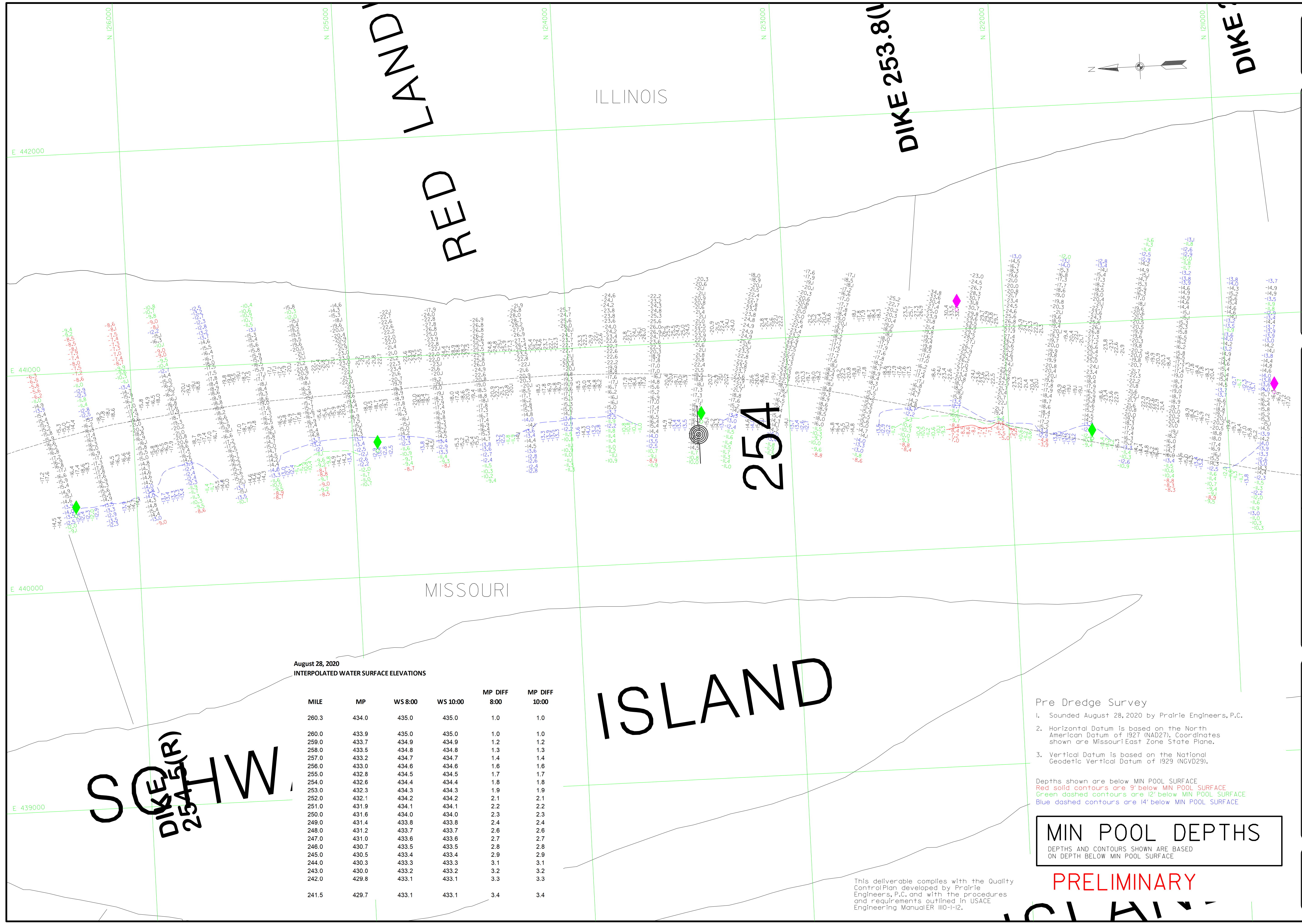

August 28, 2020
INTERPOLATED WATER SURFACE ELEVATIONS

MILE	MP	WS 8:00	WS 10:00	MP DIFF 8:00	MP DIFF 10:00
260.3	434.0	435.0	435.0	1.0	1.0
260.0	433.9	435.0	435.0	1.0	1.0
259.0	433.7	434.9	434.9	1.2	1.2
258.0	433.5	434.8	434.8	1.3	1.3
257.0	433.2	434.7	434.7	1.4	1.4
256.0	433.0	434.6	434.6	1.6	1.6
255.0	432.8	434.5	434.5	1.7	1.7
254.0	432.6	434.4	434.4	1.8	1.8
253.0	432.3	434.3	434.3	1.9	1.9
252.0	432.1	434.2	434.2	2.1	2.1
251.0	431.9	434.1	434.1	2.2	2.2
250.0	431.6	434.0	434.0	2.3	2.3
249.0	431.4	433.8	433.8	2.4	2.4
248.0	431.2	433.7	433.7	2.6	2.6
247.0	431.0	433.6	433.6	2.7	2.7
246.0	430.7	433.5	433.5	2.8	2.8
245.0	430.5	433.4	433.4	2.9	2.9
244.0	430.3	433.3	433.3	3.1	3.1
243.0	430.0	433.2	433.2	3.2	3.2
242.0	429.8	433.1	433.1	3.3	3.3
241.5	429.7	433.1	433.1	3.4	3.4

- Pre Dredge Survey
- Sounded August 28, 2020 by Prairie Engineers, P.C.
 - Horizontal Datum is based on the North American Datum of 1927 (NAD27). Coordinates shown are Missouri East Zone State Plane.
 - Vertical Datum is based on the National Geodetic Vertical Datum of 1929 (NGVD29).

Depths shown are below MIN POOL SURFACE
 Red solid contours are 9' below MIN POOL SURFACE
 Green dashed contours are 12' below MIN POOL SURFACE
 Blue dashed contours are 14' below MIN POOL SURFACE

MIN POOL DEPTHS
 DEPTHS AND CONTOURS SHOWN ARE BASED ON DEPTH BELOW MIN POOL SURFACE

PRELIMINARY

This deliverable complies with the Quality Control Plan developed by Prairie Engineers, P.C. and with the procedures and requirements outlined in USACE Engineering Manual ER 110-1-12.