

August 20, 2020
INTERPOLATED WATER SURFACE ELEVATIONS

MILE	MP	WS 9:00	WS 10:00	MP DIFF 9:00	MP DIFF 10:00
260.3	434.0	435.1	435.1	1.1	1.1
260.0	433.9	435.0	435.0	1.1	1.1
259.0	433.7	434.9	434.9	1.2	1.2
258.0	433.5	434.8	434.8	1.3	1.3
257.0	433.2	434.7	434.7	1.4	1.4
256.0	433.0	434.6	434.6	1.5	1.5
255.0	432.8	434.4	434.4	1.6	1.6
254.0	432.6	434.3	434.3	1.7	1.7
253.0	432.3	434.2	434.2	1.9	1.9
252.0	432.1	434.1	434.1	2.0	2.0
251.0	431.9	433.9	433.9	2.1	2.1
250.0	431.6	433.8	433.8	2.2	2.2
249.0	431.4	433.7	433.7	2.3	2.3
248.0	431.2	433.6	433.6	2.4	2.4
247.0	431.0	433.4	433.4	2.5	2.5
246.0	430.7	433.3	433.3	2.6	2.6
245.0	430.5	433.2	433.2	2.7	2.7
244.0	430.3	433.1	433.1	2.8	2.8
243.0	430.0	433.0	433.0	2.9	2.9
242.0	429.8	432.8	432.8	3.0	3.0
241.5	429.7	432.8	432.8	3.1	3.1

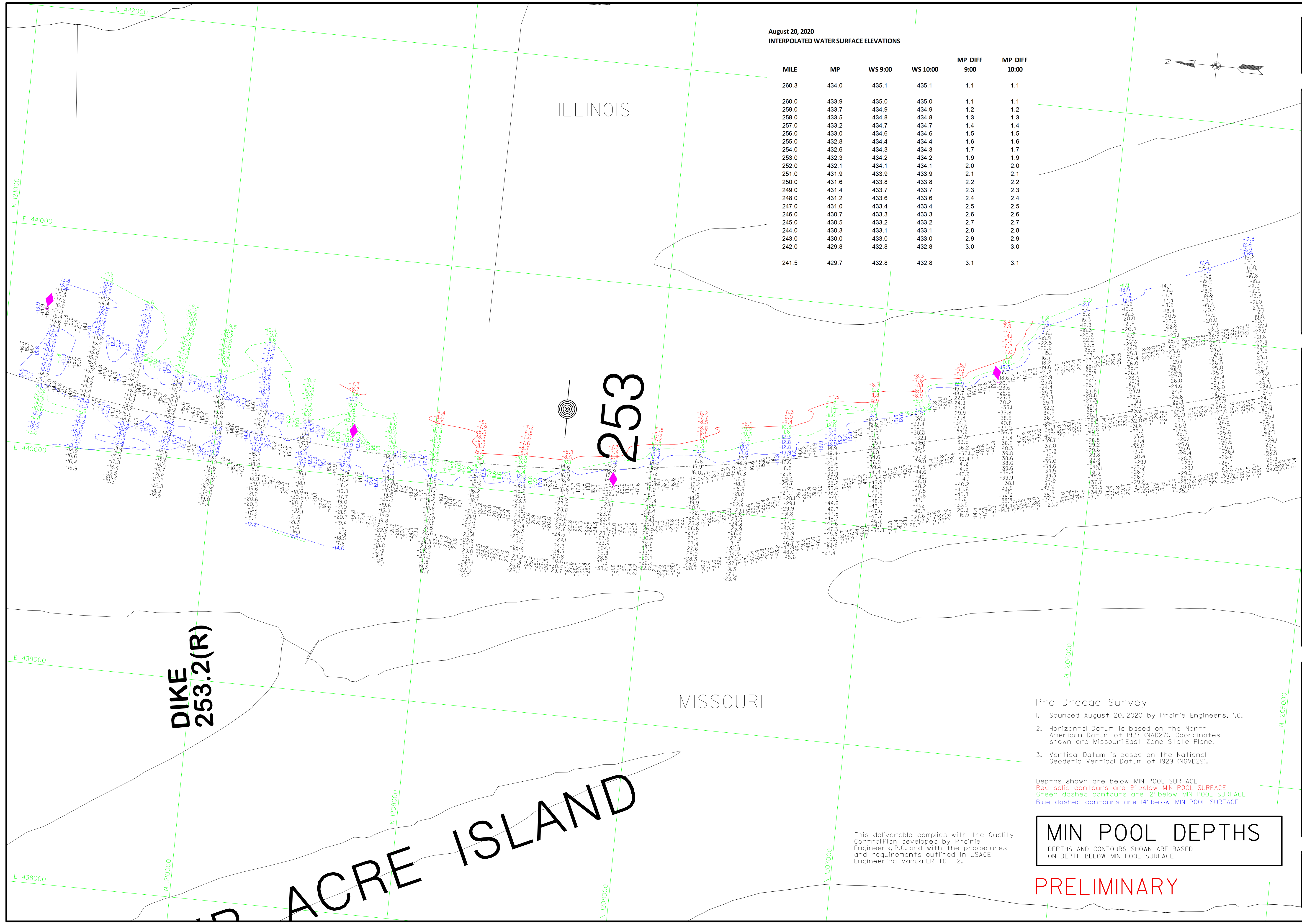
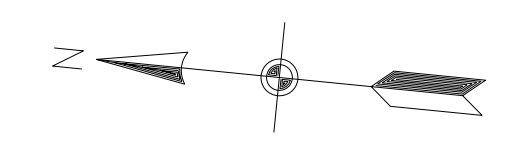

GAGE RECORD

WATER SURFACE	MOSEER	L&D 25 (U)
400.0	400.0	407.0
260.3	260.3	241.5
434.0	434.0	429.7
435.1	435.1	432.8
435.1	435.1	432.8

Survey Date: August 20, 2020

Submitted by:	Chief, Engr. Data Mgmt. Sect.
File: 2532020.mxd	Plot Date: 8/21/2020
Plot Scale: 1"=200'	Plot Scale: 1"=200'

U.S. ARMY ENGINEER DIVISION
CORPS OF ENGINEERS
ST. LOUIS, MISSOURI

UPPER MISSISSIPPI RIVER BASIN
MISSISSIPPI RIVER

PRE DREDGE SURVEY
MILE# 253.15-252.15

PLATE NUMBER
01

- Pre Dredge Survey
- Sounded August 20, 2020 by Prairie Engineers, P.C.
 - Horizontal Datum is based on the North American Datum of 1927 (NAD27). Coordinates shown are Missouri East Zone State Plane.
 - Vertical Datum is based on the National Geodetic Vertical Datum of 1929 (NGVD29).

Depths shown are below MIN POOL SURFACE
 Red solid contours are 9' below MIN POOL SURFACE
 Green dashed contours are 12' below MIN POOL SURFACE
 Blue dashed contours are 14' below MIN POOL SURFACE

MIN POOL DEPTHS
 DEPTHS AND CONTOURS SHOWN ARE BASED ON DEPTH BELOW MIN POOL SURFACE

PRELIMINARY

This deliverable complies with the Quality Control Plan developed by Prairie Engineers, P.C. and with the procedures and requirements outlined in USACE Engineering Manual ER 110-1-12.