

MIDDLETON ISLAND

ILLINOIS

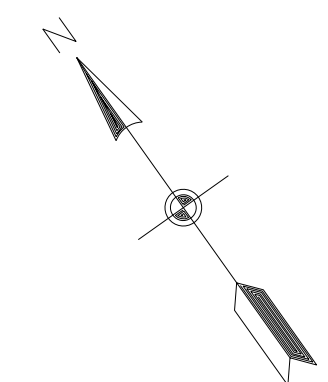

July 22, 2020
INTERPOLATED WATER SURFACE ELEVATIONS

MILE	MP	WS 10:00	WS 13:30	MP DIFF 10:00	MP DIFF 13:30
275.0	446.0	447.3	447.3	1.2	1.3
274.0	445.7	447.0	447.1	1.3	1.4
273.5	445.5	446.9	447.0	1.4	1.4

DIKE 275.3(L)

275

Pre Dredge Survey

- Sounded July 22, 2020 by Prairie Engineers, P.C.
- Horizontal Datum is based on the North American Datum of 1927 (NAD27). Coordinates shown are Missouri East Zone State Plane.
- Vertical Datum is based on the National Geodetic Vertical Datum of 1929 (NGVD29).

Depths shown are below MIN POOL SURFACE
 Red solid contours are 9' below MIN POOL SURFACE
 Green dashed contours are 12' below MIN POOL SURFACE
 Blue dashed contours are 14' below MIN POOL SURFACE

MIN POOL DEPTHS

DEPTHS AND CONTOURS SHOWN ARE BASED ON DEPTH BELOW MIN POOL SURFACE

PRELIMINARY

This deliverable complies with the Quality Control Plan developed by Prairie Engineers, P.C. and with the procedures and requirements outlined in USACE Engineering Manual ER 1110-1-12.

GAGE RECORD	
LOUISIANA	L&D 24 (U)
437.3	421.8
282.9	271.5
448.8	443.5
449.2 (10:00)	445.9 (10:00)
449.3 (13:30)	447.0 (13:30)

U.S. ARMY ENGINEER DIVISION CORPS OF ENGINEERS ST. LOUIS, MISSOURI	
Drawn by: JAK	Checked by: [Signature]
Reviewed by: [Signature]	APPROVED: [Signature]
Submitted: [Date]	Chief, Geospatial Branch
Chief, Engr. Data Mgmt. Sect.	
Plot date: 7/23/2020	
Plot scale: 1"=200'	
UPPER MISSISSIPPI RIVER BASIN	MISSISSIPPI RIVER

PRE DREDGE SURVEY MILE: 275.0-273.5	
0	200 METERS
0	400 FEET

PLATE NUMBER
01

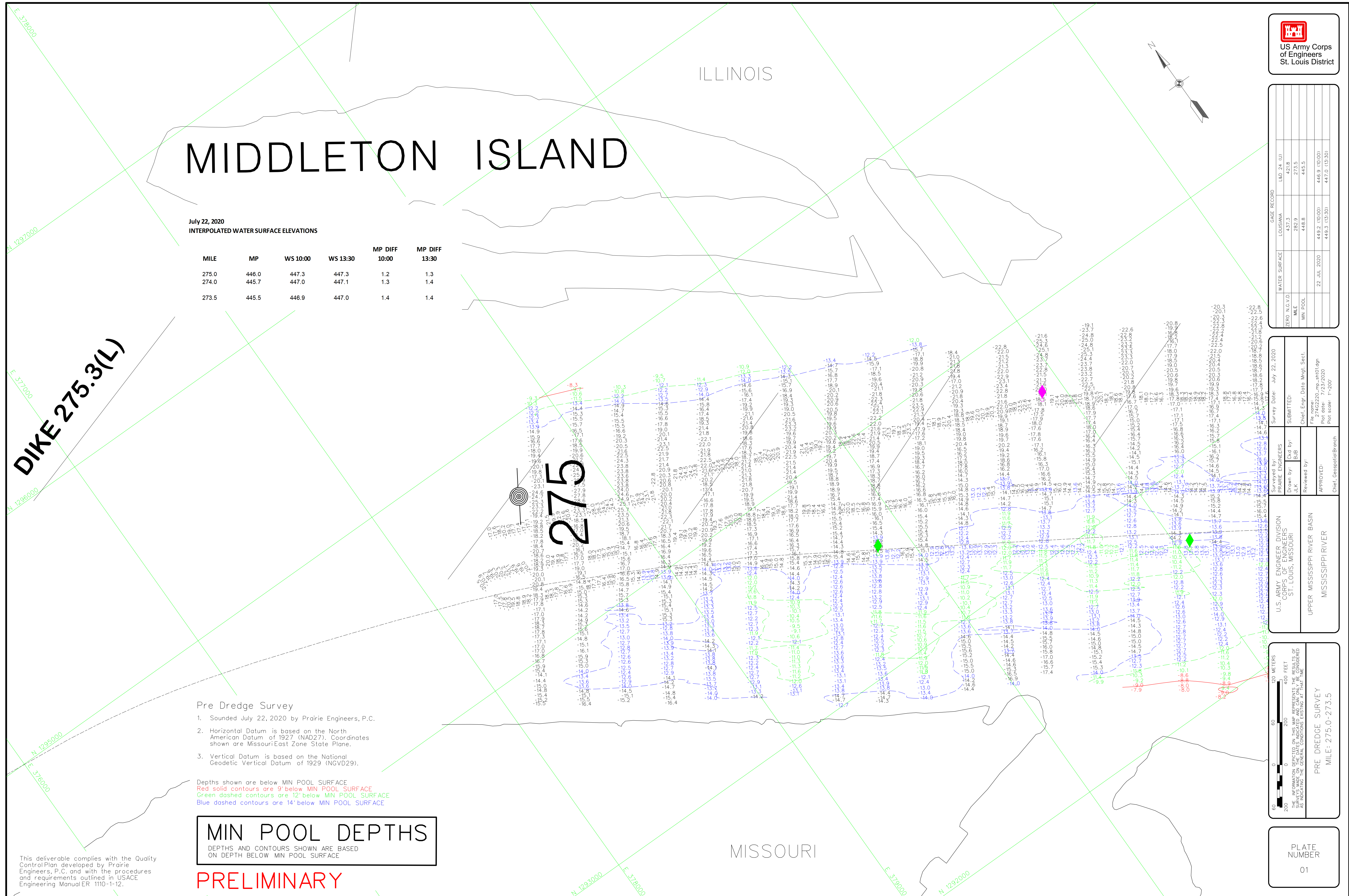

July 22, 2020
INTERPOLATED WATER SURFACE ELEVATIONS

MILE	MP	WS 10:00	WS 13:30	MP DIFF 10:00	MP DIFF 13:30
275.0	446.0	447.3	447.3	1.2	1.3
274.0	445.7	447.0	447.1	1.3	1.4
273.5	445.5	446.9	447.0	1.4	1.4

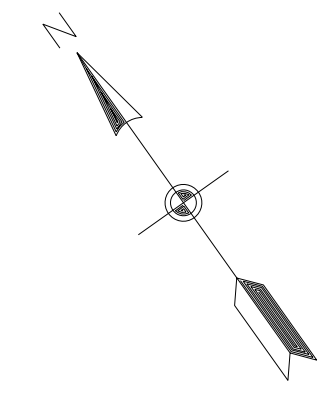

GAGE RECORD	
WATER SURFACE	LOUISIANA
ZERO N.G.V.D.	437.3
MILE	282.9
MIN POOL	448.8
	22 JUL 2020
	449.2 (10:00)
	449.5 (13:30)
	421.8
	271.5
	445.5
	445.9 (10:00)
	447.0 (13:30)

Survey Date: July 22, 2020	
Submitted by:	Chief, Engr. Data Mgmt. Sect.
Drawn by:	JLK
Reviewed by:	
Approved:	Chief, Geospatial Branch
File:	2742220.ms_rh02.dgn
Plot date:	7/23/2020
Plot scale:	1"=200'

U.S. ARMY ENGINEER DIVISION CORPS OF MISSOURI ST. LOUIS, MISSOURI	
Upper Mississippi River Basin	Mississippi River

PRE DREDGE SURVEY	
MILE:	275.0-273.5

PLATE NUMBER	
02	

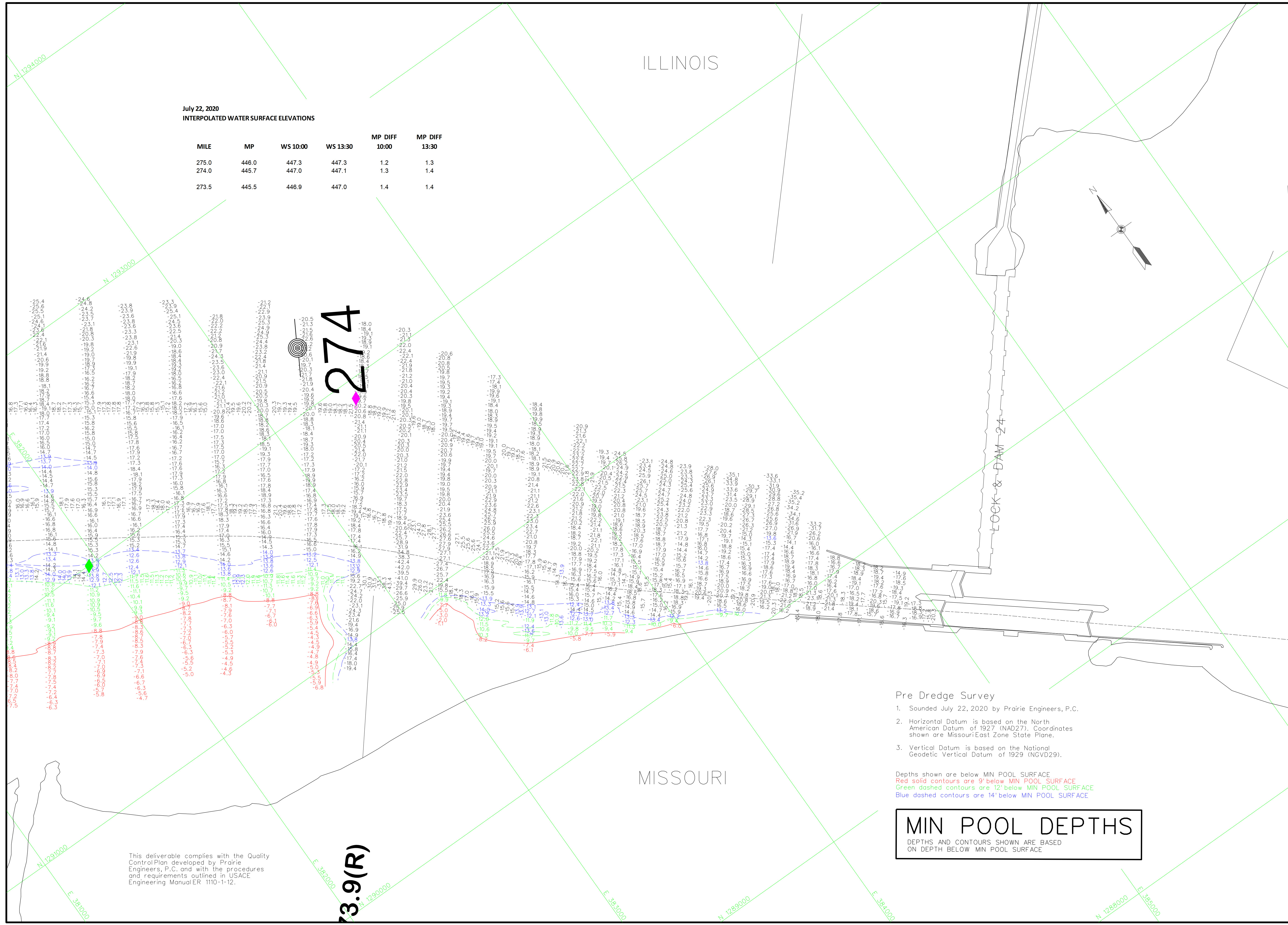

- Pre Dredge Survey
- Sounded July 22, 2020 by Prairie Engineers, P.C.
 - Horizontal Datum is based on the North American Datum of 1927 (NAD27). Coordinates shown are Missouri East Zone State Plane.
 - Vertical Datum is based on the National Geodetic Vertical Datum of 1929 (NGVD29).

Depths shown are below MIN POOL SURFACE
 Red solid contours are 9' below MIN POOL SURFACE
 Green dashed contours are 12' below MIN POOL SURFACE
 Blue dashed contours are 14' below MIN POOL SURFACE

MIN POOL DEPTHS
 DEPTHS AND CONTOURS SHOWN ARE BASED ON DEPTH BELOW MIN POOL SURFACE

This deliverable complies with the Quality Control Plan developed by Prairie Engineers, P.C. and with the procedures and requirements outlined in USACE Engineering Manual ER 1110-1-12.

