

GAGE RECORD	
DIXON LIND	410.6
LSD 25 (LL)	407.0
WATER SURFACE	241.3
MIN POOL	418.5
430.3 (10/00)	425.3 (10/00)
430.3 (12/00)	425.3 (12/00)

Survey Date:	July 7, 2020
Submitted:	Chief, Engr. Data Mgmt. Sect.
Drawn by:	2400720_mjg
Reviewed by:	7/8/2020
Approved:	Chief, Geospatial Branch

U.S. ARMY ENGINEER DIVISION  
CORPS OF ENGINEERS  
ST. LOUIS, MISSOURI

UPPER MISSISSIPPI RIVER BASIN  
MISSISSIPPI RIVER

120 METERS  
200 0 200 400 FEET

THE INFORMATION DEPICTED ON THIS MAP REPRESENTS THE RESULTS OF A SURVEY CONDUCTED UNDER THE GENERAL CONDITIONS LISTED ON THE REVERSE SIDE OF THIS DRAWING.

PRE DREDGE SURVEY  
MILE: 241.5-240.5

PLATE NUMBER  
01

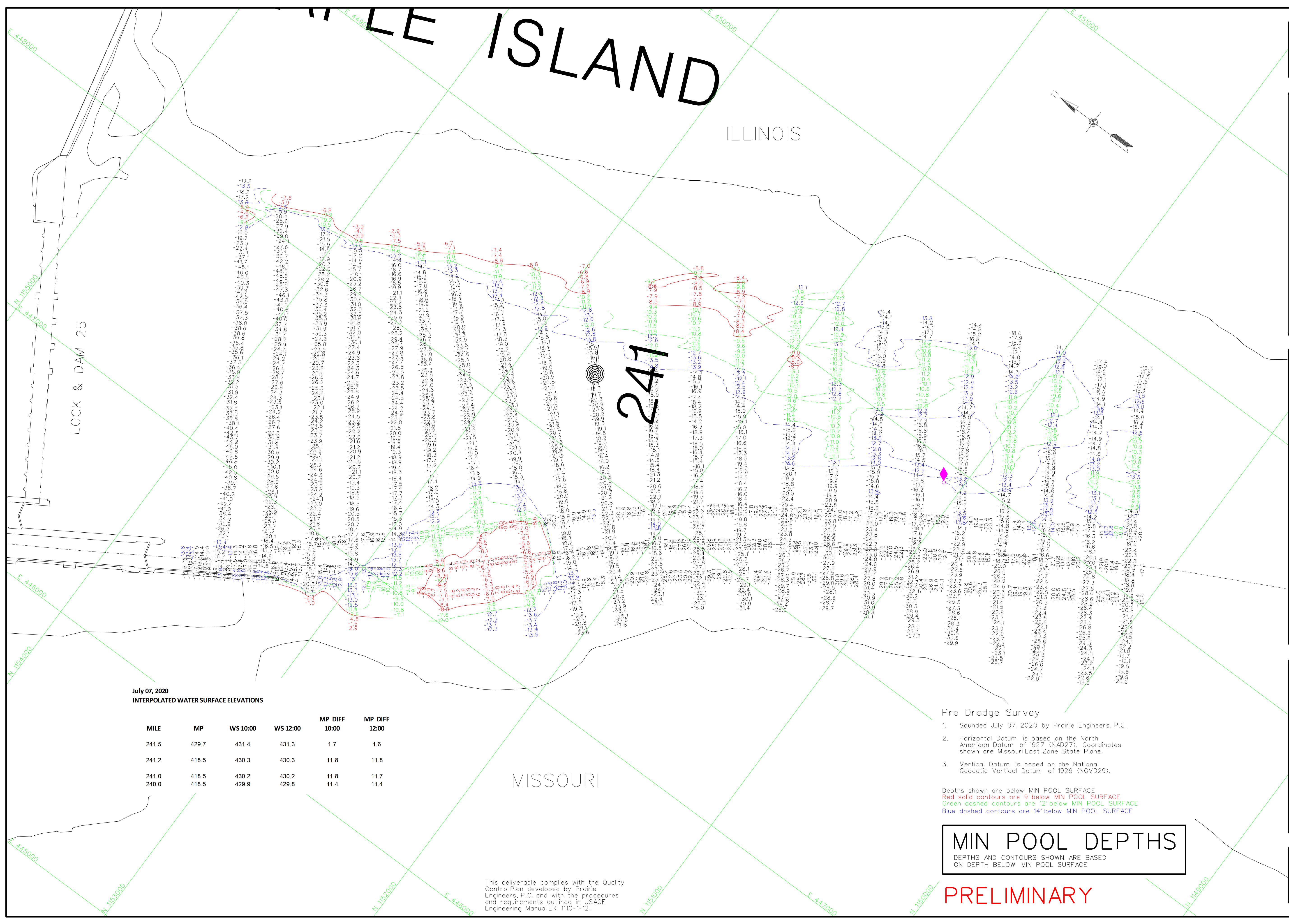

July 07, 2020  
INTERPOLATED WATER SURFACE ELEVATIONS

MILE	MP	WS 10:00	WS 12:00	MP DIFF 10:00	MP DIFF 12:00
241.5	429.7	431.4	431.3	1.7	1.6
241.2	418.5	430.3	430.3	11.8	11.8
241.0	418.5	430.2	430.2	11.8	11.7
240.0	418.5	429.9	429.8	11.4	11.4

- Pre Dredge Survey
- Sounded July 07, 2020 by Prairie Engineers, P.C.
  - Horizontal Datum is based on the North American Datum of 1927 (NAD27). Coordinates shown are Missouri East Zone State Plane.
  - Vertical Datum is based on the National Geodetic Vertical Datum of 1929 (NGVD29).

Depths shown are below MIN POOL SURFACE  
Red solid contours are 9' below MIN POOL SURFACE  
Green dashed contours are 12' below MIN POOL SURFACE  
Blue dashed contours are 14' below MIN POOL SURFACE

**MIN POOL DEPTHS**  
DEPTHS AND CONTOURS SHOWN ARE BASED ON DEPTH BELOW MIN POOL SURFACE

**PRELIMINARY**

This deliverable complies with the Quality Control Plan developed by Prairie Engineers, P.C. and with the procedures and requirements outlined in USACE Engineering Manual ER 1110-1-12.