

SEPTEMBER 11, 2020  
INTERPOLATED WATER SURFACE ELEVATIONS

MILE	WSE @ 9:00	WSE @ 14:00	LWRP 2014	LWRP DIF @ 9:00	LWRP DIF @ 14:00
182	386.36	386.39	376.38	9.98	10.01
183	386.45	386.42	376.38	10.07	10.04
183.3	386.47	386.43	376.38	10.09	10.05
184	386.47	386.43	376.38	10.09	10.05
185.1	386.47	386.43	376.38	10.09	10.05

WSE CALCULATIONS COMPLETED BY TRANSFERRING  
L&D 27 LOWER GAGE READING TO MILE 183.3

1. SOUNDED SEPTEMBER 11, 2020 BY BOWEN ENGINEERING AND SURVEYING.
  2. HORIZONTAL DATUM IS BASED ON THE NORTH AMERICAN DATUM OF 1983 (NAD 83). COORDINATES SHOWN ARE MISSOURI EAST ZONE STATE PLANE.
  3. VERTICAL DATUM IS BASED ON THE NORTH AMERICAN VERTICAL DATUM OF 1988 (NAVD 88).
- Depths shown are below LWRP2014 SURFACE  
 Red solid contours are 9' below LWRP2014 SURFACE  
 Green dashed contours are 12' below LWRP2014 SURFACE  
 Blue dashed contours are 14' below LWRP2014 SURFACE



US Army Corps of Engineers  
St. Louis District

CHAM. OF ROCKS, MO	L&D 27 LOWER	ST. LOUIS, MO	JEFFERSON BARRACKS
ZERO N.A.V.D.	33.58	349.49	379.58
MILE	180.4 (OLD CHANNEL)	185.1	180.0
LWRP 2014	X	376.38	376.38
11 SEP 2020	X	35.989900 35.94143001	6.629000 6.7514000
			X

U.S. ARMY ENGINEER DIVISION CORPS OF ENGINEERS ST. LOUIS, MISSOURI	UPPER MISSISSIPPI RIVER BASIN MISSISSIPPI RIVER
Surveyed by: BOWEN ENGINEERING	Survey Date: SEPTEMBER 11, 2020
Drawn by: X	Checked by: X
Submitted: X	Reviewed by: X
Approved: X	Approved: X
Plot date: #888101021001	Plot name: #888101021001.dwg

240 METERS  
120  
0  
400  
800 FEET

PRE DREDGE SURVEY  
RIVER MILES 186.0 - 182.3

THE INFORMATION DEPICTED ON THIS MAP REPRESENTS THE RESULTS OF A SURVEY CONDUCTED IN ACCORDANCE WITH THE GENERAL CONDITIONS OF CONTRACT FOR THE PROJECT.

PLATE NUMBER  
XX  
SHEET 1 OF 2

GAGE RECORD	ST. LOUIS, MO	JEFFERSON BARRACKS
DATE OF RECORD	180 27 LOWER	179 58
CHAM. OF ROCKS, WD	133.58	149.49
MILE	180.4 (OLD CHANNEL)	185.1
LWRP 2014	X	176.38
11 SEP 2020	X	35.989(20) 35.911(20) 6.629(20) 6.751(20)
		X

U.S. ARMY ENGINEER DIVISION	ST. LOUIS, MISSOURI	UPPER MISSISSIPPI RIVER BASIN	MISSISSIPPI RIVER
Surveyed by:	BOWEN ENGINEERING	Survey Date:	SEPTEMBER 11, 2020
Drawn by:	X	Created by:	X
Submitted:	X	Reviewed by:	X
Approved:	X	Approved:	X
Plot date:	08/26/2020 10:58:38	File name:	186.0-182.3.dwg

240 METERS  
120 0 120  
800 FEET  
400 0 400

THE INFORMATION DEPICTED ON THIS MAP REPRESENTS THE RESULTS OF A SURVEY CONDUCTED UNDER THE GENERAL CONDITIONS LISTED ON THE REVERSE SIDE OF THIS DRAWING.

PRE DREDGE SURVEY  
RIVER MILES 186.0 - 182.3

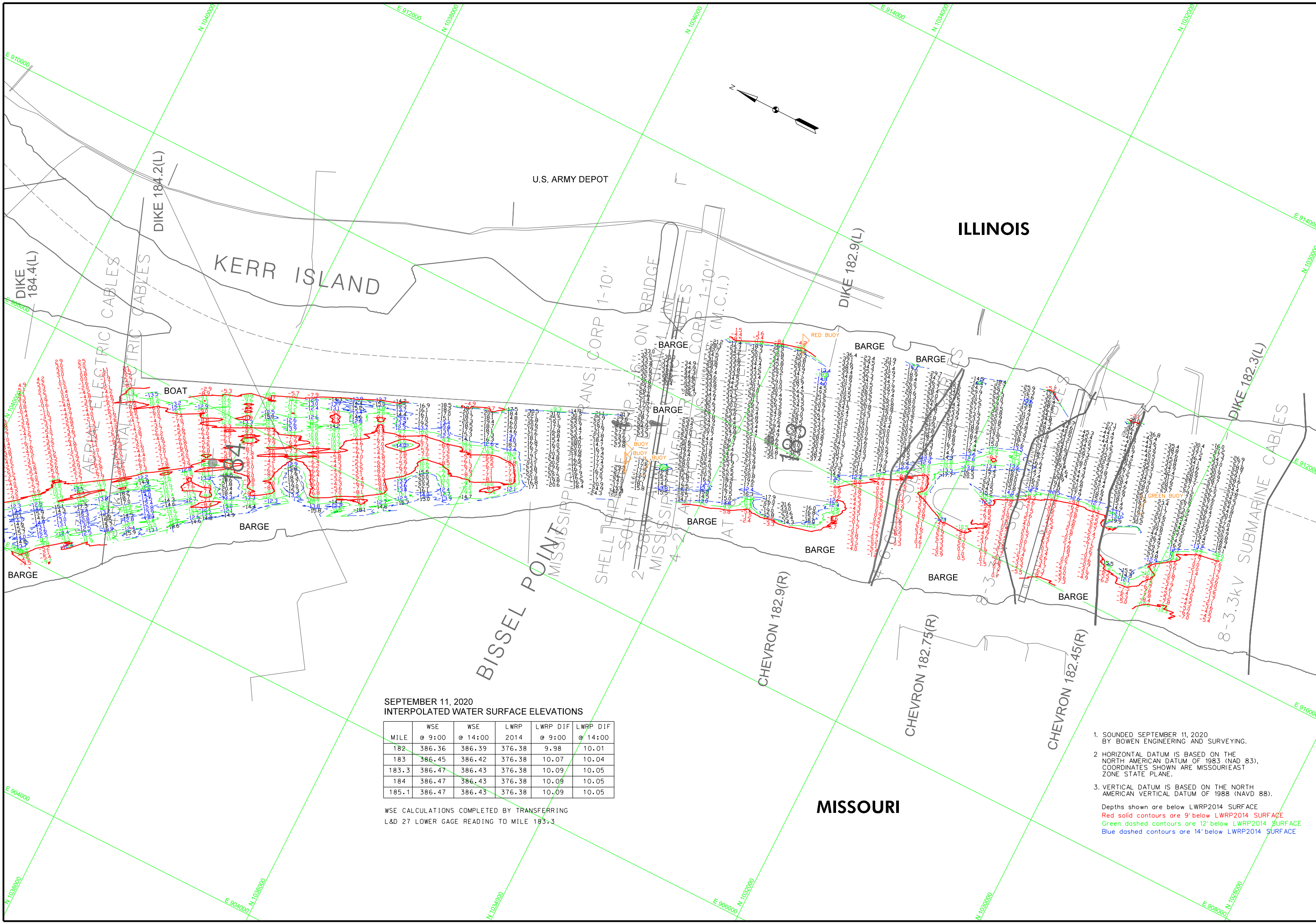

SEPTEMBER 11, 2020  
INTERPOLATED WATER SURFACE ELEVATIONS

MILE	WSE @ 9:00	WSE @ 14:00	LWRP 2014	LWRP DIF @ 9:00	LWRP DIF @ 14:00
182	386.36	386.39	376.38	9.98	10.01
183	386.45	386.42	376.38	10.07	10.04
183.3	386.47	386.43	376.38	10.09	10.05
184	386.47	386.43	376.38	10.09	10.05
185.1	386.47	386.43	376.38	10.09	10.05

WSE CALCULATIONS COMPLETED BY TRANSFERRING  
L&D 27 LOWER GAGE READING TO MILE 183.3

- SOUNDED SEPTEMBER 11, 2020 BY BOWEN ENGINEERING AND SURVEYING.
  - HORIZONTAL DATUM IS BASED ON THE NORTH AMERICAN DATUM OF 1983 (NAD 83). COORDINATES SHOWN ARE MISSOURI EAST ZONE STATE PLANE.
  - VERTICAL DATUM IS BASED ON THE NORTH AMERICAN VERTICAL DATUM OF 1988 (NAVD 88).
- Depths shown are below LWRP2014 SURFACE  
 Red solid contours are 9' below LWRP2014 SURFACE  
 Green dashed contours are 12' below LWRP2014 SURFACE  
 Blue dashed contours are 14' below LWRP2014 SURFACE