

**JULY 23, 2020  
INTERPOLATED WATER SURFACE ELEVATIONS**

MILE	WSE @ 9:00	WSE @ 15:00	LWRP 2014	LWRP DIF @ 9:00	LWRP DIF @ 15:00
183.3	393.98	394.26	376.38	17.60	17.88
184	393.98	394.26	376.38	17.60	17.88
185.1	393.98	394.26	376.38	17.60	17.88

WSE CALCULATIONS COMPLETED BY TRANSFERRING L&D 27 LOWER GAGE READING TO MILE 183.3

1. SOUNDED JULY 23, 2020 BY BOWEN ENGINEERING AND SURVEYING.
2. HORIZONTAL DATUM IS BASED ON THE NORTH AMERICAN DATUM OF 1983 (NAD 83). COORDINATES SHOWN ARE MISSOURI EAST ZONE STATE PLANE.  
Vertical Datum is based on the North American Vertical Datum of 1988 (NAVD 88).  
Depths shown are below LWRP2014 SURFACE.  
Red solid contours are 9' below LWRP2014 SURFACE  
Green dashed contours are 12' below LWRP2014 SURFACE  
Blue dashed contours are 14' below LWRP2014 SURFACE
3. VERTICAL DATUM IS BASED ON THE NORTH AMERICAN VERTICAL DATUM OF 1988 (NAVD 88).



GAGE RECORD	ST. LOUIS, MO	JEFFERSON BARRACKS BRIDGE'S LANDING, MO
180 27 LOWER	379.58	357.38
ZERO N.A.V.D.	349.19	377.34
MILE	185.1	188.70
LWRP 2014	376.38	369.63
23 JUL 2020	44.4999001 44.7115301	40.0099001 40.2127301
UNAVAILABLE		

U.S. ARMY ENGINEER DIVISION CORPS OF ENGINEERS ST. LOUIS, MISSOURI UPPER MISSISSIPPI RIVER BASIN MISSISSIPPI RIVER	Survey Date: JULY 23, 2020 Drawn by: X Reviewed by: X Submitted: X Approved: X	File name: Plot date:
	Surveyed by: BOWEN ENGINEERING Drawn by: X Reviewed by: X Submitted: X Approved: X	File name: Plot date:
	Survey Date: JULY 23, 2020 Drawn by: X Reviewed by: X Submitted: X Approved: X	File name: Plot date:

60 METERS  
 200 FEET  
 400 FEET  
 THE INFORMATION DEPICTED ON THIS MAP REPRESENTS THE RESULTS OF SURVEYING CONDUCTED IN ACCORDANCE WITH THE GENERAL CONDITIONS AND SPECIFICATIONS OF THE PRE DREDGE SURVEY  
 RIVER MILES 185.5 - 183.5

JULY 23, 2020  
INTERPOLATED WATER SURFACE ELEVATIONS

MILE	WSE @ 9:00	WSE @ 15:00	LWRP 2014	LWRP DIF @ 9:00	LWRP DIF @ 15:00
183.3	393.98	394.26	376.38	17.60	17.88
184	393.98	394.26	376.38	17.60	17.88
185.1	393.98	394.26	376.38	17.60	17.88

WSE CALCULATIONS COMPLETED BY TRANSFERRING  
L&D 27 LOWER GAGE READING TO MILE 183.3

1. SOUNDED JULY 23, 2020 BY BOWEN ENGINEERING AND SURVEYING.
2. HORIZONTAL DATUM IS BASED ON THE NORTH AMERICAN DATUM OF 1983 (NAD 83), COORDINATES SHOWN ARE MISSOURIEAST ZONE STATE PLANE.  
VERTICAL DATUM IS BASED ON THE NORTH AMERICAN VERTICAL DATUM OF 1988 (NAVD 88).  
Depths shown are below LWRP2014 SURFACE  
Red solid contours are 9' below LWRP2014 SURFACE  
Green dashed contours are 12' below LWRP2014 SURFACE  
Blue dashed contours are 14' below LWRP2014 SURFACE

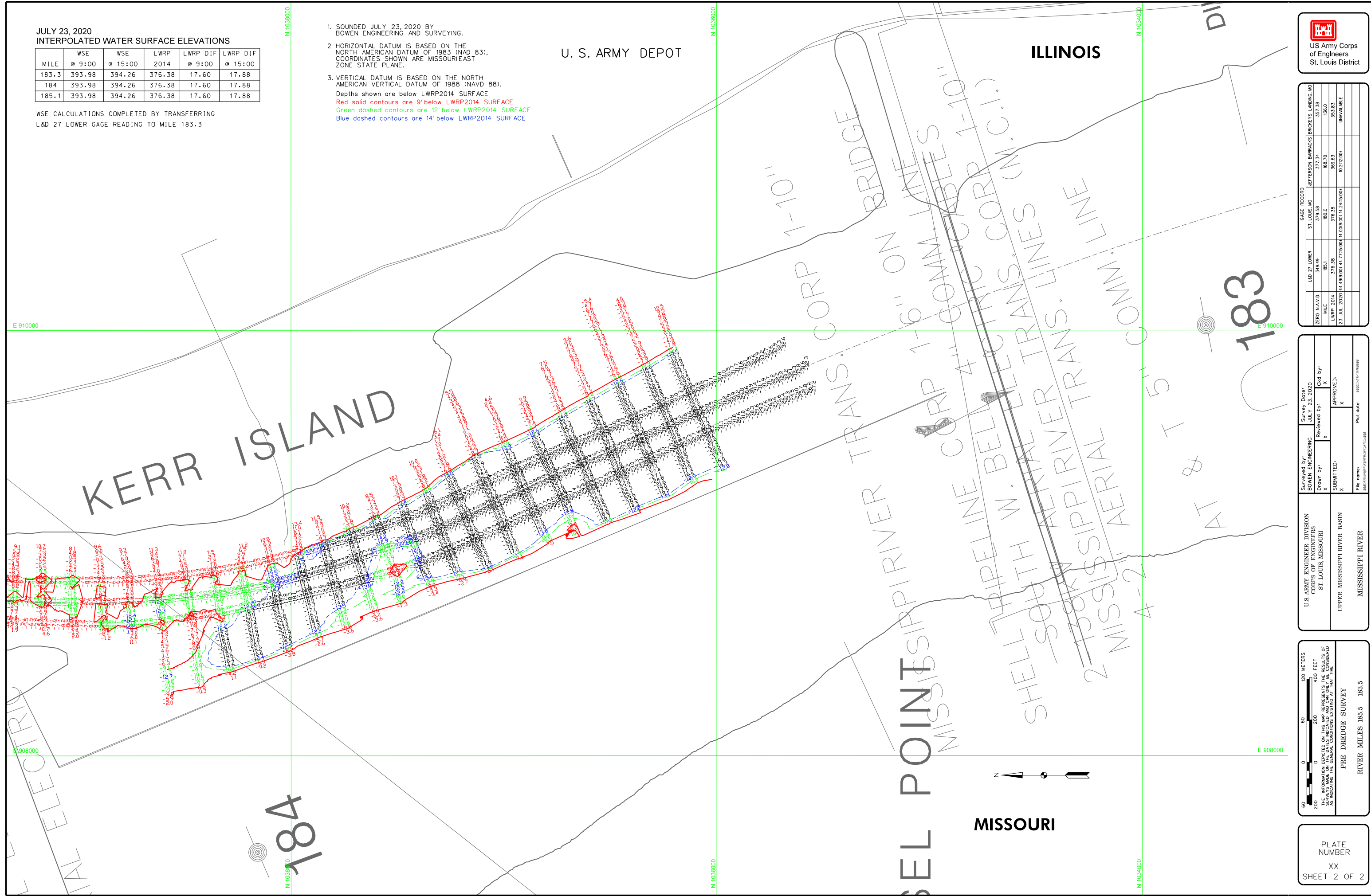

US Army Corps of Engineers  
St. Louis District

GAGE RECORD		JEFFERSON BARRACKS BRICKEY'S LANDING, MO	
L&D 27 LOWER	ST. LOUIS, MO	379.58	377.34
ZERO N.A.V.D.		349.49	347.25
MILE		185.1	186.70
LWRP 2014		376.38	369.63
23 JUL 2020	44.499(20) 44.711(5(20))	14.009(20) 14.215(5(20))	10.217(2(20))
			UNAVAILABLE

U.S. ARMY ENGINEER DIVISION CORPS OF ENGINEERS ST. LOUIS, MISSOURI		Survey Date: JULY 23, 2020	
Drawn by: A	Reviewed by: X	Checked by: A	Approved by: X
Submitted: X	Approved: X	Plot date: #888888888888	
UPPER MISSISSIPPI RIVER BASIN		MISSISSIPPI RIVER	

120 METERS  
60  
0  
200  
400 FEET  
THE INFORMATION DEPICTED ON THIS MAP REPRESENTS THE RESULTS OF A PRELIMINARY SURVEY AND IS NOT TO BE USED FOR ANY OTHER PURPOSE.  
PRE DREDGE SURVEY  
RIVER MILES 185.5 - 188.5

PLATE NUMBER  
XX  
SHEET 2 OF 2