

ILLINOIS

**JANUARY 12, 2021
INTERPOLATED WATER SURFACE ELEVATIONS**

MILE	WSE @ 10:00	WSE @ 13:00	LWRP 2014	LWRP DIF @ 10:00	LWRP DIF @ 13:00
182	382.56	382.31	376.38	6.18	5.93
183	382.87	382.46	376.38	6.49	6.08
183.3	382.96	382.51	376.38	6.58	6.13
184	383.92	383.65	376.38	7.54	7.27
185	385.29	385.29	376.94	8.35	8.35

WATER SURFACE ELEVATION CALCULATIONS WERE COMPLETED BY TRANSFERRING THE L&D 27 LOWER GAGE READING TO MILE 183.3.

GPS OBSERVATIONS WERE USED TO ESTABLISH WATER SURFACE ELEVATIONS IN THE OLD CHANNEL.

1. SOUNDED JANUARY 12, 2021 BY BOWEN ENGINEERING AND SURVEYING.
2. HORIZONTAL DATUM IS BASED ON THE NORTH AMERICAN DATUM OF 1983 (NAD 83). COORDINATES SHOWN ARE MISSOURI EAST ZONE STATE PLANE.
3. VERTICAL DATUM IS BASED ON THE NORTH AMERICAN VERTICAL DATUM OF 1988 (NAVD 88).

Depths shown are below LWRP2014 SURFACE
 Red solid contours are 9' below LWRP2014 SURFACE
 Green dashed contours are 12' below LWRP2014 SURFACE
 Blue dashed contours are 14' below LWRP2014 SURFACE

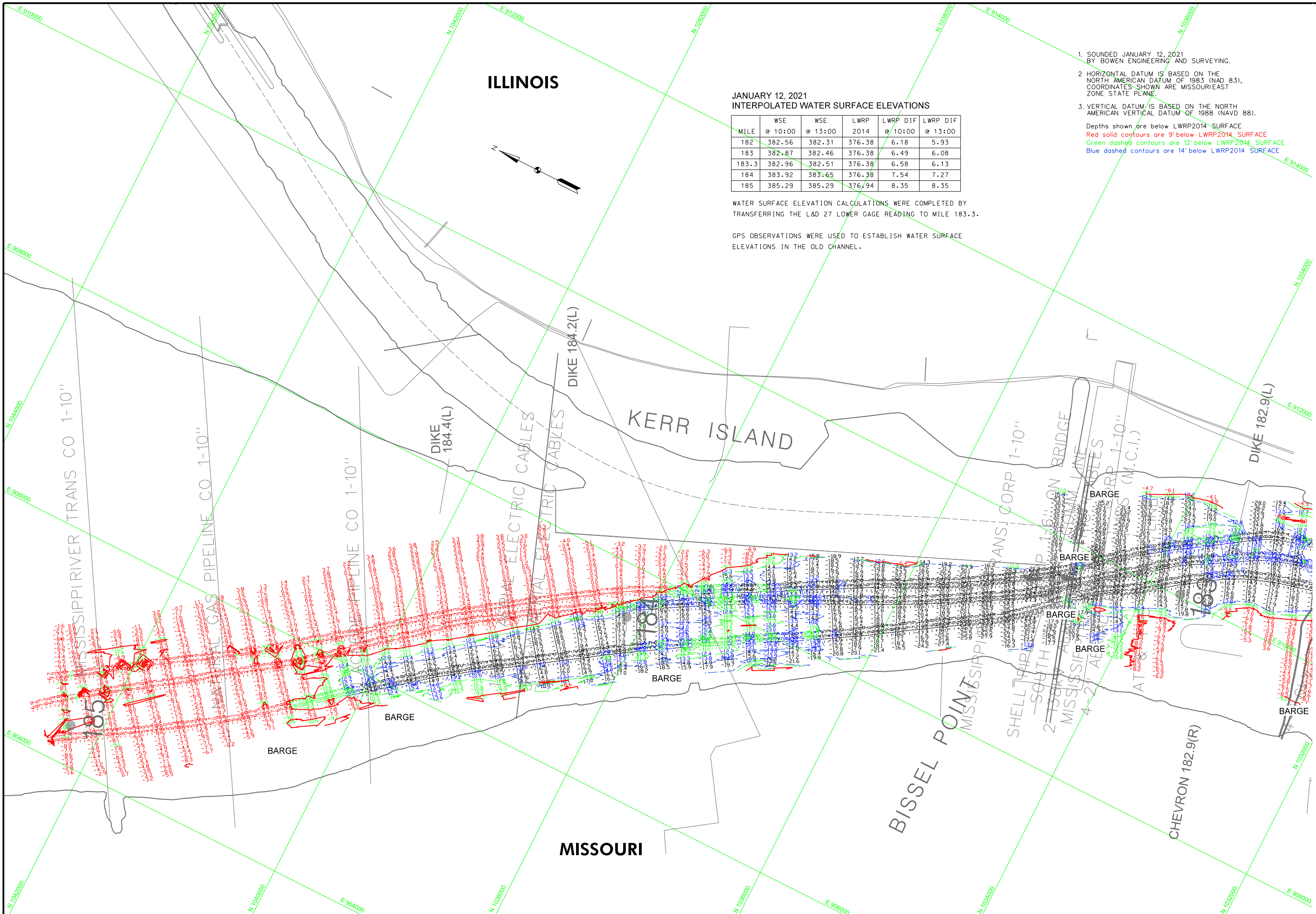

US Army Corps of Engineers
St. Louis District

GAGE RECORD		ST. LOUIS NO.
L&D 27 LOWER	379.58	
GPS OBSERVATION 1	349.49	
ZERO N.A.V.D.	185.1	180.0
MILE	185.0 (OLD CHANNEL)	
LWRP 2014	X	376.38
12 JAN 2021	385.29(2:00)	33.47(0:00) 33.02(1:00) 2.36(0:00) 2.41(1:00)

Survey Date: JANUARY 12, 2021	
Drawn by: X	Reviewed by: X
Submitted: X	APPROVED: X
Plot date: 1/12/2021 10:58:58 AM File name: 18330101.dwg	

U.S. ARMY ENGINEER DIVISION
CORPS OF ENGINEERS
ST. LOUIS, MISSOURI

UPPER MISSISSIPPI RIVER BASIN
MISSISSIPPI RIVER

POST DREDGE SURVEY
RIVER MILES 185.0 - 182.1