



US Army Corps of Engineers
St. Louis District

CHESTER I L	340.73
JEFFERSON BARRACKS	377.34
ST. LOUIS, MO	379.58
1&D 27 LOWER	349.49
ZERO N.A.V.D.	180.0
MILE	180.0
LWRP 2014	376.38
01 DEC 2020	38.42(14'-00") 7.59(09'-00") 7.47(14'-00") 5.97(20')

U.S. ARMY ENGINEER DIVISION CORPS OF ENGINEERS ST. LOUIS, MISSOURI	Survey Date: DECEMBER 1, 2020
UPPER MISSISSIPPI RIVER BASIN MISSISSIPPI RIVER	Reviewed by: X
	Drawn by: X
	Submitted: X
	Approved: X
	Plot date: 12/14/2020
	File name: 176.0 - 174.6

240 METERS	800 FEET
120	400
0	0
400	800
THE INFORMATION DEPICTED ON THIS MAP REPRESENTS THE RESULTS OF A PRELIMINARY SURVEY AND IS NOT TO BE USED FOR ANY OTHER PURPOSES WITHOUT THE EXPRESS WRITTEN PERMISSION OF THE U.S. ARMY CORPS OF ENGINEERS.	
PRE DREDGE SURVEY	
RIVER MILES 176.0 - 174.6	

PLATE NUMBER
XX

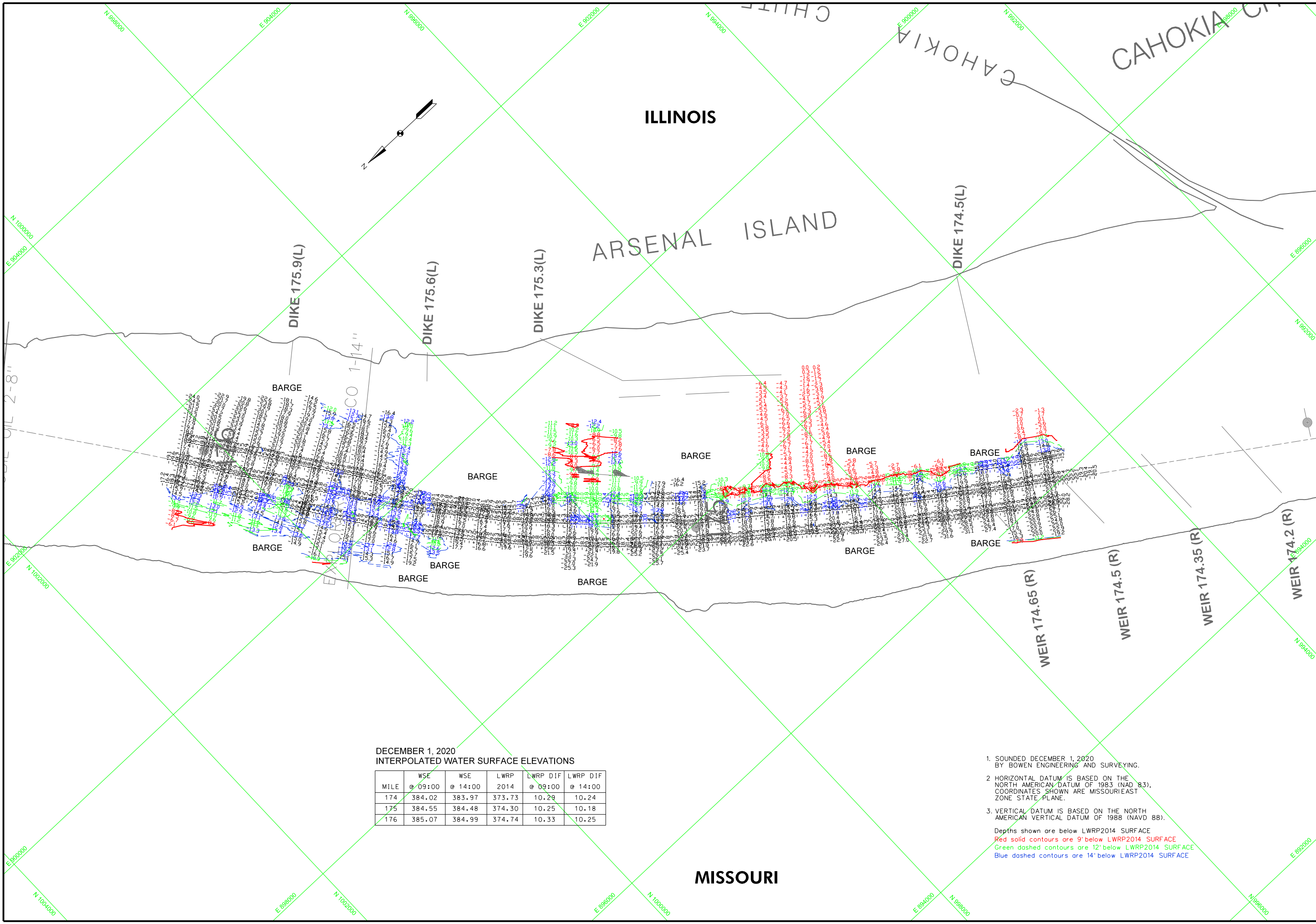

DECEMBER 1, 2020
INTERPOLATED WATER SURFACE ELEVATIONS

MILE	WSE		LWRP 2014	LWRP DIF	
	@ 09:00	@ 14:00		@ 09:00	@ 14:00
174	384.02	383.97	373.73	10.29	10.24
175	384.55	384.48	374.30	10.25	10.18
176	385.07	384.99	374.74	10.33	10.25

1. SOUNDED DECEMBER 1, 2020 BY BOWEN ENGINEERING AND SURVEYING.

2. HORIZONTAL DATUM IS BASED ON THE NORTH AMERICAN DATUM OF 1983 (NAD 83). COORDINATES SHOWN ARE MISSOURI EAST ZONE STATE PLANE.

3. VERTICAL DATUM IS BASED ON THE NORTH AMERICAN VERTICAL DATUM OF 1988 (NAVD 88).

Depths shown are below LWRP2014 SURFACE
Red solid contours are 9' below LWRP2014 SURFACE
Green dashed contours are 12' below LWRP2014 SURFACE
Blue dashed contours are 14' below LWRP2014 SURFACE

MISSOURI

ILLINOIS

ARSENAL ISLAND

CAHOKIA

CAHOKIA CITY

DIKE 175.9(L)

DIKE 175.6(L)

DIKE 175.3(L)

DIKE 174.5(L)

WEIR 174.65 (R)

WEIR 174.5 (R)

WEIR 174.35 (R)

WEIR 174.2 (R)

CO 1-14"

CO 2-8"