



US Army Corps of Engineers
St. Louis District

ST. LOUIS, MO	JEFFERSON BARRACKS BRICKEY'S LANDING, MO	CHESTER I L
ZERO N.A.V.D.	379.58	340.73
MILE	180.0	109.9
LWRP 2014	376.38	340.33
03 SEP 2020	4.2913(20) 4.4017(20)	7.3613(20) 7.5617(20)
	0.012(20)	UNAVAILABLE

U.S. ARMY ENGINEER DIVISION CORPS OF ENGINEERS ST. LOUIS, MISSOURI UPPER MISSISSIPPI RIVER BASIN MISSISSIPPI RIVER	Surveyed by: BOWEN ENGINEERING	Survey Date: SEPTEMBER 3, 2020	Drawn by: A	Reviewed by: X	Cad by: X
	Submitted: X	Approved: X	File name: E:\PROJECTS\2020\174.0-174.5\174.0-174.5.dwg	Plot date: 8/26/2020 10:58:58 AM	

170 400 800 1200	0 400 800 1200
240 METERS	800 FEET
THE INFORMATION DEPICTED ON THIS MAP REPRESENTS THE RESULTS OF A SURVEY CONDUCTED UNDER THE GENERAL CONDITIONS SET FORTH IN THE PRE DREDGE SURVEY RIVER MILES 176.0 - 174.5	

PLATE NUMBER
XX
SHEET 1 OF 1

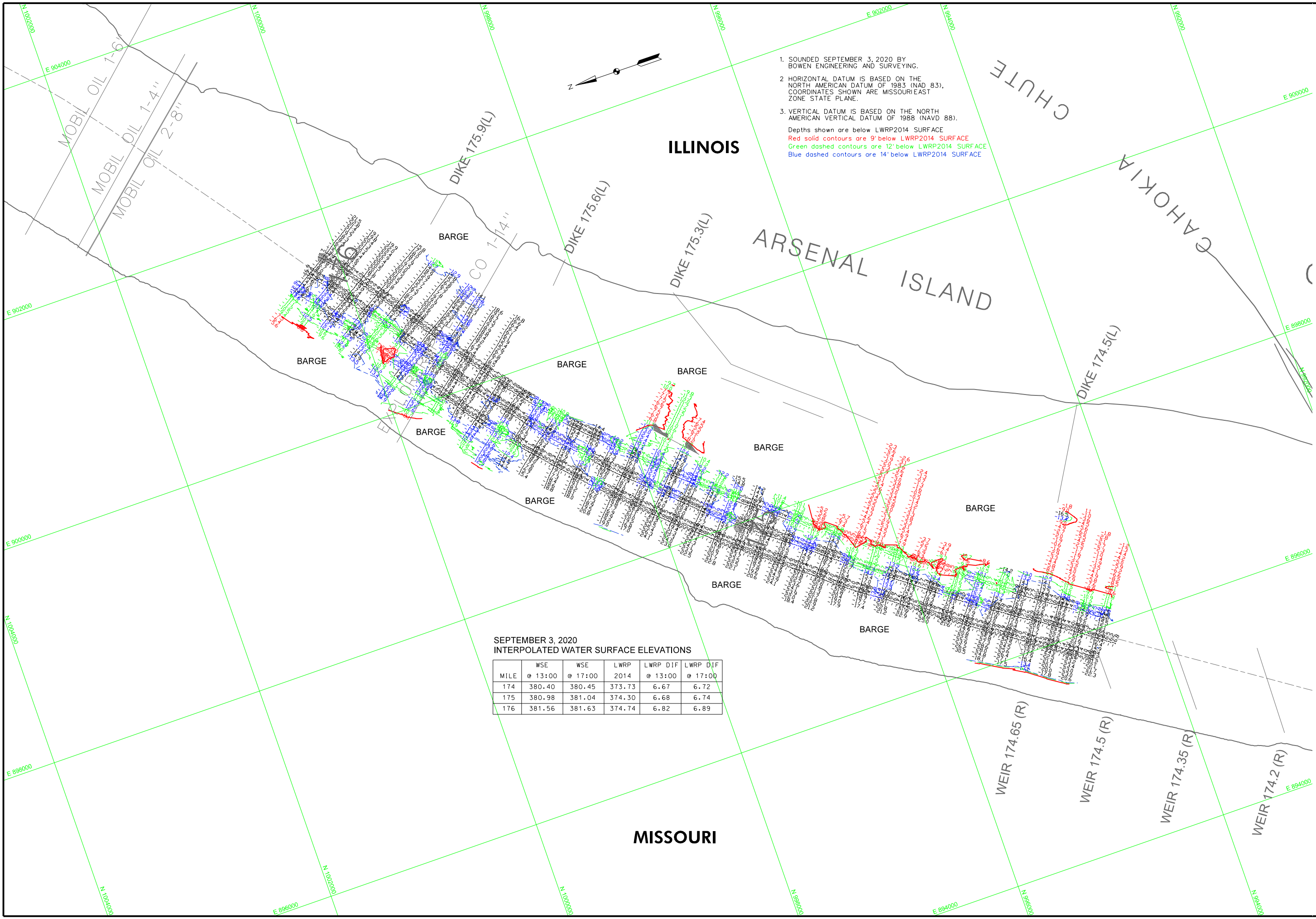

1. SOUNDED SEPTEMBER 3, 2020 BY BOWEN ENGINEERING AND SURVEYING.
 2. HORIZONTAL DATUM IS BASED ON THE NORTH AMERICAN DATUM OF 1983 (NAD 83). COORDINATES SHOWN ARE MISSOURI EAST ZONE STATE PLANE.
 3. VERTICAL DATUM IS BASED ON THE NORTH AMERICAN VERTICAL DATUM OF 1988 (NAVD 88).
- Depths shown are below LWRP2014 SURFACE
 Red solid contours are 9' below LWRP2014 SURFACE
 Green dashed contours are 12' below LWRP2014 SURFACE
 Blue dashed contours are 14' below LWRP2014 SURFACE

SEPTEMBER 3, 2020
INTERPOLATED WATER SURFACE ELEVATIONS

MILE	WSE		LWRP 2014	LWRP DIF	
	@ 13:00	@ 17:00		@ 13:00	@ 17:00
174	380.40	380.45	373.73	6.67	6.72
175	380.98	381.04	374.30	6.68	6.74
176	381.56	381.63	374.74	6.82	6.89