



US Army Corps of Engineers
St. Louis District

CHESTER L	340.73
ST. LOUIS, MO	379.58
JEFFERSON BARRACKS BRICKEY'S LANDING, MO	377.34
ZERO N.A.V.D.	357.38
MILE	188.70
LWRP 2014	376.38
BY AUG 2020	369.63
8.2011000 E.2675(SD)	340.33
11.4011000 E.2715(SD)	UNAVAILABLE
3.719500	

Surveyed by:	BOWEN ENGINEERING	Survey Date:	AUGUST 19, 2020
Drawn by:	X	Reviewed by:	X
Submitted:	X	Approved:	X
File name:	E:\PROJECTS\2020\174.0-174.5\174.0-174.5.dwg		
U.S. ARMY ENGINEER DIVISION	CORPS OF ENGINEERS		
ST. LOUIS, MISSOURI			
UPPER MISSISSIPPI RIVER BASIN			
MISSISSIPPI RIVER			

170	0	100	200	300	400	500	600	700	800	900	1000
METERS											
400	0	400	800	1200	1600	2000	2400	2800	3200	3600	4000
FEET											
THE INFORMATION DEPICTED ON THIS MAP REPRESENTS THE RESULTS OF A SURVEY CONDUCTED UNDER THE GENERAL CONDITIONS OF CONTRACT NO. 174.0-174.5.											
PRE DREDGE SURVEY											
RIVER MILES 176.0 - 174.5											

PLATE NUMBER
XX
SHEET 1 OF 1

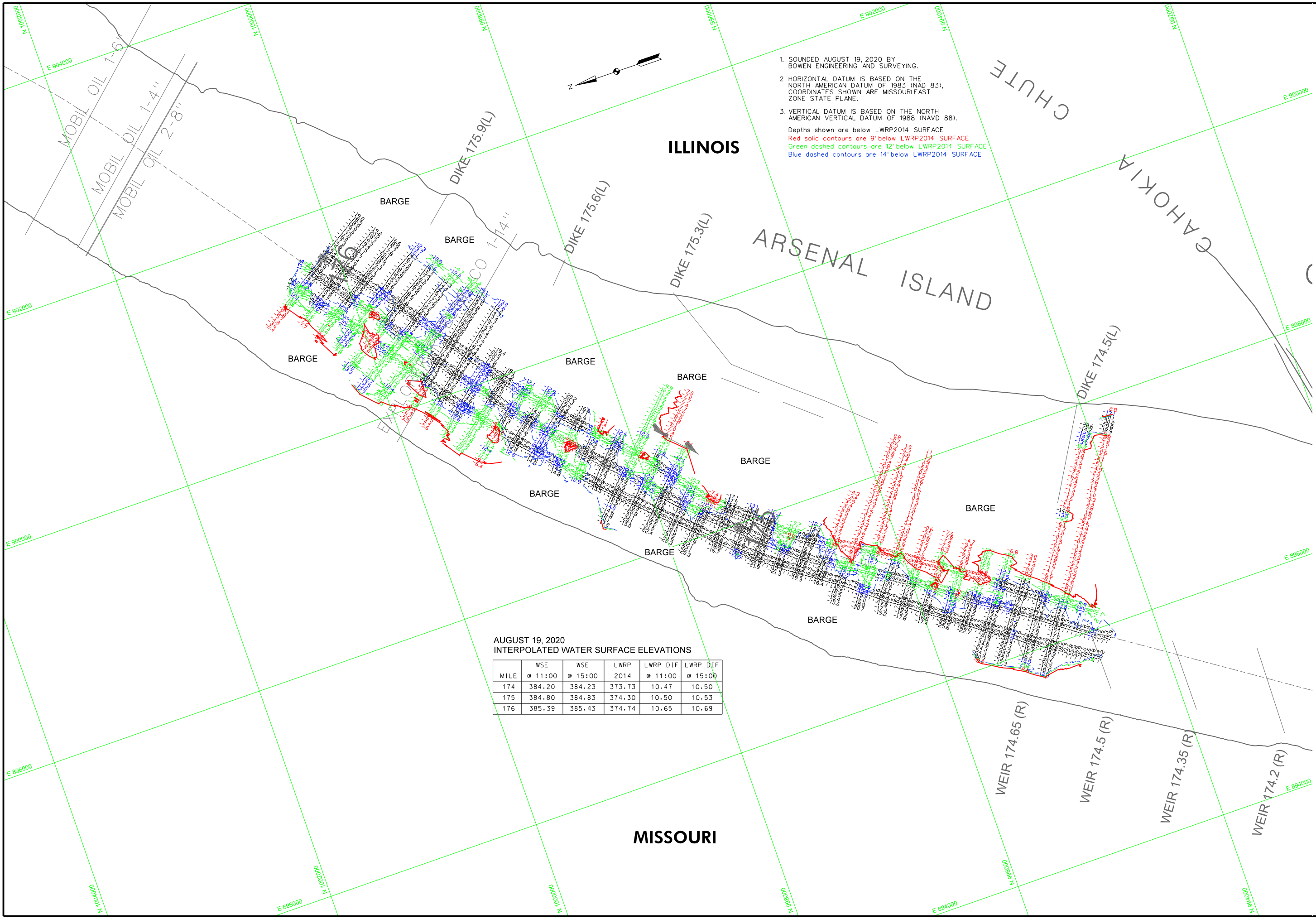

1. SOUNDED AUGUST 19, 2020 BY BOWEN ENGINEERING AND SURVEYING.
 2. HORIZONTAL DATUM IS BASED ON THE NORTH AMERICAN DATUM OF 1983 (NAD 83). COORDINATES SHOWN ARE MISSOURI EAST ZONE STATE PLANE.
 3. VERTICAL DATUM IS BASED ON THE NORTH AMERICAN VERTICAL DATUM OF 1988 (NAVD 88).
- Depths shown are below LWRP2014 SURFACE
 Red solid contours are 9' below LWRP2014 SURFACE
 Green dashed contours are 12' below LWRP2014 SURFACE
 Blue dashed contours are 14' below LWRP2014 SURFACE

AUGUST 19, 2020
INTERPOLATED WATER SURFACE ELEVATIONS

MILE	WSE		LWRP 2014	LWRP DIF	
	@ 11:00	@ 15:00		@ 11:00	@ 15:00
174	384.20	384.23	373.73	10.47	10.50
175	384.80	384.83	374.30	10.50	10.53
176	385.39	385.43	374.74	10.65	10.69