

ST. LOUIS, MO	CHESTER I.L.
379.58	340.73
180.0	109.9
376.38	340.33
134.0000 2.211500	UNAVAILABLE
07 JAN 2021	2.010330

U.S. ARMY ENGINEER DIVISION	ST. LOUIS, MISSOURI	UPPER MISSISSIPPI RIVER BASIN	MISSISSIPPI RIVER
Surveyed by: BOWEN ENGINEERING	Survey Date: JANUARY 7, 2021	Drawn by: X	Reviewed by: X
Submitted: X	Approved: X	File name: #88016E1716#	Plot date: #88016E1716#

240 METERS
120 METERS
0 METERS
400 FEET
800 FEET

THE INFORMATION DEPICTED ON THIS MAP REPRESENTS THE RESULTS OF A SURVEY CONDUCTED UNDER THE GENERAL CONDITIONS ESTABLISHED BY THE U.S. ARMY CORPS OF ENGINEERS.

POST DREDGE SURVEY
RIVER MILES 171.6 - 168.5

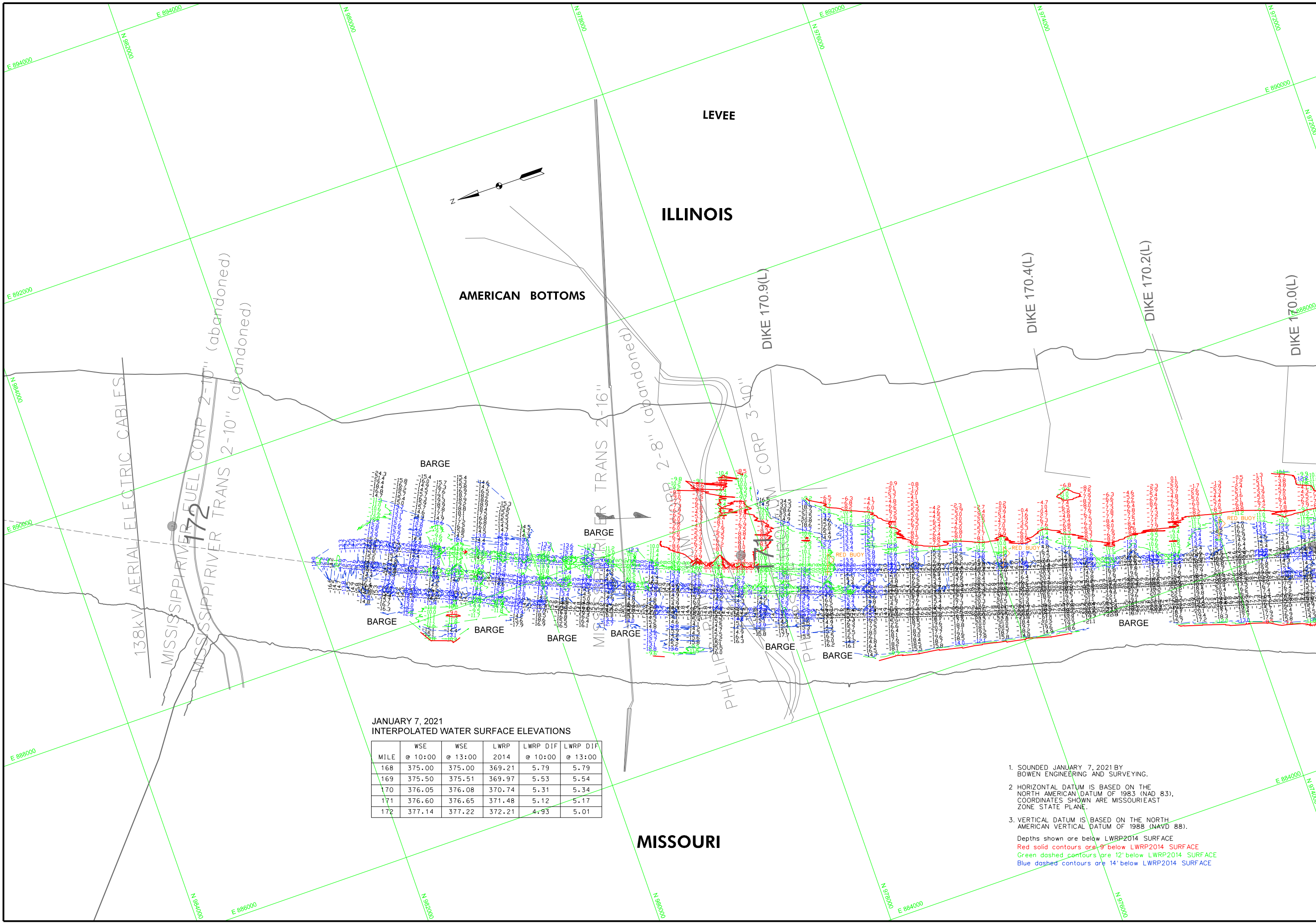

JANUARY 7, 2021
INTERPOLATED WATER SURFACE ELEVATIONS

MILE	WSE @ 10:00	WSE @ 13:00	LWRP 2014	LWRP DIF @ 10:00	LWRP DIF @ 13:00
168	375.00	375.00	369.21	5.79	5.79
169	375.50	375.51	369.97	5.53	5.54
170	376.05	376.08	370.74	5.31	5.34
171	376.60	376.65	371.48	5.12	5.17
172	377.14	377.22	372.21	4.93	5.01

- SOUNDED JANUARY 7, 2021 BY BOWEN ENGINEERING AND SURVEYING.
- HORIZONTAL DATUM IS BASED ON THE NORTH AMERICAN DATUM OF 1983 (NAD 83). COORDINATES SHOWN ARE MISSOURI EAST ZONE STATE PLANE.
- VERTICAL DATUM IS BASED ON THE NORTH AMERICAN VERTICAL DATUM OF 1988 (NAVD 88).
Depths shown are below LWRP2014 SURFACE
Red solid contours are 9' below LWRP2014 SURFACE
Green dashed contours are 12' below LWRP2014 SURFACE
Blue dashed contours are 14' below LWRP2014 SURFACE

ST. LOUIS, MO	JEFFERSON BARRACKS BRICKEY'S LANDING, MO	CHESTER, IL
379.58	377.34	340.73
180.0	188.70	109.9
376.38	369.63	340.33
194.000 2.211500	-2.010330	6.031000 1.991300

Surveyed by:	Survey Date:
BOWEN ENGINEERING	JANUARY 7, 2021
Drawn by:	Reviewed by:
X	X
Submitted:	Approved:
X	X
File name:	Plot date:
POST DREDGE SURVEY	07/01/2021

U.S. ARMY ENGINEER DIVISION
CORPS OF ENGINEERS
ST. LOUIS, MISSOURI
UPPER MISSISSIPPI RIVER BASIN
MISSISSIPPI RIVER

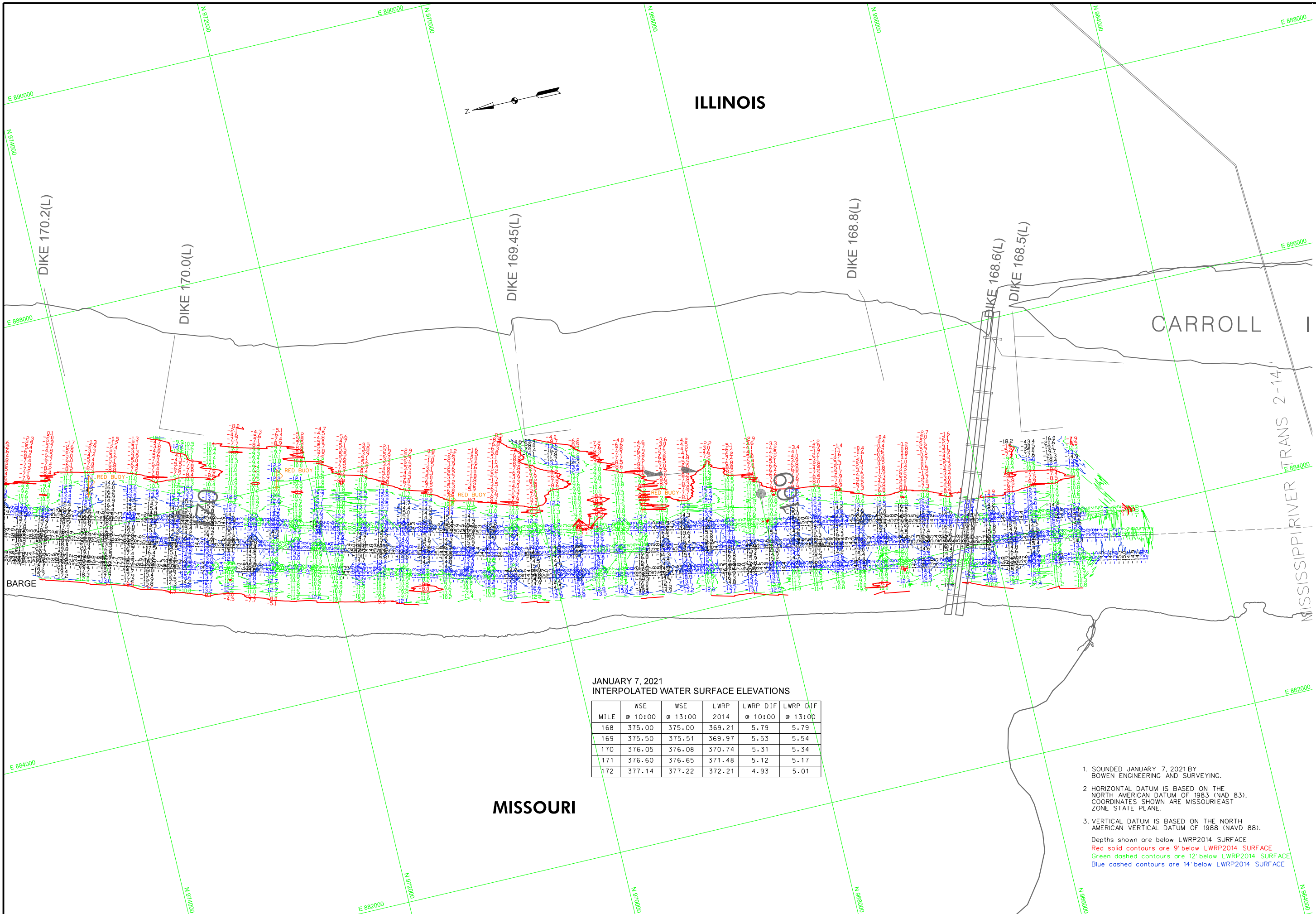

JANUARY 7, 2021
INTERPOLATED WATER SURFACE ELEVATIONS

MILE	WSE @ 10:00	WSE @ 13:00	LWRP 2014	LWRP DIF @ 10:00	LWRP DIF @ 13:00
168	375.00	375.00	369.21	5.79	5.79
169	375.50	375.51	369.97	5.53	5.54
170	376.05	376.08	370.74	5.31	5.34
171	376.60	376.65	371.48	5.12	5.17
172	377.14	377.22	372.21	4.93	5.01

1. SOUNDED JANUARY 7, 2021 BY BOWEN ENGINEERING AND SURVEYING.
 2. HORIZONTAL DATUM IS BASED ON THE NORTH AMERICAN DATUM OF 1983 (NAD 83). COORDINATES SHOWN ARE MISSOURI EAST ZONE STATE PLANE.
 3. VERTICAL DATUM IS BASED ON THE NORTH AMERICAN VERTICAL DATUM OF 1988 (NAVD 88).
- Depths shown are below LWRP2014 SURFACE
 Red solid contours are 9' below LWRP2014 SURFACE
 Green dashed contours are 12' below LWRP2014 SURFACE
 Blue dashed contours are 14' below LWRP2014 SURFACE

