



US Army Corps of Engineers  
St. Louis District

CHESTER I.L.	ST. LOUIS, MO	JEFFERSON BARRACKS BRICKEY'S LANDING, MO
340.73	379.58	377.34
340.9	380.0	388.70
340.33	376.38	369.83
UNAVAILABLE	390.00(0) 4.11(00)	-0.41(00)
6.74(000) 0.70(1500)		

Survey Date:	SEPTEMBER 24, 2020
Drawn by:	X
Reviewed by:	X
Approved:	X
Submitted:	X
File name:	PRE DREDGE SURVEY

U.S. ARMY ENGINEER DIVISION  
CORPS OF ENGINEERS  
ST. LOUIS, MISSOURI  
UPPER MISSISSIPPI RIVER BASIN  
MISSISSIPPI RIVER

240 METERS  
120  
0  
400  
800 FEET  
THE INFORMATION DEPICTED ON THIS MAP REPRESENTS THE RESULTS OF A SURVEY CONDUCTED IN ACCORDANCE WITH THE GENERAL CONDITIONS OF CONTRACT FOR THE PRE DREDGE SURVEY  
RIVER MILES 167.1 - 166.1

PLATE NUMBER  
XX  
SHEET 1 OF 1

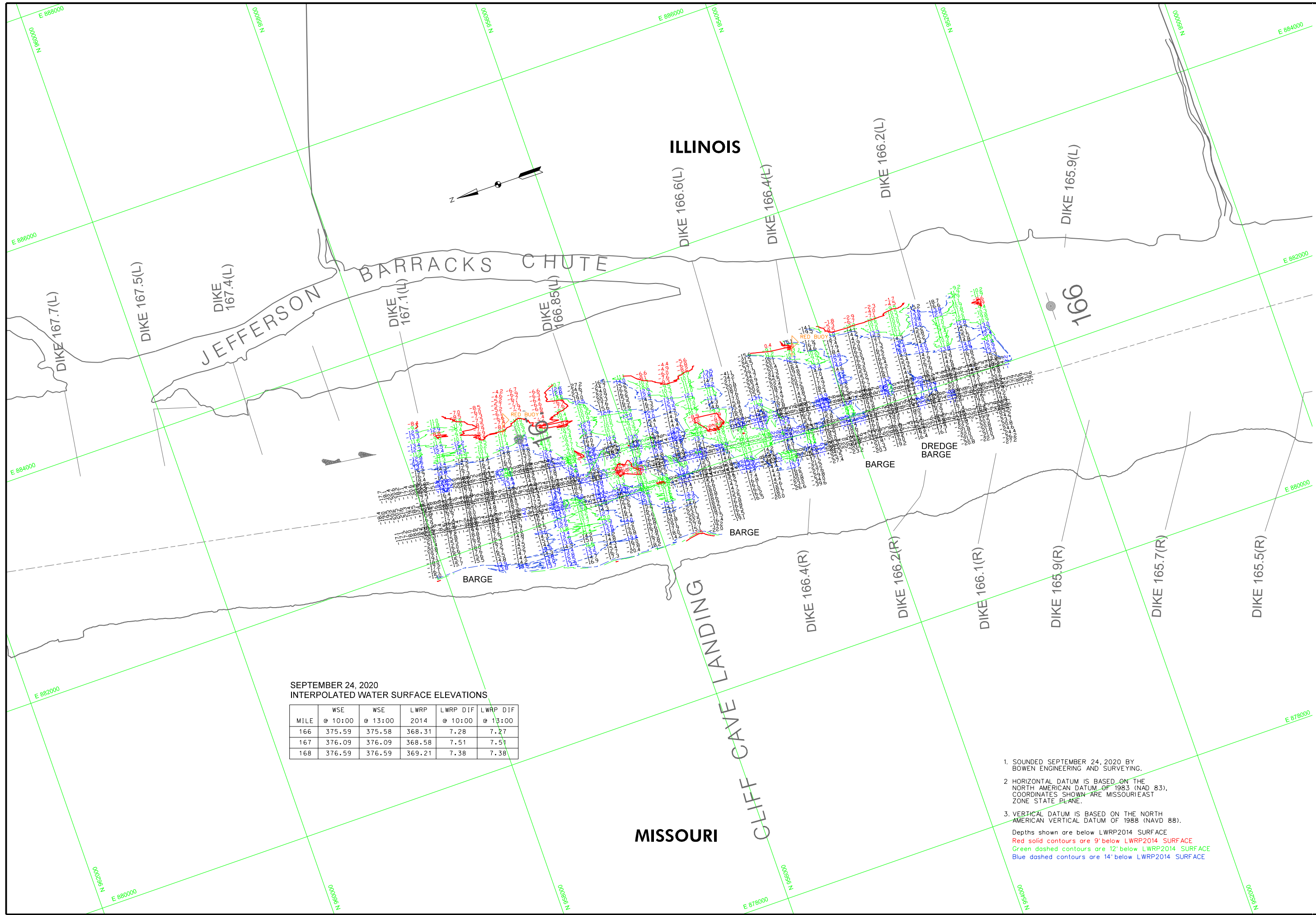

SEPTEMBER 24, 2020  
INTERPOLATED WATER SURFACE ELEVATIONS

MILE	WSE @ 10:00	WSE @ 13:00	LWRP 2014	LWRP DIF @ 10:00	LWRP DIF @ 13:00
166	375.59	375.58	368.31	7.28	7.27
167	376.09	376.09	368.58	7.51	7.51
168	376.59	376.59	369.21	7.38	7.38

- SOUNDED SEPTEMBER 24, 2020 BY BOWEN ENGINEERING AND SURVEYING.
- HORIZONTAL DATUM IS BASED ON THE NORTH AMERICAN DATUM OF 1983 (NAD 83), COORDINATES SHOWN ARE MISSOURI EAST ZONE STATE PLANE.
- VERTICAL DATUM IS BASED ON THE NORTH AMERICAN VERTICAL DATUM OF 1988 (NAVD 88).

Depths shown are below LWRP2014 SURFACE  
 Red solid contours are 9' below LWRP2014 SURFACE  
 Green dashed contours are 12' below LWRP2014 SURFACE  
 Blue dashed contours are 14' below LWRP2014 SURFACE