



US Army Corps of Engineers
St. Louis District

CHESTER I.L.	ST. LOUIS, MO	JEFFERSON BARRACKS BRICKEY'S LANDING, MO
340.73	379.93	377.34
340.9	380.0	388.70
340.33	376.38	369.63
UNAVAILABLE	3.915(500)	3.915(500)
12.0210(500) 11.951(500)		

U.S. ARMY ENGINEER DIVISION CORPS OF ENGINEERS ST. LOUIS, MISSOURI	UPPER MISSISSIPPI RIVER BASIN	MISSISSIPPI RIVER
Survey Date: AUGUST 18, 2020	Drawn by: X	Reviewed by: X
Submitted: X	Approved: X	Plot date: #88151E1018#88

PRE DREDGE SURVEY	RIVER MILES 167.1 - 166.4
170	0
400	0
800	0

PLATE NUMBER
XX
SHEET 1 OF 1

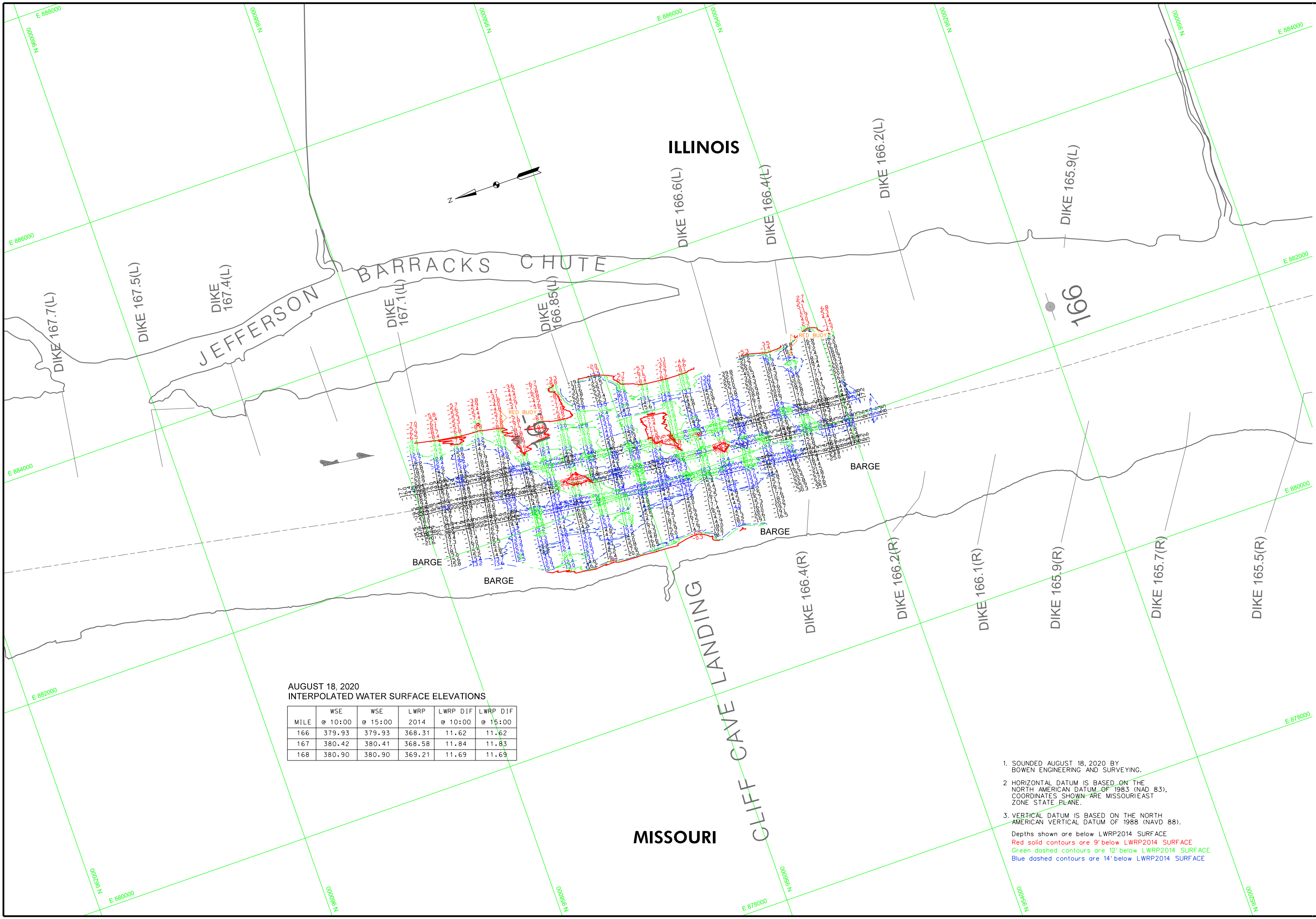

**AUGUST 18, 2020
INTERPOLATED WATER SURFACE ELEVATIONS**

MILE	WSE @ 10:00	WSE @ 15:00	LWRP 2014	LWRP DIF @ 10:00	LWRP DIF @ 15:00
166	379.93	379.93	368.31	11.62	11.62
167	380.42	380.41	368.58	11.84	11.83
168	380.90	380.90	369.21	11.69	11.69

- SOUNDED AUGUST 18, 2020 BY BOWEN ENGINEERING AND SURVEYING.
- HORIZONTAL DATUM IS BASED ON THE NORTH AMERICAN DATUM OF 1983 (NAD 83), COORDINATES SHOWN ARE MISSOURI EAST ZONE STATE PLANE.
- VERTICAL DATUM IS BASED ON THE NORTH AMERICAN VERTICAL DATUM OF 1988 (NAVD 88).
 Depths shown are below LWRP2014 SURFACE
 Red solid contours are 9' below LWRP2014 SURFACE
 Green dashed contours are 12' below LWRP2014 SURFACE
 Blue dashed contours are 14' below LWRP2014 SURFACE

ILLINOIS

MISSOURI

JEFFERSON BARRACKS CHUTE

CLIFF CAVE LANDING

BARGE

BARGE

166

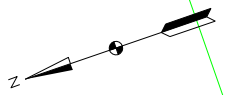

DIKE 166.6(L)

DIKE 166.4(L)

DIKE 166.2(L)

DIKE 165.9(L)

DIKE 167.7(L)

DIKE 167.5(L)

DIKE 167.4(L)

DIKE 167.1(L)

DIKE 166.85(L)

DIKE 166.4(R)

DIKE 166.2(R)

DIKE 166.1(R)

DIKE 165.9(R)

DIKE 165.7(R)

DIKE 165.5(R)

E 886000

E 884000

E 882000

E 882000

E 880000

E 878000

E 880000

E 878000

E 876000

E 874000

N 000956

N 000966

N 000976

N 000986

N 000996

N 000956

N 000966