



US Army Corps of Engineers
St. Louis District

1. SOUNDED AUGUST 18, 2020 BY BOWEN ENGINEERING AND SURVEYING.
2. HORIZONTAL DATUM IS BASED ON THE NORTH AMERICAN DATUM OF 1983. COORDINATES SHOWN ARE MISSOURIEAST ZONE STATE PLANE.
3. VERTICAL DATUM IS BASED ON THE NORTH AMERICAN VERTICAL DATUM OF 1988 (NAVD 88).

Depths shown are below LWRP2014 SURFACE
 Red solid contours are 9' below LWRP2014 SURFACE
 Green dashed contours are 12' below LWRP2014 SURFACE
 Blue dashed contours are 14' below LWRP2014 SURFACE

GAGE RECORD	
CHESTER L	340.73
JEFFERSON BARRACKS BRICKEY'S LANDING, MO	357.38
ST. LOUIS, MO	377.34
ZERO N.A.V.D.	379.58
MILE	180.0
LWRP 2014	376.38
18 AUG 2020	7.88(500)
UNAVAILABLE	3.01(500)
12.02(500)	13.91(500)

SURVEY DATA	
SURVEY DATE	AUGUST 18, 2020
Drawn by	Reviewed by
Submitted	APPROVED
FILE NAME	Plot date

U.S. ARMY ENGINEER DIVISION	
CORPS OF ENGINEERS	MISSISSIPPI RIVER BASIN
ST. LOUIS, MISSOURI	MISSISSIPPI RIVER

PRE DREDGE SURVEY	
RIVER MILES 163.6 - 162.5	

PLATE NUMBER
XX
SHEET 1 OF 1

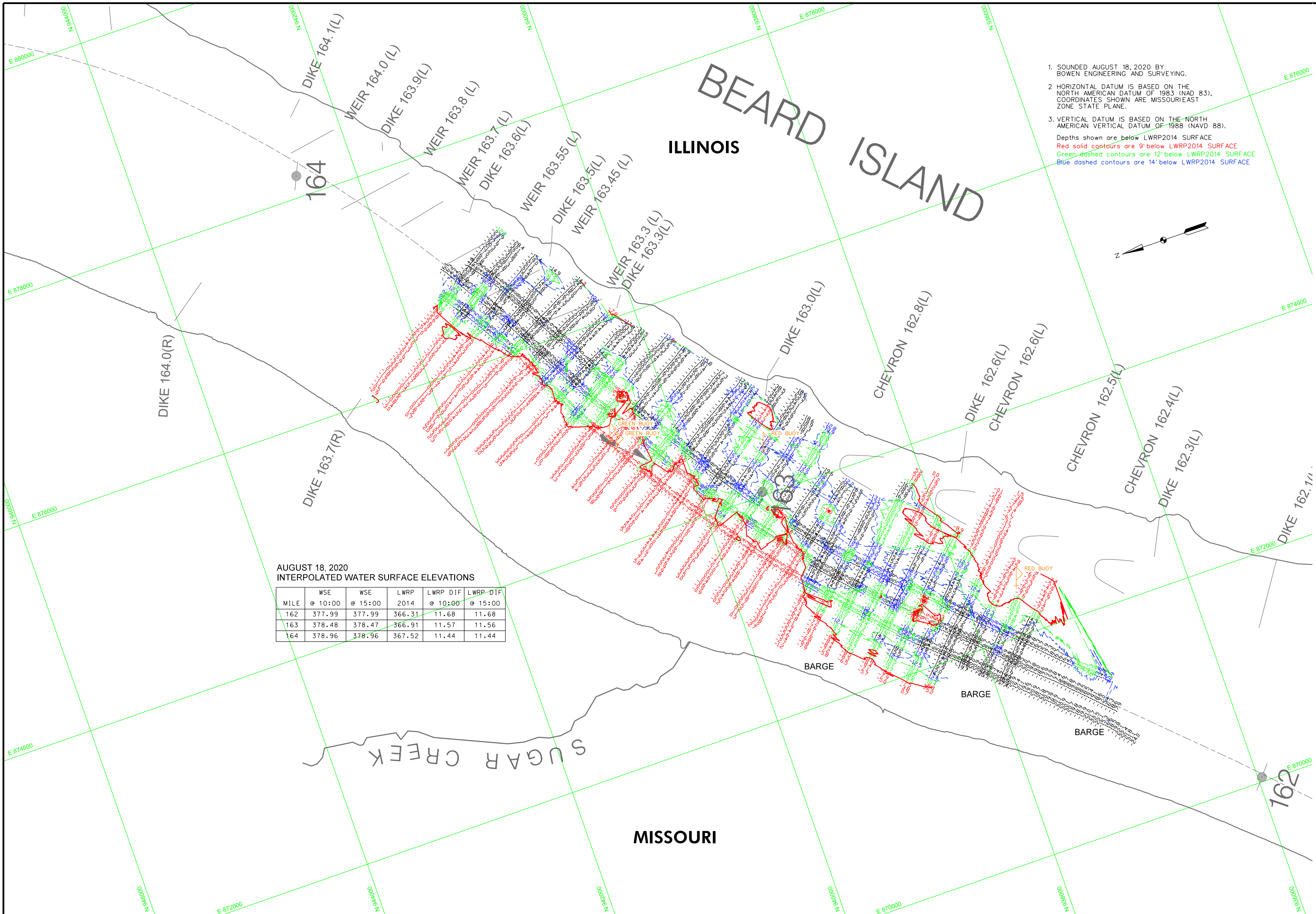

AUGUST 18, 2020
INTERPOLATED WATER SURFACE ELEVATIONS

MILE	WSE @ 10:00	WSE @ 15:00	LWRP 2014	LWRP DIF @ 10:00	LWRP DIF @ 15:00
162	377.99	377.99	366.31	11.68	11.68
163	378.48	378.47	366.91	11.57	11.56
164	378.96	378.96	367.52	11.44	11.44

