



US Army Corps of Engineers
St. Louis District

ST. LOUIS, MO	CHESTER, IL
379.58	340.73
377.34	357.38
388.70	316.0
369.63	353.83
376.38	340.33
6.1210(00) 5.0712(00)	9.3610(00) 5.4412(00)
	UNAVAILABLE
	X

Surveyed by:	Survey Date:
BOWEN ENGINEERING	NOVEMBER 18, 2020
Drawn by:	Reviewed by:
X	X
SUBMITTED:	APPROVED:
X	X
File name:	Plot date:
FILE: 1445.8 - 145.0	DATE: 11/18/2020

U.S. ARMY ENGINEER DIVISION
CORPS OF ENGINEERS
ST. LOUIS, MISSOURI
UPPER MISSISSIPPI RIVER BASIN
MISSISSIPPI RIVER

PLATE NUMBER
XX
SHEET 1 OF 1

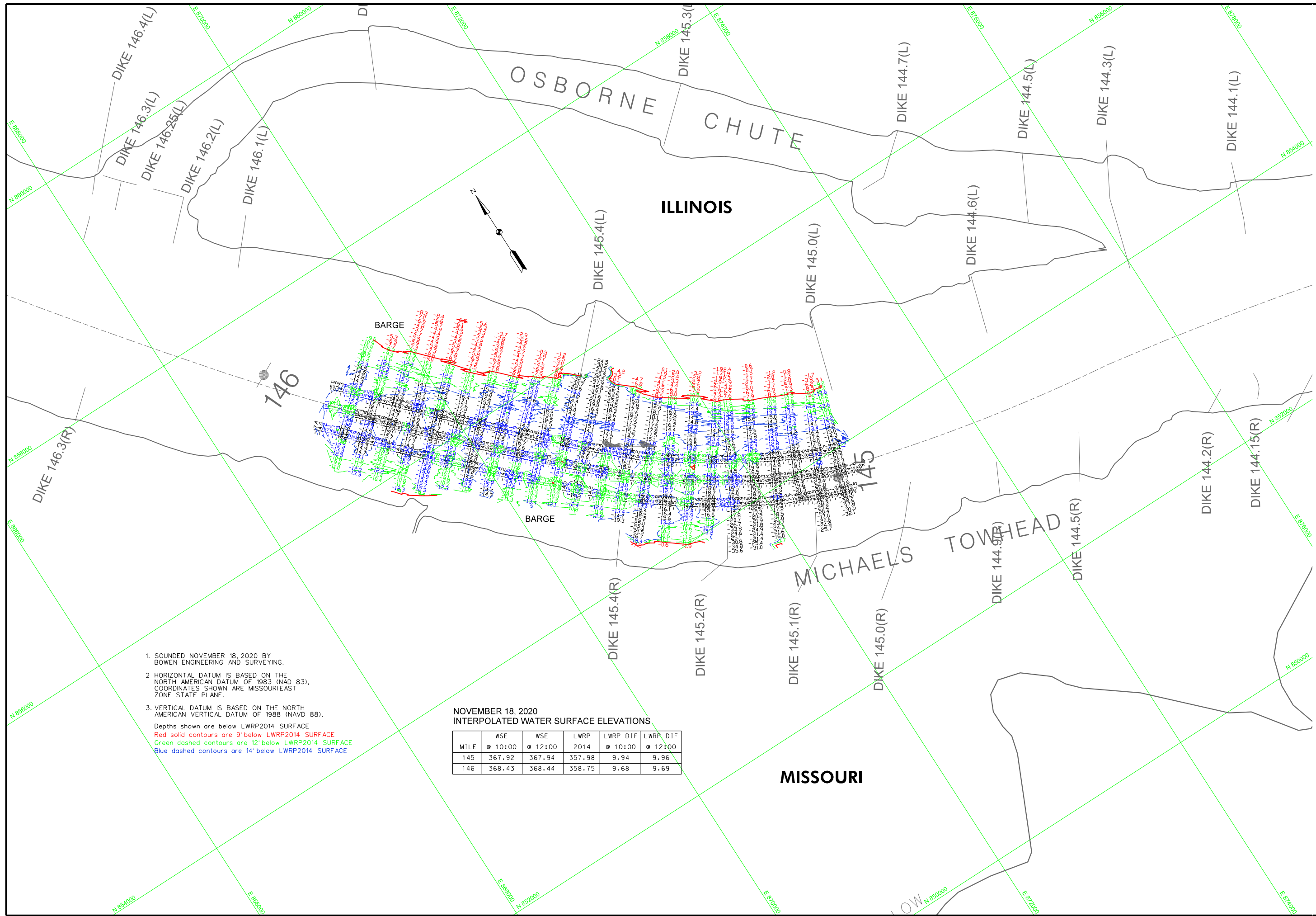

1. SOUNDED NOVEMBER 18, 2020 BY BOWEN ENGINEERING AND SURVEYING.
2. HORIZONTAL DATUM IS BASED ON THE NORTH AMERICAN DATUM OF 1983 (NAD 83), COORDINATES SHOWN ARE MISSOURI/EAST ZONE STATE PLANE.
3. VERTICAL DATUM IS BASED ON THE NORTH AMERICAN VERTICAL DATUM OF 1988 (NAVD 88).
Depths shown are below LWRP2014 SURFACE
Red solid contours are 9' below LWRP2014 SURFACE
Green dashed contours are 12' below LWRP2014 SURFACE
Blue dashed contours are 14' below LWRP2014 SURFACE

NOVEMBER 18, 2020
INTERPOLATED WATER SURFACE ELEVATIONS

MILE	WSE @ 10:00	WSE @ 12:00	LWRP 2014	LWRP DIF @ 10:00	LWRP DIF @ 12:00
145	367.92	367.94	357.98	9.94	9.96
146	368.43	368.44	358.75	9.68	9.69

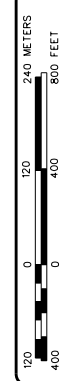

PRE DREDGE SURVEY
RIVER MILES 145.8 - 145.0