



US Army Corps of Engineers
St. Louis District

GAGE RECORD		JEFFERSON BARRACKS		RED ROCK LANDING, MO		GRAND TOWER, IL	
ZERO N.A.V.D.	CHESTER L	377.34	340.73	328.38	328.38	321.43	321.43
MILE	168.7	109.9	94.1	94.1	81.9	81.9	81.9
LWRP 2014	369.63	340.33	330.69	330.69	325.33	325.33	325.33
01 SEP 2020	X	X	X	X	X	X	X

SURVEYED BY		SURVEY DATE		FILE NAME	
Drawn by	Reviewed by	SEPTEMBER 1, 2020	Plot date	FILE NAME	Plot date
BOWEN ENGINEERING	X	SEPTEMBER 1, 2020	SEPTEMBER 1, 2020	UPPER MISSISSIPPI RIVER BASIN	UPPER MISSISSIPPI RIVER BASIN
Drawn by	Reviewed by	Submitted	Approved	FILE NAME	Plot date
X	X	X	X	UPPER MISSISSIPPI RIVER BASIN	UPPER MISSISSIPPI RIVER BASIN
Submitted	Approved	FILE NAME	Plot date	UPPER MISSISSIPPI RIVER BASIN	UPPER MISSISSIPPI RIVER BASIN
X	X	UPPER MISSISSIPPI RIVER BASIN	UPPER MISSISSIPPI RIVER BASIN	UPPER MISSISSIPPI RIVER BASIN	UPPER MISSISSIPPI RIVER BASIN

U.S. ARMY ENGINEER DIVISION
CORPS OF ENGINEERS
ST. LOUIS, MISSOURI

UPPER MISSISSIPPI RIVER BASIN
MISSISSIPPI RIVER

PRE DREDGE SURVEY
RIVER MILES 103.5 - 101.8

PLATE NUMBER
XX
SHEET 1 OF 1

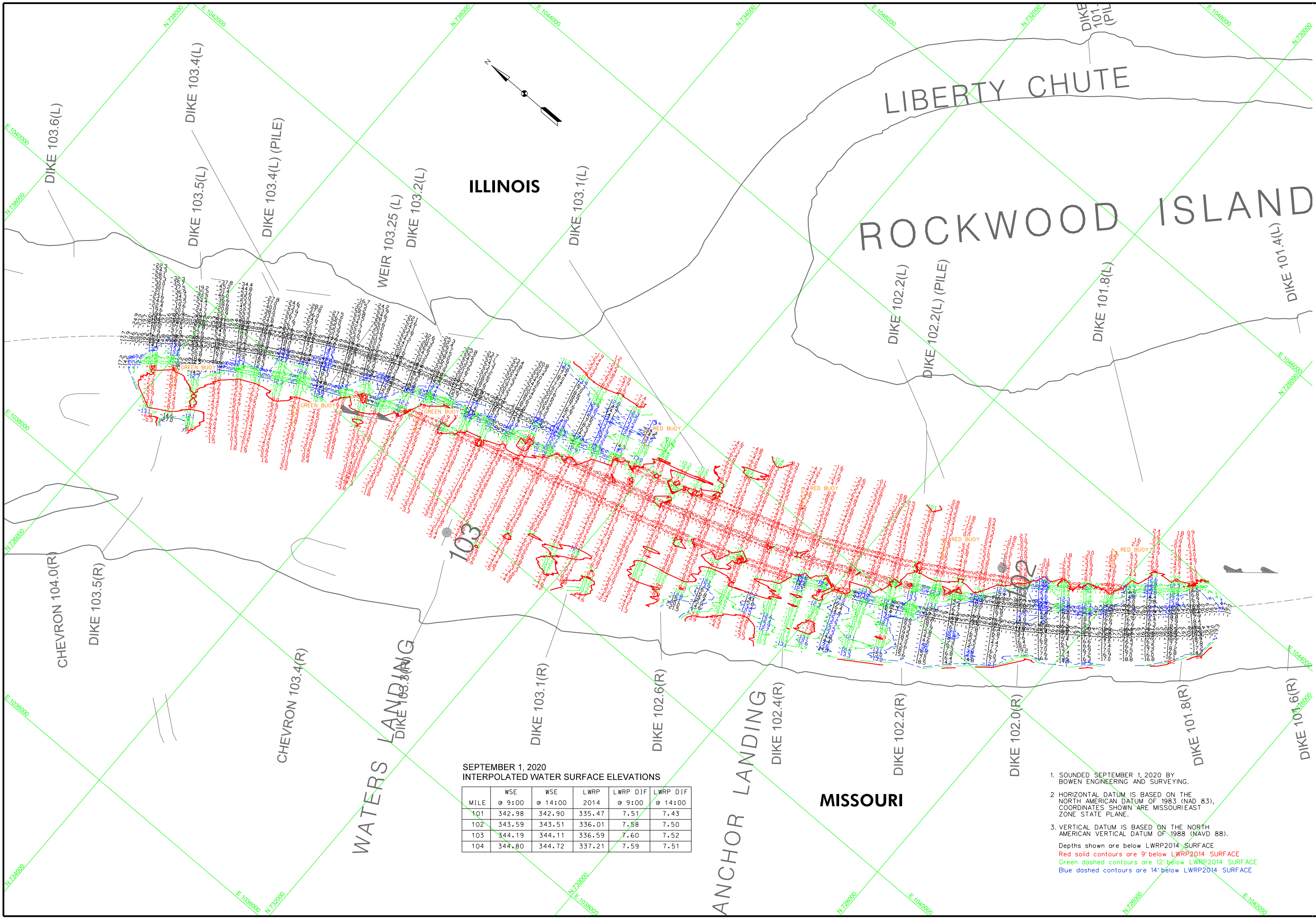

SEPTEMBER 1, 2020
INTERPOLATED WATER SURFACE ELEVATIONS

MILE	WSE		LWRP 2014	LWRP DIF	
	@ 9:00	@ 14:00		@ 9:00	@ 14:00
101	342.98	342.90	335.47	7.51	7.43
102	343.59	343.51	336.01	7.58	7.50
103	344.19	344.11	336.59	7.60	7.52
104	344.80	344.72	337.21	7.59	7.51

- SOUNDED SEPTEMBER 1, 2020 BY BOWEN ENGINEERING AND SURVEYING.
 - HORIZONTAL DATUM IS BASED ON THE NORTH AMERICAN DATUM OF 1983 (NAD 83). COORDINATES SHOWN ARE MISSOURI EAST ZONE STATE PLANE.
 - VERTICAL DATUM IS BASED ON THE NORTH AMERICAN VERTICAL DATUM OF 1988 (NAVD 88).
- Depths shown are below LWRP2014 SURFACE
 Red solid contours are 9' below LWRP2014 SURFACE
 Green dashed contours are 12' below LWRP2014 SURFACE
 Blue dashed contours are 14' below LWRP2014 SURFACE

