



US Army Corps of Engineers
St. Louis District

ZERO N.A.V.D. MILE	LWRP 2014	27 JAN 2021	13.339600 (34.471100)	15.119600 (15.111000)	
304.27	309.62	307.99	309.62	305.81	X
300.79	304.27	304.27	304.27	300.79	X
299.71	304.27	304.27	304.27	299.71	X

Surveyed by: BOWEN ENGINEERING	Survey Date: JANUARY 27, 2021	Drawn by: X	Reviewed by: X	Checked by: X
Submitted: X	Approved: X	Plot date: 08/01/2021		

U.S. ARMY ENGINEER DIVISION
CORPS OF ENGINEERS
ST. LOUIS, MISSOURI
UPPER MISSISSIPPI RIVER BASIN
MISSISSIPPI RIVER

170 0 100 200 300 400 500 600 700 800 900 1000 FEET

PRE DREDGE SURVEY
RIVER MILES 58.8 - 57.0

PLATE NUMBER
XX

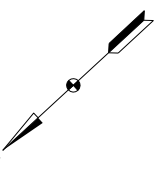
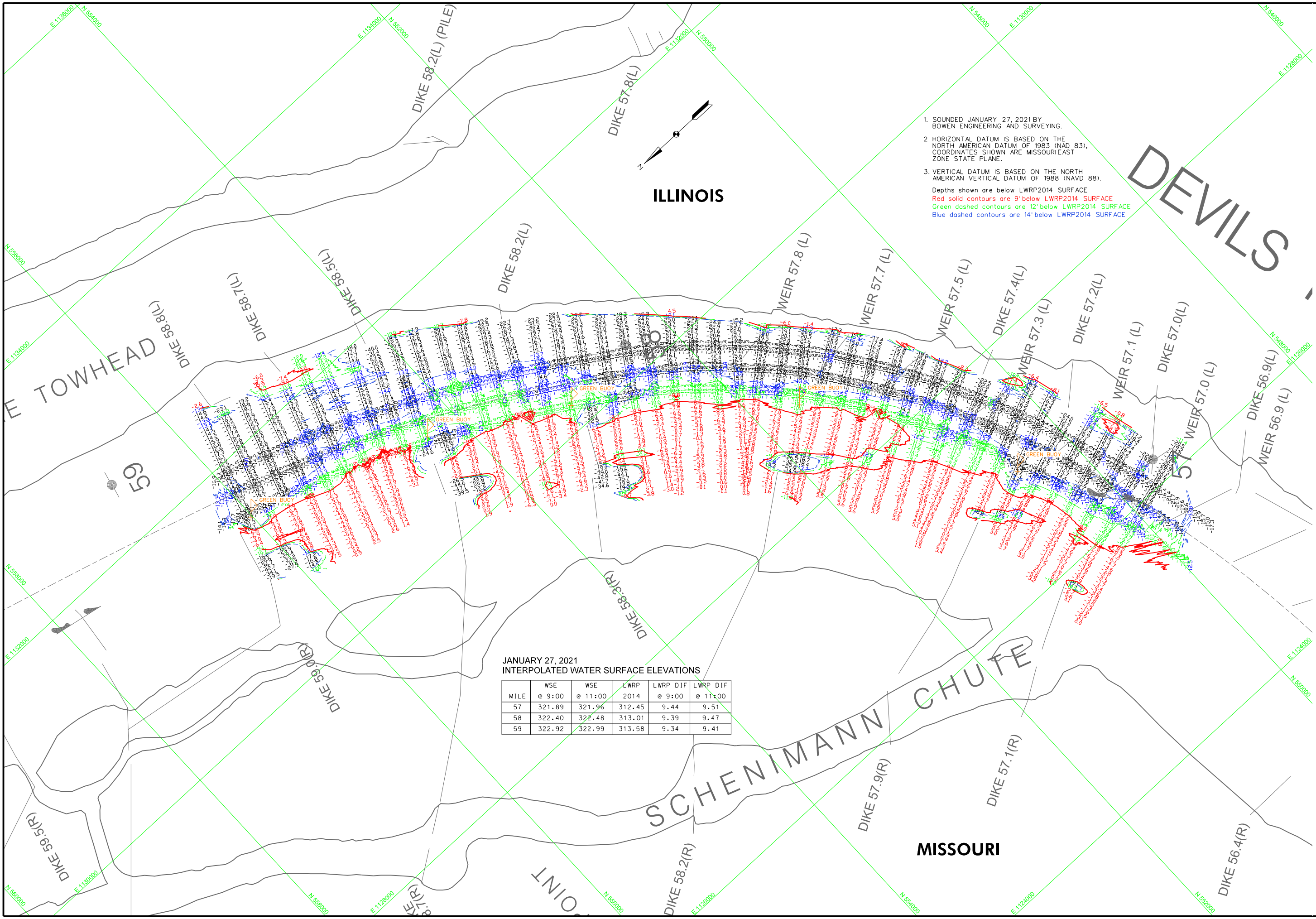

ILLINOIS

- SOUNDED JANUARY 27, 2021 BY BOWEN ENGINEERING AND SURVEYING.
 - HORIZONTAL DATUM IS BASED ON THE NORTH AMERICAN DATUM OF 1983 (NAD 83). COORDINATES SHOWN ARE MISSOURI EAST ZONE STATE PLANE.
 - VERTICAL DATUM IS BASED ON THE NORTH AMERICAN DATUM OF 1988 (NAVD 88).
- Depths shown are below LWRP2014 SURFACE
 Red solid contours are 9' below LWRP2014 SURFACE
 Green dashed contours are 12' below LWRP2014 SURFACE
 Blue dashed contours are 14' below LWRP2014 SURFACE

JANUARY 27, 2021
INTERPOLATED WATER SURFACE ELEVATIONS

MILE	WSE @ 9:00	WSE @ 11:00	LWRP 2014	LWRP DIF @ 9:00	LWRP DIF @ 11:00
57	321.89	321.96	312.45	9.44	9.51
58	322.40	322.48	313.01	9.39	9.47
59	322.92	322.99	313.58	9.34	9.41