

CAPE RECORD		GRAY'S POINT, MO		THEBES, IL	
CAPE GRADEAL NO	DATE	GRAY'S POINT, MO	DATE	THEBES, IL	DATE
304.27	5/21	300.79	7/1	299.71	10/60
309.42	10/42	305.81	8/1	314.7	19/5
13.359(20)	13.351(40)	13.819(20)	13.814(20)	13.993(20)	13.914(20)
					X

U.S. ARMY ENGINEER DIVISION CORPS OF ENGINEERS ST. LOUIS, MISSOURI		SURVEY DATE: JANUARY 5, 2021	
Drawn by:	Reviewed by:	Surveyed by:	Checked by:
Submitted:	Approved:		
UPPER MISSISSIPPI RIVER BASIN		MISSISSIPPI RIVER	
FILE NAME: 472.2 - 44.0		PLOT DATE: 01/05/2021	

PRE DREDGE SURVEY	
240 METERS	800 FEET
120	400
0	0

THE INFORMATION DEPICTED ON THIS MAP REPRESENTS THE RESULTS OF A SURVEY CONDUCTED UNDER THE GENERAL CONDITIONS ESTABLISHED BY THE U.S. ARMY ENGINEER DIVISION.

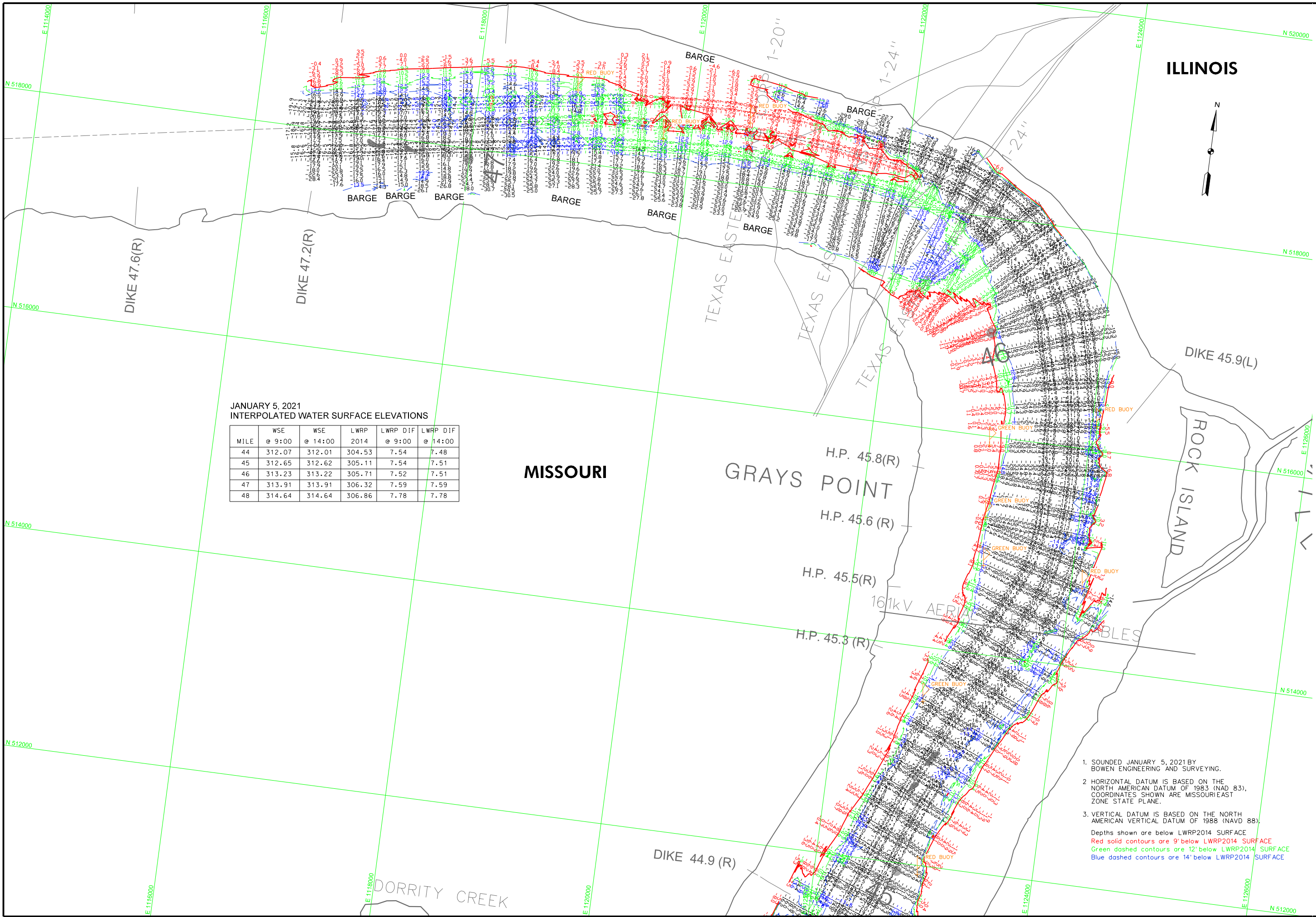

JANUARY 5, 2021  
INTERPOLATED WATER SURFACE ELEVATIONS

MILE	WSE		LWRP 2014	LWRP DIF	
	@ 9:00	@ 14:00		@ 9:00	@ 14:00
44	312.07	312.01	304.53	7.54	7.48
45	312.65	312.62	305.11	7.54	7.51
46	313.23	313.22	305.71	7.52	7.51
47	313.91	313.91	306.32	7.59	7.59
48	314.64	314.64	306.86	7.78	7.78

- SOUNDED JANUARY 5, 2021 BY BOWEN ENGINEERING AND SURVEYING.
  - HORIZONTAL DATUM IS BASED ON THE NORTH AMERICAN DATUM OF 1983 (NAD 83). COORDINATES SHOWN ARE MISSOURI EAST ZONE STATE PLANE.
  - VERTICAL DATUM IS BASED ON THE NORTH AMERICAN VERTICAL DATUM OF 1988 (NAVD 88).
- Depths shown are below LWRP2014 SURFACE  
 Red solid contours are 9' below LWRP2014 SURFACE  
 Green dashed contours are 12' below LWRP2014 SURFACE  
 Blue dashed contours are 14' below LWRP2014 SURFACE