



US Army Corps of Engineers  
St. Louis District

COMMERCE NO	THEBES, L	GRAY'S POINT, MO	CAPE GARDEAU, MO	CAPE GARDEAU, MO
0160	299.71	300.79	304.27	304.27
39.5	43.7	46.3	52.1	52.1
3012	354.61	305.81	309.62	309.62
X	11,031,903.301 (NAD 83)	11,498,933.301 (NAD 83)	12,886,933.301 (NAD 83)	12,886,933.301 (NAD 83)

U.S. ARMY ENGINEER DIVISION	U.S. ARMY ENGINEER DIVISION	U.S. ARMY ENGINEER DIVISION
CORPS OF ENGINEERS	CORPS OF ENGINEERS	CORPS OF ENGINEERS
ST. LOUIS, MISSOURI	ST. LOUIS, MISSOURI	ST. LOUIS, MISSOURI
UPPER MISSISSIPPI RIVER BASIN	UPPER MISSISSIPPI RIVER BASIN	UPPER MISSISSIPPI RIVER BASIN
MISSISSIPPI RIVER	MISSISSIPPI RIVER	MISSISSIPPI RIVER

POST DREDGE SURVEY	POST DREDGE SURVEY
RIVER MILES 47.0 - 46.3	RIVER MILES 47.0 - 46.3

PLATE NUMBER  
XX  
SHEET 1 OF 1

# ILLINOIS

## DECEMBER 11, 2020 INTERPOLATED WATER SURFACE ELEVATIONS

MILE	WSE @ 10:30	WSE @ 13:00	LWRP 2014	LWRP DIF @ 10:30	LWRP DIF @ 13:00
46	312.10	311.98	305.71	6.39	6.27
47	312.87	312.77	306.32	6.55	6.45

1. SOUNDED DECEMBER 11, 2020 BY BOWEN ENGINEERING AND SURVEYING.
  2. HORIZONTAL DATUM IS BASED ON THE NORTH AMERICAN DATUM OF 1983 (NAD 83). COORDINATES SHOWN ARE MISSOURI EAST ZONE STATE PLANE.
  3. VERTICAL DATUM IS BASED ON THE NORTH AMERICAN VERTICAL DATUM OF 1988 (NAVD 88).
- Depths shown are below LWRP2014 SURFACE  
 Red solid contours are 9' below LWRP2014 SURFACE  
 Green dashed contours are 12' below LWRP2014 SURFACE  
 Blue dashed contours are 14' below LWRP2014 SURFACE

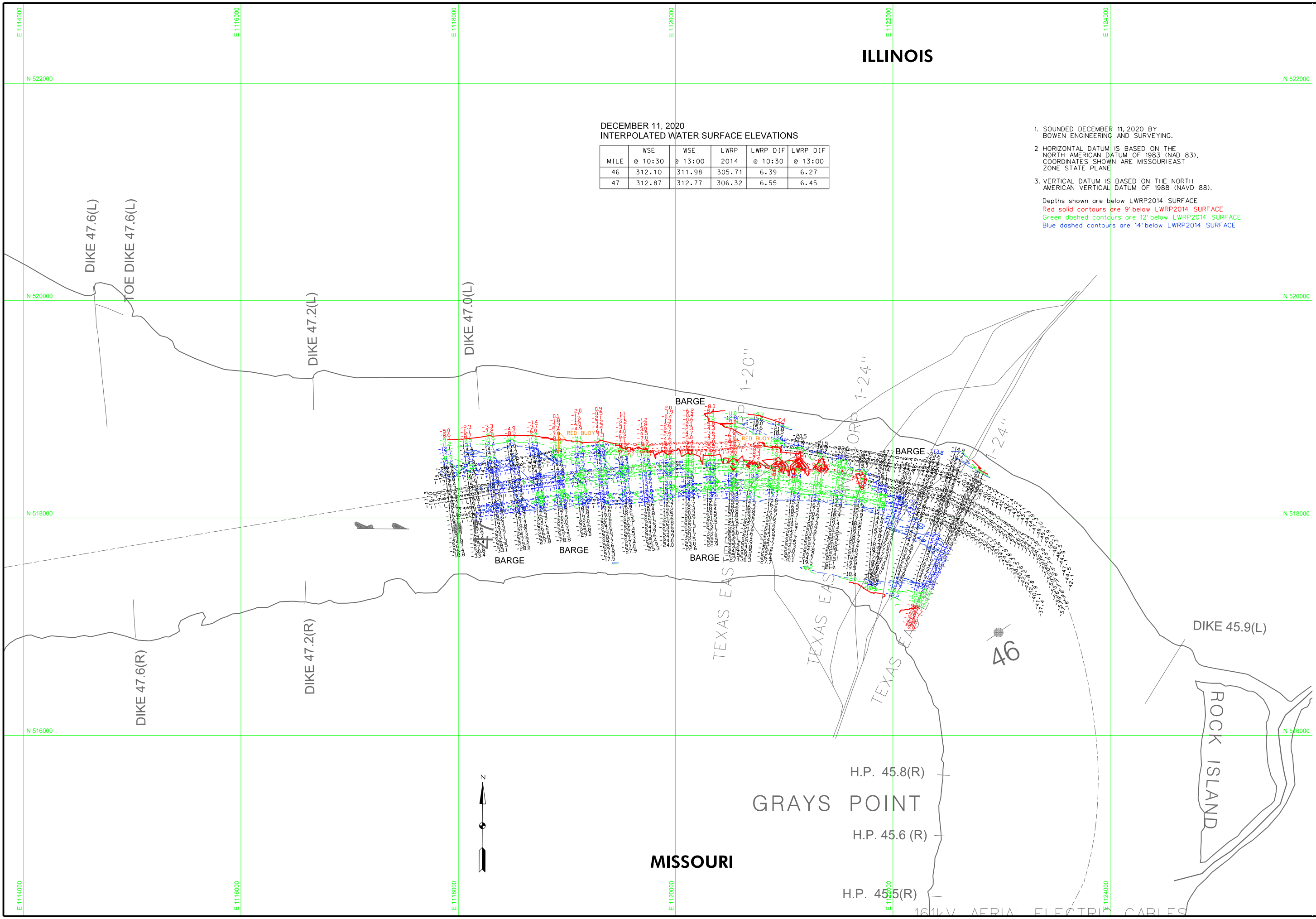

# MISSOURI

H.P. 45.8(R)  
 GRAYS POINT  
 H.P. 45.6 (R)  
 H.P. 45.5(R)

161kV AERIAL ELECTRIC CABLES