



US Army Corps of Engineers  
St. Louis District

CASE RECORD		COMMERCE NO	
CAPE GRADEAL NO	GRAY'S POINT MO	HERBES, L	10160
ZERO N.A.V.D.	304.27	300.79	299.71
MILE	52.1	46.3	43.7
LWRP 2014	309.62	305.81	304.61
23 JAN 2021	10.358(00) 10.581(00)	10.148(00) 10.221(00)	X

SURVEYED BY		SURVEY DATE	
BOWEN ENGINEERING	JANUARY 23, 2021	Drawn by:	Checked by:
X	X	X	X
Submitted:	APPROVED:	File name:	Plot date:
X	X		

U.S. ARMY ENGINEER DIVISION  
CORPS OF ENGINEERS  
ST. LOUIS, MISSOURI

UPPER MISSISSIPPI RIVER BASIN  
MISSISSIPPI RIVER

PRE DREDGE SURVEY  
RIVER MILES 47.0 - 45.5

PLATE NUMBER  
XX

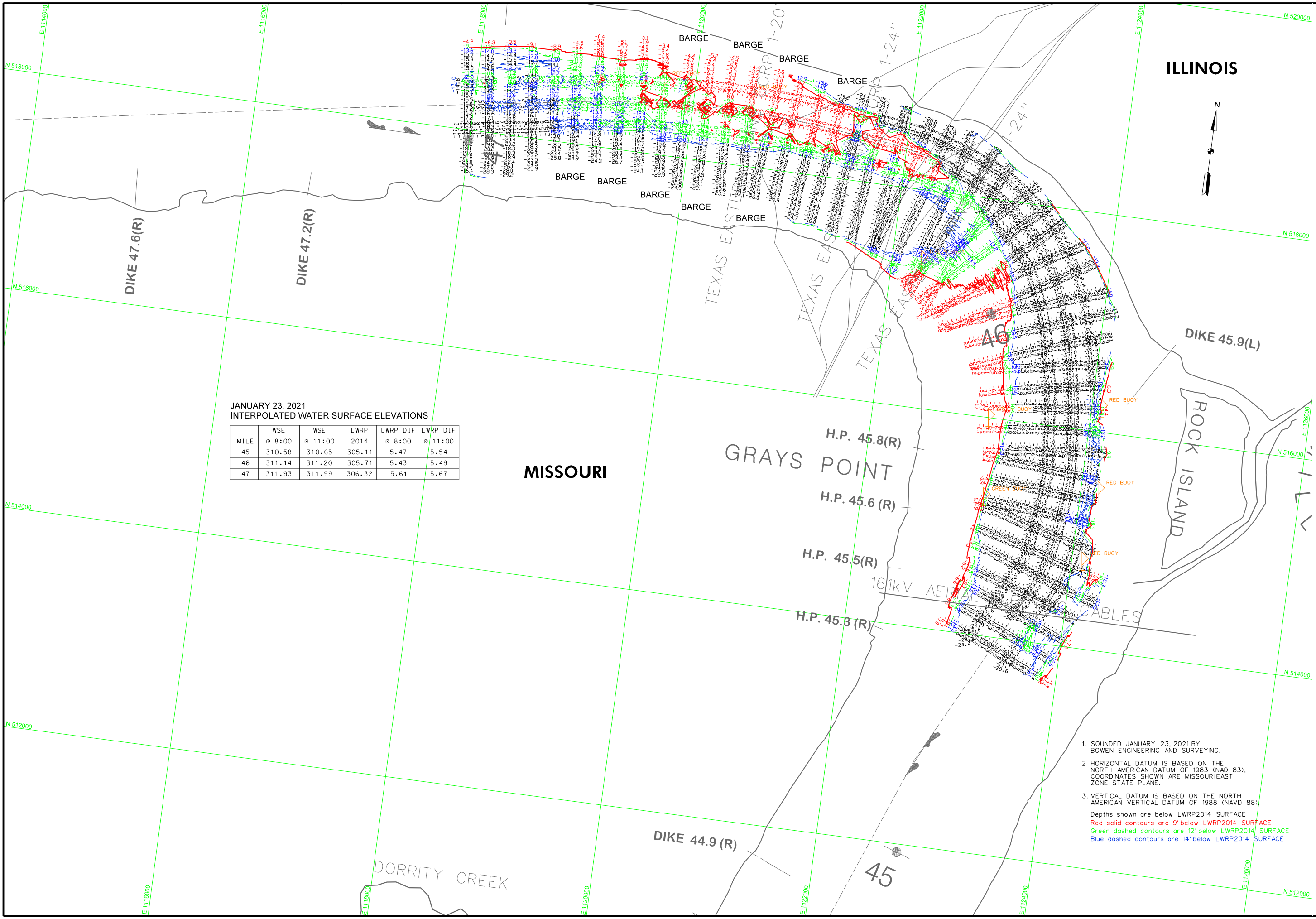

JANUARY 23, 2021  
INTERPOLATED WATER SURFACE ELEVATIONS

MILE	WSE		LWRP 2014	LWRP DIF	
	@ 8:00	@ 11:00		@ 8:00	@ 11:00
45	310.58	310.65	305.11	5.47	5.54
46	311.14	311.20	305.71	5.43	5.49
47	311.93	311.99	306.32	5.61	5.67

- SOUNDED JANUARY 23, 2021 BY BOWEN ENGINEERING AND SURVEYING.
  - HORIZONTAL DATUM IS BASED ON THE NORTH AMERICAN DATUM OF 1983 (NAD 83). COORDINATES SHOWN ARE MISSOURI EAST ZONE STATE PLANE.
  - VERTICAL DATUM IS BASED ON THE NORTH AMERICAN VERTICAL DATUM OF 1988 (NAVD 88).
- Depths shown are below LWRP2014 SURFACE  
 Red solid contours are 9' below LWRP2014 SURFACE  
 Green dashed contours are 12' below LWRP2014 SURFACE  
 Blue dashed contours are 14' below LWRP2014 SURFACE

