



US Army Corps of Engineers
St. Louis District

COMMERCE NO		GAGE RECORD	
10160	1985	PRECS LANDING	THOMPSON LANDING
1985	2012	288.95	279.03
2012	1651000116611500	288.2	273.91
1651000116611500	1651000116611500	284.38	270.0
1651000116611500	1651000116611500	284.38	280.38
1651000116611500	1651000116611500	14.617300	X
08 OCT 2020	5.870000 1.96113000		

U.S. ARMY ENGINEER DIVISION		SURVEY DATE:	
CORPS OF ENGINEERS		OCTOBER 8, 2020	
ST. LOUIS, MISSOURI		Drawn by:	Created by:
UPPER MISSISSIPPI RIVER BASIN		X	X
MISSISSIPPI RIVER		Reviewed by:	APPROVED:
		X	X
		SUBMITTED:	Plot date:
		X	8/20/2020 10:49:49 AM

PRE DREDGE SURVEY	
RIVER MILES 24.3 - 23.7	

PLATE NUMBER
XX
SHEET 1 OF 1

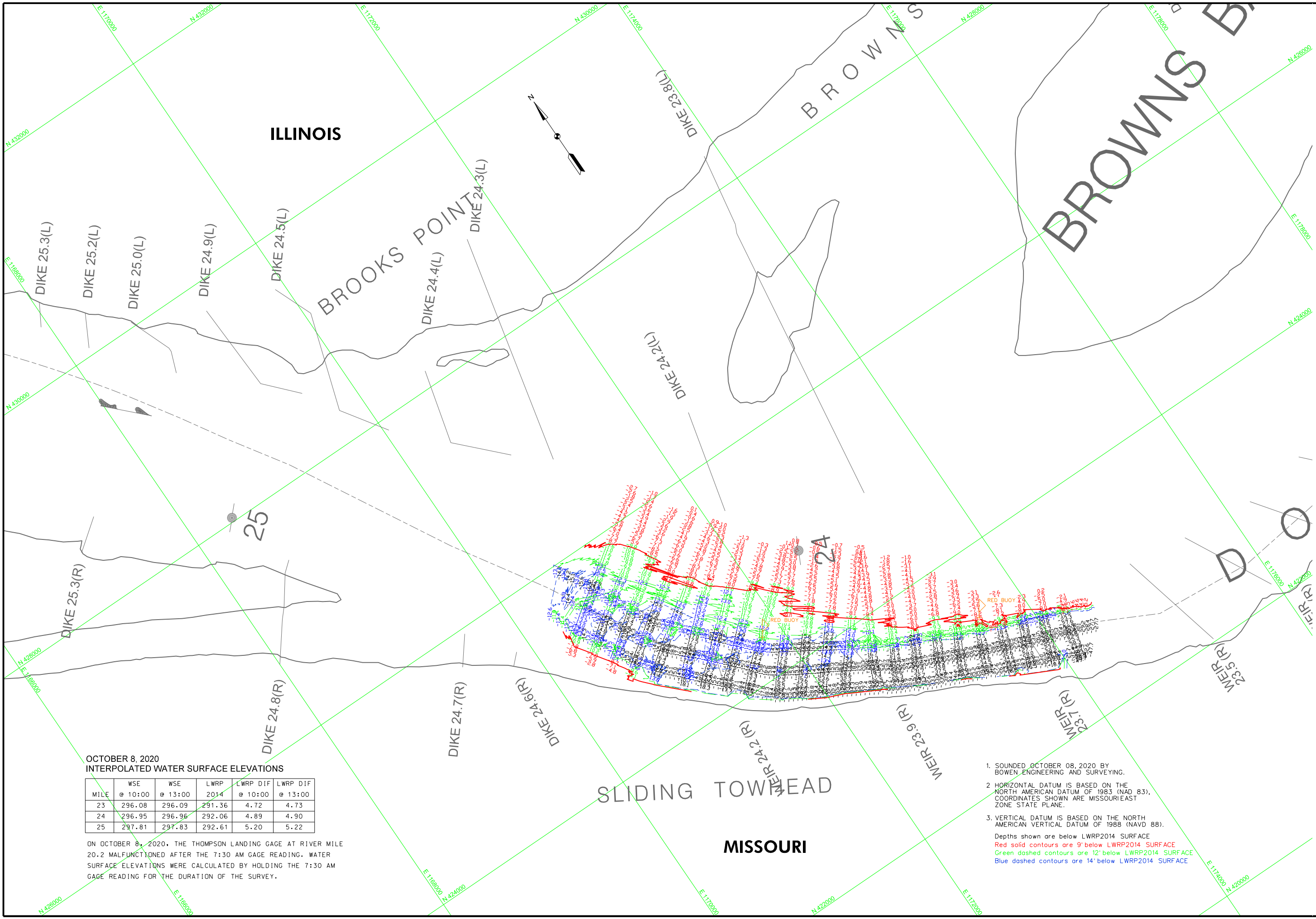

OCTOBER 8, 2020
INTERPOLATED WATER SURFACE ELEVATIONS

MILE	WSE @ 10:00	WSE @ 13:00	LWRP 2014	LWRP DIF @ 10:00	LWRP DIF @ 13:00
23	296.08	296.09	291.36	4.72	4.73
24	296.95	296.96	292.06	4.89	4.90
25	297.81	297.83	292.61	5.20	5.22

ON OCTOBER 8, 2020, THE THOMPSON LANDING GAGE AT RIVER MILE 20.2 MALFUNCTIONED AFTER THE 7:30 AM GAGE READING. WATER SURFACE ELEVATIONS WERE CALCULATED BY HOLDING THE 7:30 AM GAGE READING FOR THE DURATION OF THE SURVEY.

1. SOUNDED OCTOBER 08, 2020 BY BOWEN ENGINEERING AND SURVEYING.
2. HORIZONTAL DATUM IS BASED ON THE NORTH AMERICAN DATUM OF 1983 (NAD 83). COORDINATES SHOWN ARE MISSOURI EAST ZONE STATE PLANE.
3. VERTICAL DATUM IS BASED ON THE NORTH AMERICAN VERTICAL DATUM OF 1988 (NAVD 88).

Depths shown are below LWRP2014 SURFACE
Red solid contours are 9' below LWRP2014 SURFACE
Green dashed contours are 12' below LWRP2014 SURFACE
Blue dashed contours are 14' below LWRP2014 SURFACE