

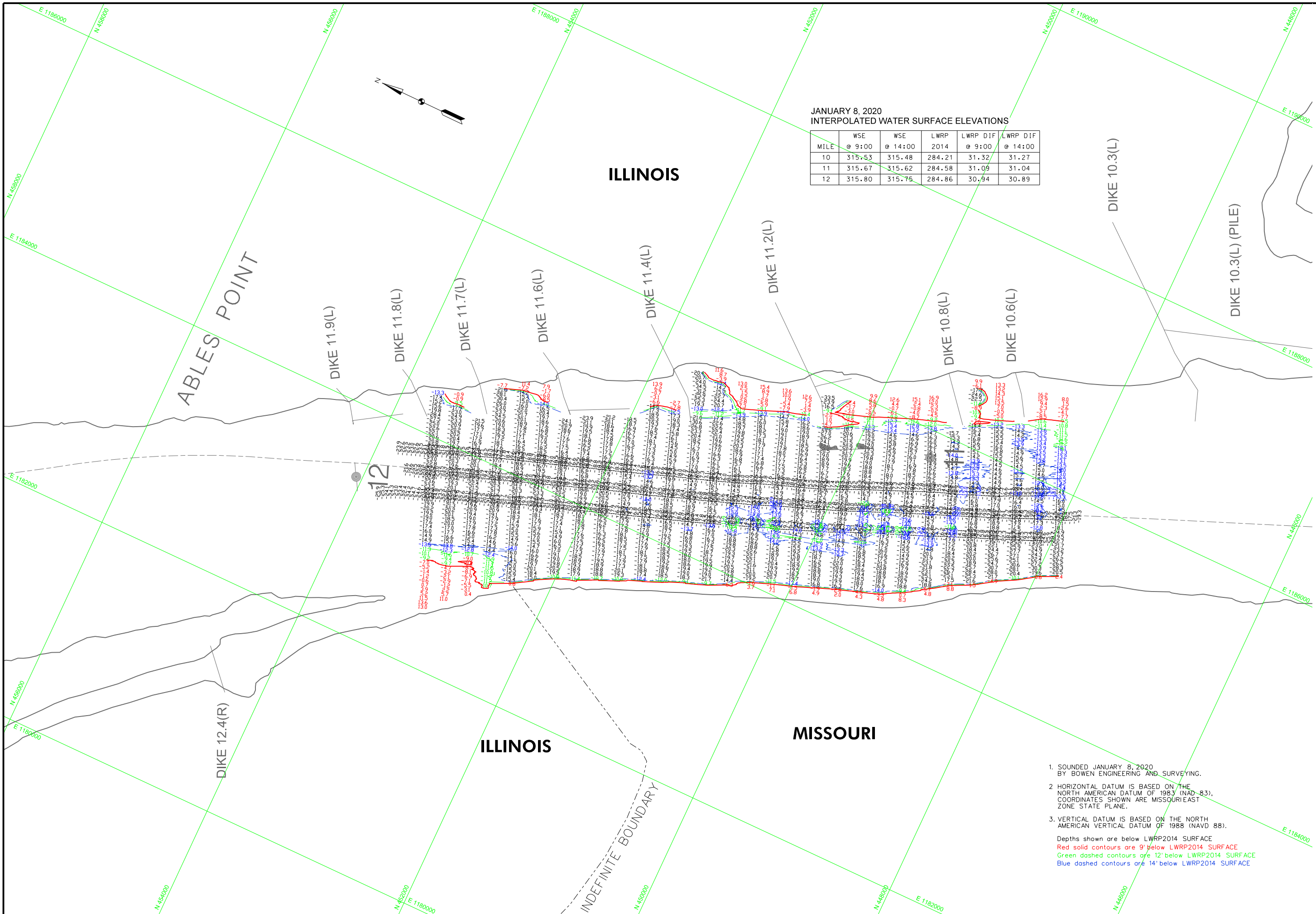

US Army Corps of Engineers
St. Louis District

JANUARY 8, 2020
INTERPOLATED WATER SURFACE ELEVATIONS

MILE	WSE	WSE	LWRP	LWRP DIF	LWRP DIF
	@ 9:00	@ 14:00	2014	@ 9:00	@ 14:00
10	315.53	315.48	284.21	31.32	31.27
11	315.67	315.62	284.58	31.09	31.04
12	315.80	315.75	284.86	30.94	30.89



COMMERCE NO	PREC'S. LANDING	THOMPSON LANDING	BIRDS POINT
10160	298.95	279.03	273.91
3015	28.2	20.2	2.0
3012	294.38	289.54	280.38
X	X	X	X
		37.909(20) 37.834(10) 40.529(20) 60.841(30)	

Surveyed by:	Survey Date:	Reviewed by:
BOWEN ENGINEERING	JANUARY 8, 2020	
Drawn by:	Checked by:	Approved:
X	X	X
SUBMITTED:		
X		

U.S. ARMY ENGINEER DIVISION
CORPS OF ENGINEERS
ST. LOUIS, MISSOURI
UPPER MISSISSIPPI RIVER BASIN
MISSISSIPPI RIVER

170 0 100 240 METERS
400 0 400 800 FEET

THE INFORMATION DEPICTED ON THIS MAP REPRESENTS THE RESULTS OF A SURVEY CONDUCTED UNDER THE GENERAL CONDITIONS ESTABLISHED BY THE U.S. ARMY CORPS OF ENGINEERS.

PRE DREDGE SURVEY
RIVER MILES 11.8 - 10.8

1. SOUNDED JANUARY 8, 2020 BY BOWEN ENGINEERING AND SURVEYING.
 2. HORIZONTAL DATUM IS BASED ON THE NORTH AMERICAN DATUM OF 1983 (NAD 83). COORDINATES SHOWN ARE MISSOURI EAST ZONE STATE PLANE.
 3. VERTICAL DATUM IS BASED ON THE NORTH AMERICAN VERTICAL DATUM OF 1988 (NAVD 88).
- Depths shown are below LWRP2014 SURFACE
 Red solid contours are 9' below LWRP2014 SURFACE
 Green dashed contours are 12' below LWRP2014 SURFACE
 Blue dashed contours are 14' below LWRP2014 SURFACE

PLATE NUMBER
XX