



US Army Corps of Engineers  
St. Louis District

GAGE RECORD		ST. LOUIS, MO
KASKASKIA (MI. LOWER)	CHESTER, IL	379.58
295.50	345.71	379.58
0.8 KASKASKIA RIVER	100.9	380.0
344.70	340.33	376.38
68.21(1000) 68.8(1000) 73.83(1000) 73.83(1000) 73.83(1000)	UNAVAILABLE	73.83(1000) 73.83(1000)
25 JUN 2020		

U.S. ARMY ENGINEER DIVISION CORPS OF ENGINEERS ST. LOUIS, MISSOURI	Survey Date: JUNE 25, 2020	Reviewed by:
Drawn by: X	Checked by: X	APPROVED: X
Submitted: X		
Plot date: File name:		

120 METERS  
0 60 120  
400 FEET  
0 200 400  
THE INFORMATION DEPICTED ON THIS MAP REPRESENTS THE RESULTS OF SURVEYING AND IS NOT TO BE USED FOR ANY OTHER PURPOSE WITHOUT THE EXPRESS WRITTEN PERMISSION OF THE DISTRICT ENGINEER.

PRE DREDGE SURVEY  
KASKASKIA RIVER MILES 0.8 - 0.0

PLATE NUMBER  
XX

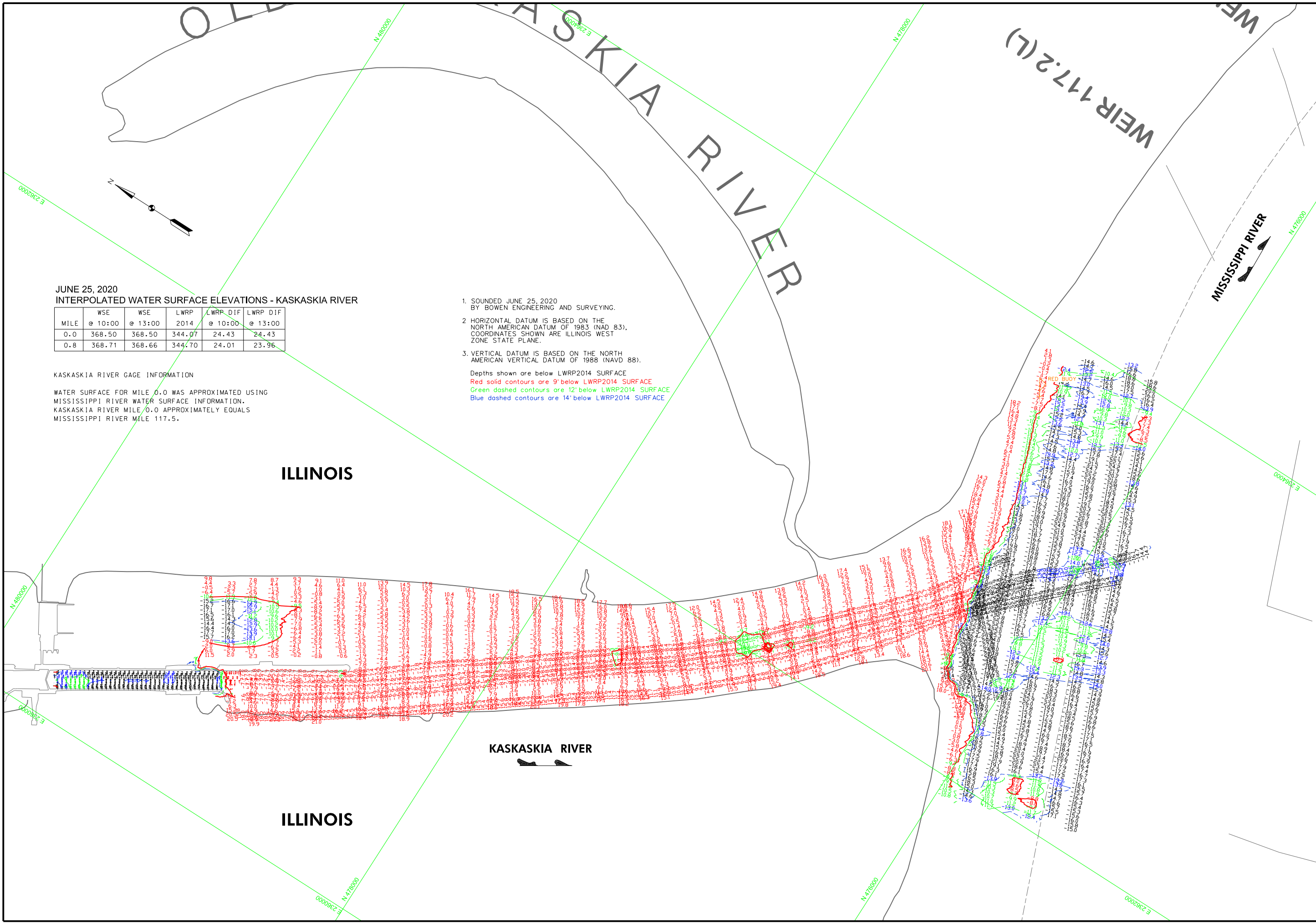

**JUNE 25, 2020  
INTERPOLATED WATER SURFACE ELEVATIONS - KASKASKIA RIVER**

MILE	WSE @ 10:00	WSE @ 13:00	LWRP 2014	LWRP DIF @ 10:00	LWRP DIF @ 13:00
0.0	368.50	368.50	344.07	24.43	24.43
0.8	368.71	368.66	344.70	24.01	23.96

**KASKASKIA RIVER GAGE INFORMATION**

WATER SURFACE FOR MILE 0.0 WAS APPROXIMATED USING MISSISSIPPI RIVER WATER SURFACE INFORMATION. KASKASKIA RIVER MILE 0.0 APPROXIMATELY EQUALS MISSISSIPPI RIVER MILE 117.5.

1. SOUNDED JUNE 25, 2020 BY BOWEN ENGINEERING AND SURVEYING.
2. HORIZONTAL DATUM IS BASED ON THE NORTH AMERICAN DATUM OF 1983 (NAD 83). COORDINATES SHOWN ARE ILLINOIS WEST ZONE STATE PLANE.
3. VERTICAL DATUM IS BASED ON THE NORTH AMERICAN VERTICAL DATUM OF 1988 (NAVD 88).

Depths shown are below LWRP2014 SURFACE  
 Red solid contours are 9' below LWRP2014 SURFACE  
 Green dashed contours are 12' below LWRP2014 SURFACE  
 Blue dashed contours are 14' below LWRP2014 SURFACE

ILLINOIS

ILLINOIS

KASKASKIA RIVER

WEIR 117.2(L)

MISSISSIPPI RIVER