



CASE RECORD		VALLEY CITY	
ZERO N.G.V.D. MILE	488.0	MEEDOSA	488.0
MIN POOL DATE	70.8		61.3
	490.0		489.0
	420.6 (10:00)		420.3 (10:00)
	420.6 (11:30)		420.3 (11:30)

Elevations are reported in NAD83. Contours are below 100 feet. MIN WATER REFERENCE PLANE: LAKE MISSOURI (1985) (7.5)

SUBMITTED:	
Chief, Engr. Data, Mgmt. Sect.	
File Name: 080620.mxd	
Plot Date: 8/27/2020	
Plot Scale: 1" = 200'	

APPROVED:	
Chief, Geospatial Branch	

U.S. ARMY ENGINEER DIVISION CORPS OF ENGINEERS ST. LOUIS, MISSOURI	
ILLINOIS RIVER BASIN	ILLINOIS RIVER

PRE DREDGE SURVEY	
RIVER MILES: 69.5 - 68.5	

PLATE NUMBER	
1	

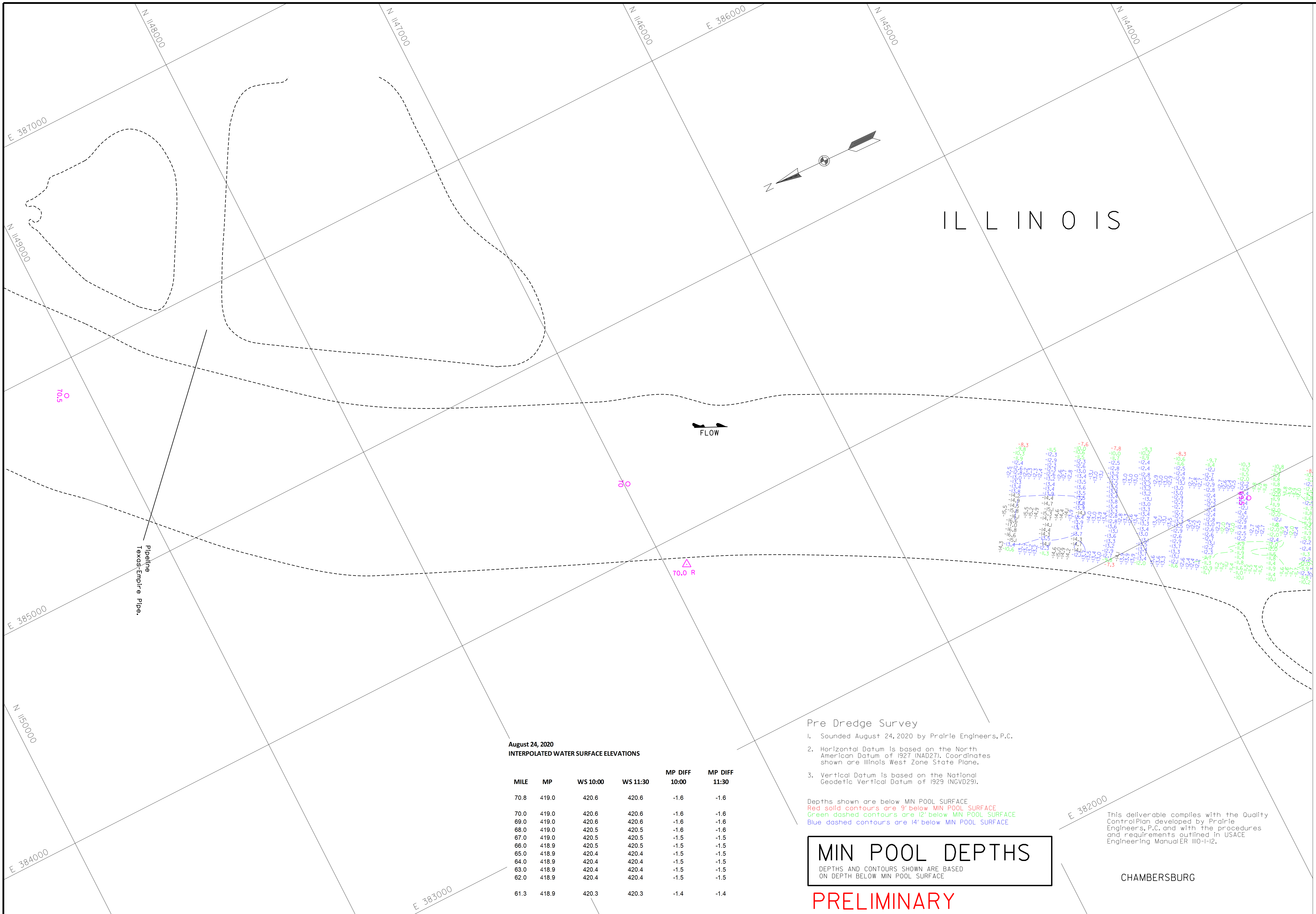

August 24, 2020
INTERPOLATED WATER SURFACE ELEVATIONS

MILE	MP	WS		MP DIFF	
		10:00	11:30	10:00	11:30
70.8	419.0	420.6	420.6	-1.6	-1.6
70.0	419.0	420.6	420.6	-1.6	-1.6
69.0	419.0	420.6	420.6	-1.6	-1.6
68.0	419.0	420.5	420.5	-1.6	-1.6
67.0	419.0	420.5	420.5	-1.5	-1.5
66.0	418.9	420.5	420.5	-1.5	-1.5
65.0	418.9	420.4	420.4	-1.5	-1.5
64.0	418.9	420.4	420.4	-1.5	-1.5
63.0	418.9	420.4	420.4	-1.5	-1.5
62.0	418.9	420.4	420.4	-1.5	-1.5
61.3	418.9	420.3	420.3	-1.4	-1.4

Pre Dredge Survey

- Sounded August 24, 2020 by Prairie Engineers, P.C.
- Horizontal Datum is based on the North American Datum of 1927 (NAD27). Coordinates shown are Illinois West Zone State Plane.
- Vertical Datum is based on the National Geodetic Vertical Datum of 1929 (NGVD29).

Depths shown are below MIN POOL SURFACE
 Red solid contours are 9' below MIN POOL SURFACE
 Green dashed contours are 12' below MIN POOL SURFACE
 Blue dashed contours are 14' below MIN POOL SURFACE

MIN POOL DEPTHS
 DEPTHS AND CONTOURS SHOWN ARE BASED
 ON DEPTH BELOW MIN POOL SURFACE

PRELIMINARY

CHAMBERSBURG

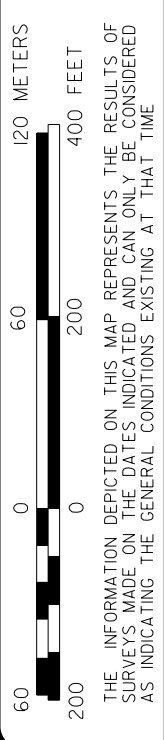



CASE RECORD		VALLEY CITY	
ZERO N.G.V.D.	MEEDOSA	418.0	48.0
MILE		70.8	61.3
MIN POOL		418.0	48.9
DATE		24 AUG 2020	24 AUG 2020
		420.6 (10:00)	420.3 (10:00)
		420.6 (11:30)	420.3 (11:30)

SUBMITTED:	
File Name:	068620.mxd
Plot Date:	8/27/2020
Plot Scale:	1" = 200'

APPROVED:	
Chief, Geospatial Branch	

U.S. ARMY ENGINEER DIVISION CORPS OF ENGINEERS ST. LOUIS, MISSOURI	
ILLINOIS RIVER BASIN	ILLINOIS RIVER

PRE DREDGE SURVEY RIVER MILES: 69.5 - 68.5	
---	--

PLATE NUMBER
2

August 24, 2020
INTERPOLATED WATER SURFACE ELEVATIONS

MILE	MP	WS 10:00	WS 11:30	MP DIFF 10:00	MP DIFF 11:30
70.8	419.0	420.6	420.6	-1.6	-1.6
70.0	419.0	420.6	420.6	-1.6	-1.6
69.0	419.0	420.6	420.6	-1.6	-1.6
68.0	419.0	420.5	420.5	-1.6	-1.6
67.0	419.0	420.5	420.5	-1.5	-1.5
66.0	418.9	420.5	420.5	-1.5	-1.5
65.0	418.9	420.4	420.4	-1.5	-1.5
64.0	418.9	420.4	420.4	-1.5	-1.5
63.0	418.9	420.4	420.4	-1.5	-1.5
62.0	418.9	420.4	420.4	-1.5	-1.5
61.3	418.9	420.3	420.3	-1.4	-1.4

ILLINOIS

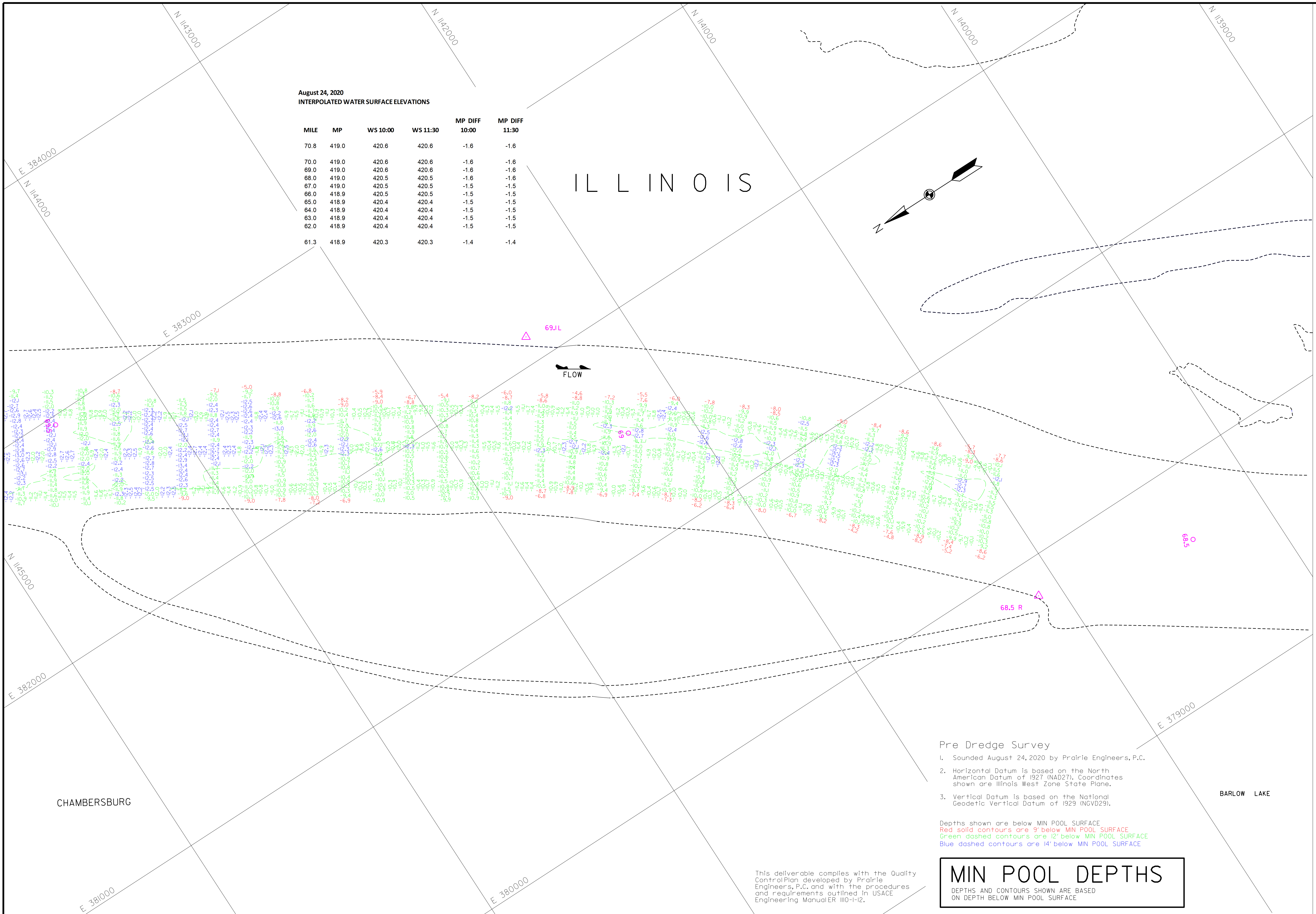
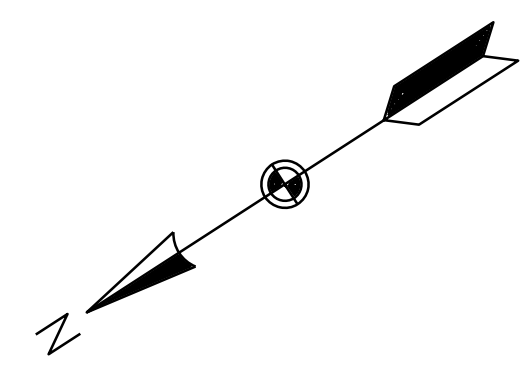

Pre Dredge Survey

- Sounded August 24, 2020 by Prairie Engineers, P.C.
- Horizontal Datum is based on the North American Datum of 1927 (NAD27). Coordinates shown are Illinois West Zone State Plane.
- Vertical Datum is based on the National Geodetic Vertical Datum of 1929 (NGVD29).

Depths shown are below MIN POOL SURFACE
 Red solid contours are 9' below MIN POOL SURFACE
 Green dashed contours are 12' below MIN POOL SURFACE
 Blue dashed contours are 14' below MIN POOL SURFACE

MIN POOL DEPTHS

DEPTHS AND CONTOURS SHOWN ARE BASED ON DEPTH BELOW MIN POOL SURFACE.

This deliverable complies with the Quality Control Plan developed by Prairie Engineers, P.C. and with the procedures and requirements outlined in USACE Engineering Manual 110-1-12.

