

CASE RECORD		VALLEY CITY	
WATER SURFACE	MEEDOSA	480.0	480.0
ZERO N.G.V.D.	480.0	70.8	61.3
MILE		490.0	489.9
MIN POOL		418.9 (10/45)	418.7 (10/45)
DATE		07 OCT 2020	05.07 105001
ELEVATIONS ARE REFERRED TO NAVAL DATUM UNLESS OTHERWISE NOTED		ELEVATIONS ARE REFERRED TO NAVAL DATUM UNLESS OTHERWISE NOTED	

SUBMITTED:	
Chief, Engr. Data, Mgmt. Sect.	File Name: 0620102.mxd
Chief, Engr. Data, Mgmt. Sect.	Plot Date: 10/9/2020
Chief, Engr. Data, Mgmt. Sect.	Plot Scale: 1" = 200'

SURVEYED BY:	
PRairie ENGINEERS	Chief, Geospatial Branch
Drawn by: PCE	Reviewed by:
Checked by: PCE	APPROVED:

U.S. ARMY ENGINEER DIVISION	
CORPS OF ENGINEERS	ILLINOIS RIVER BASIN
ST. LOUIS, MISSOURI	ILLINOIS RIVER

PRE DREDGE SURVEY	
RIVER MILES: 62.8 - 61.8	

PLATE NUMBER	
01	

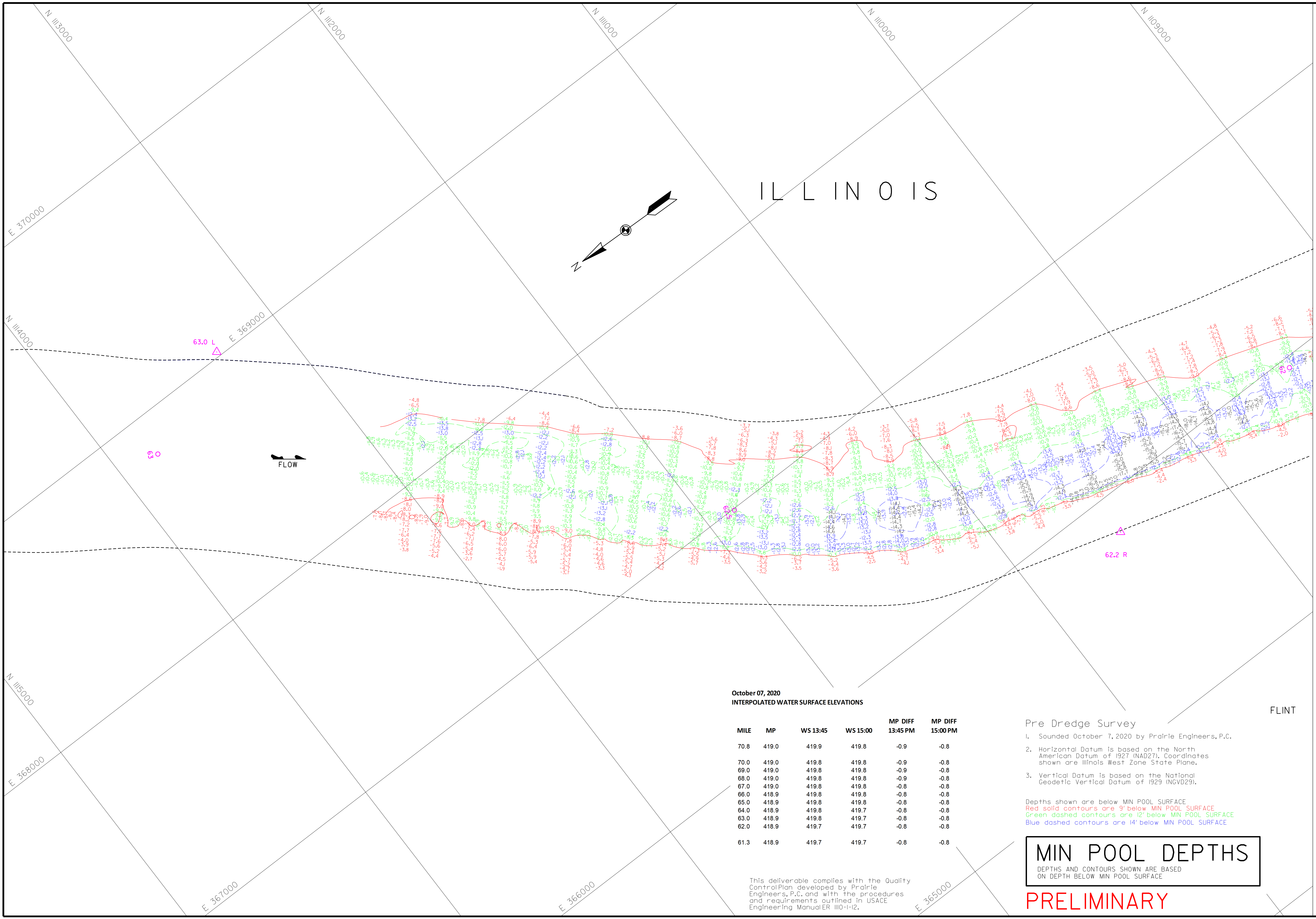

October 07, 2020  
INTERPOLATED WATER SURFACE ELEVATIONS

MILE	MP	WS 13:45	WS 15:00	MP DIFF 13:45 PM	MP DIFF 15:00 PM
70.8	419.0	419.9	419.8	-0.9	-0.8
70.0	419.0	419.8	419.8	-0.9	-0.8
69.0	419.0	419.8	419.8	-0.9	-0.8
68.0	419.0	419.8	419.8	-0.9	-0.8
67.0	419.0	419.8	419.8	-0.8	-0.8
66.0	418.9	419.8	419.8	-0.8	-0.8
65.0	418.9	419.8	419.8	-0.8	-0.8
64.0	418.9	419.8	419.7	-0.8	-0.8
63.0	418.9	419.8	419.7	-0.8	-0.8
62.0	418.9	419.7	419.7	-0.8	-0.8
61.3	418.9	419.7	419.7	-0.8	-0.8

Pre Dredge Survey

- Sounded October 7, 2020 by Prairie Engineers, P.C.
- Horizontal Datum is based on the North American Datum of 1927 (NAD27). Coordinates shown are Illinois West Zone State Plane.
- Vertical Datum is based on the National Geodetic Vertical Datum of 1929 (NGVD29).

Depths shown are below MIN POOL SURFACE  
 Red solid contours are 9' below MIN POOL SURFACE  
 Green dashed contours are 12' below MIN POOL SURFACE  
 Blue dashed contours are 14' below MIN POOL SURFACE

**MIN POOL DEPTHS**  
 DEPTHS AND CONTOURS SHOWN ARE BASED  
 ON DEPTH BELOW MIN POOL SURFACE

**PRELIMINARY**

This deliverable complies with the Quality Control Plan developed by Prairie Engineers, P.C. and with the procedures and requirements outlined in USACE Engineering Manual ER 1110-1-12.

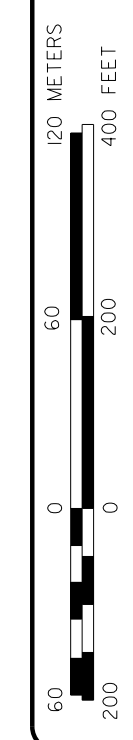

FLINT

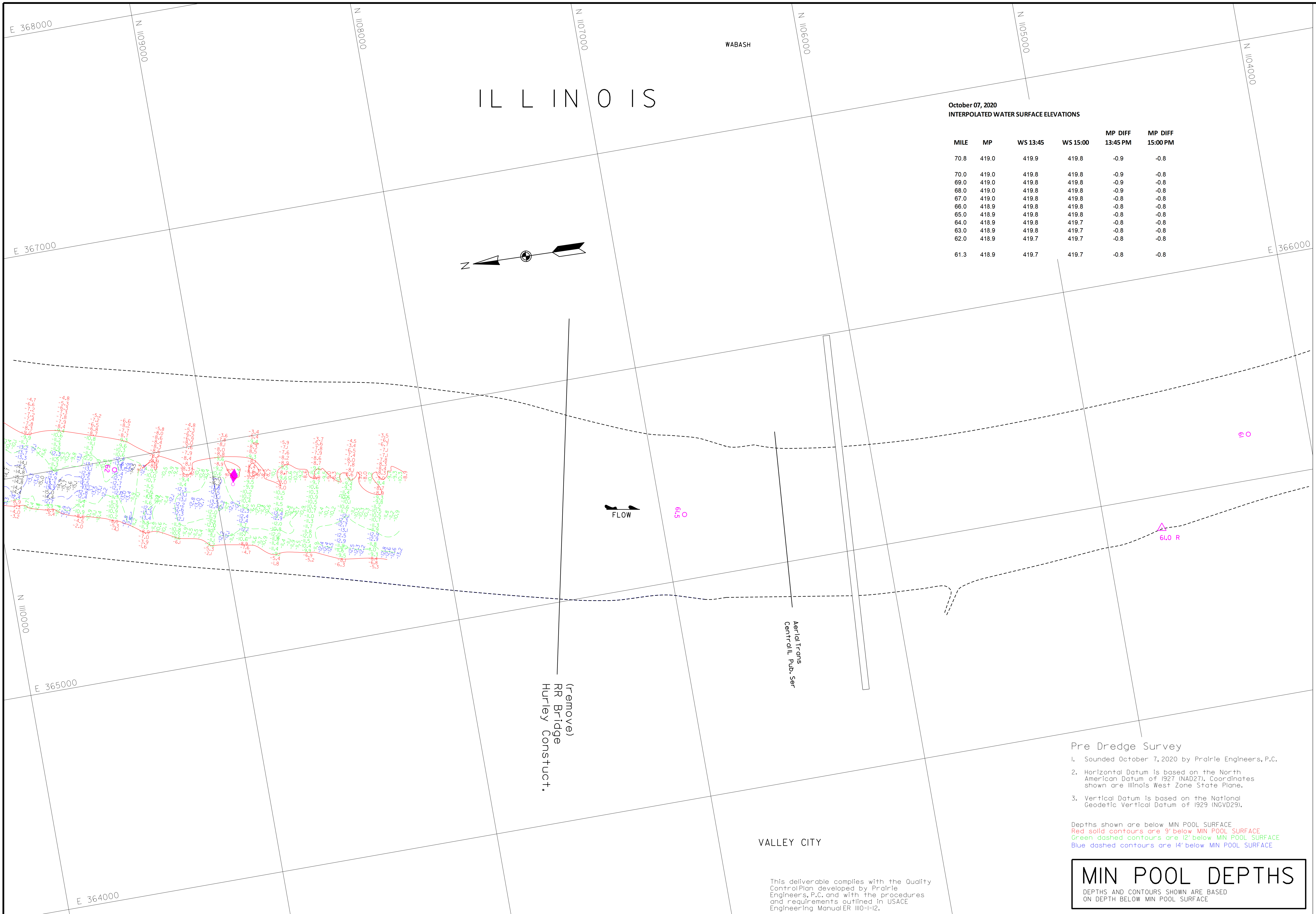

October 07, 2020  
INTERPOLATED WATER SURFACE ELEVATIONS

MILE	MP	WS 13:45	WS 15:00	MP DIFF 13:45 PM	MP DIFF 15:00 PM
70.8	419.0	419.9	419.8	-0.9	-0.8
70.0	419.0	419.8	419.8	-0.9	-0.8
69.0	419.0	419.8	419.8	-0.9	-0.8
68.0	419.0	419.8	419.8	-0.9	-0.8
67.0	419.0	419.8	419.8	-0.8	-0.8
66.0	418.9	419.8	419.8	-0.8	-0.8
65.0	418.9	419.8	419.8	-0.8	-0.8
64.0	418.9	419.8	419.7	-0.8	-0.8
63.0	418.9	419.8	419.7	-0.8	-0.8
62.0	418.9	419.7	419.7	-0.8	-0.8
61.3	418.9	419.7	419.7	-0.8	-0.8

GAGE RECORD

WATER SURFACE	VALLEY CITY
ZERO N.G.V.D.	480
MILE	61.3
MIN POOL	483
DATE	07 OCT 2020

GAUGE RECORD

MEREDOSA	VALLEY CITY
418.0	480
70.8	61.3
419.0	483
418.9 (18:45)	487 (18:45)
419.8 (15:00)	487 (15:00)

ELEVATIONS ARE REFERRED TO NAD83. CONTOURS ARE BELOW MP(S). FOR WATER REFERENCE PLANE, MP(S) IS 483.0.

Survey Date: October 7, 2020  
SUBMITTED:  
Chief, Engr. Data, Mgmt. Sect.  
File Name: 062020.mpr0220g  
Plot Date: 10/9/2020  
Plot Scale: 1" = 200'

Surveyed by:  
PRAIRIE ENGINEERS  
Drawn by: PCE by:  
JUB  
Reviewed by:  
APPROVED:  
Chief, Geospatial Branch

U.S. ARMY ENGINEER DIVISION  
CORPS OF ENGINEERS  
ST. LOUIS, MISSOURI  
ILLINOIS RIVER BASIN  
ILLINOIS RIVER

PRE DREDGE SURVEY  
RIVER MILES: 62.8 - 61.8

PLATE NUMBER  
02

- Pre Dredge Survey
- Sounded October 7, 2020 by Prairie Engineers, P.C.
  - Horizontal Datum is based on the North American Datum of 1927 (NAD27). Coordinates shown are Illinois West Zone State Plane.
  - Vertical Datum is based on the National Geodetic Vertical Datum of 1929 (NGVD29).

Depths shown are below MIN POOL SURFACE  
Red solid contours are 9' below MIN POOL SURFACE  
Green dashed contours are 12' below MIN POOL SURFACE  
Blue dashed contours are 14' below MIN POOL SURFACE

## MIN POOL DEPTHS

DEPTHS AND CONTOURS SHOWN ARE BASED ON DEPTH BELOW MIN POOL SURFACE

This deliverable complies with the Quality Control Plan developed by Prairie Engineers, P.C. and with the procedures and requirements outlined in USACE Engineering Manual ER 110-1-12.