



GAGE RECORD		VALLEY CITY	
WATER SURFACE	MEEDOSA	488.0	480.0
ZERO N.G.V.D.		70.8	61.3
MILE		419.0	418.9
MIN POOL		420.6 (8/20)	420.3 (8/20)
DATE		420.6 (8/20)	420.3 (8/20)

SURVEY DATA		SUBMITTED	
Survey Date:	August 24, 2020	Submitted By:	Chief, Engr. Data Mgmt. Sect.
Drawn By:	PCE by: JAW	Reviewed By:	Chief, Geospatial Branch
Approved:		Plot Date:	8/26/2020
		Plot Scale:	1" = 200'

U.S. ARMY ENGINEER DIVISION
CORPS OF ENGINEERS
ST. LOUIS, MISSOURI

ILLINOIS RIVER BASIN
ILLINOIS RIVER

PRE DREDGE SURVEY
RIVER MILES 63.5 - 61.5

PLATE NUMBER
01

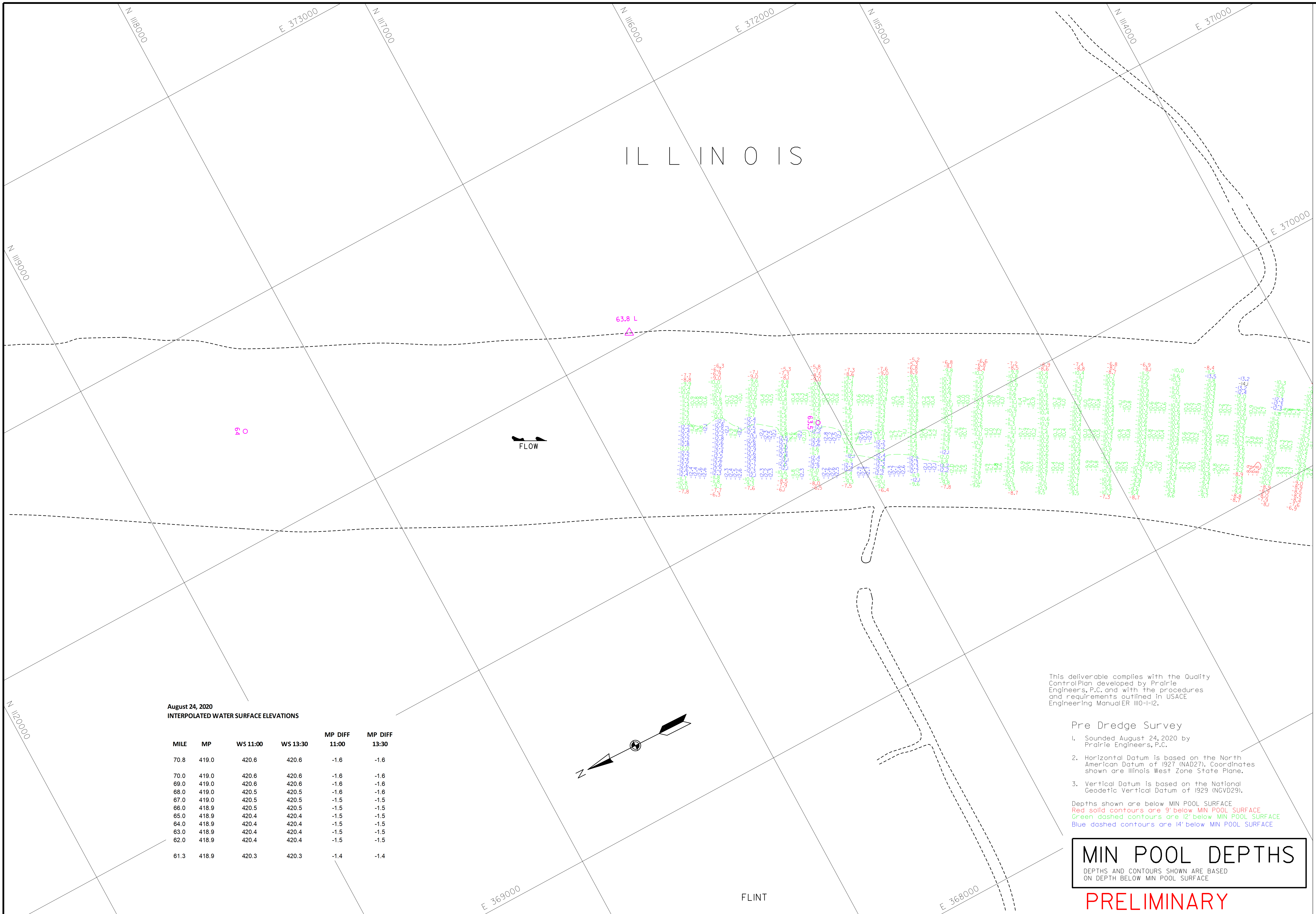

August 24, 2020
INTERPOLATED WATER SURFACE ELEVATIONS

MILE	MP	WS 11:00	WS 13:30	MP DIFF 11:00	MP DIFF 13:30
70.8	419.0	420.6	420.6	-1.6	-1.6
70.0	419.0	420.6	420.6	-1.6	-1.6
69.0	419.0	420.6	420.6	-1.6	-1.6
68.0	419.0	420.5	420.5	-1.6	-1.6
67.0	419.0	420.5	420.5	-1.5	-1.5
66.0	418.9	420.5	420.5	-1.5	-1.5
65.0	418.9	420.4	420.4	-1.5	-1.5
64.0	418.9	420.4	420.4	-1.5	-1.5
63.0	418.9	420.4	420.4	-1.5	-1.5
62.0	418.9	420.4	420.4	-1.5	-1.5
61.3	418.9	420.3	420.3	-1.4	-1.4

This deliverable complies with the Quality Control Plan developed by Prairie Engineers, P.C. and with the procedures and requirements outlined in USACE Engineering Manual ER 110-1-12.

Pre Dredge Survey

- Sounded August 24, 2020 by Prairie Engineers, P.C.
- Horizontal Datum is based on the North American Datum of 1927 (NAD27), Coordinates shown are Illinois West Zone State Plane.
- Vertical Datum is based on the National Geodetic Vertical Datum of 1929 (NGVD29).

Depths shown are below MIN POOL SURFACE
Red solid contours are 9' below MIN POOL SURFACE
Green dashed contours are 12' below MIN POOL SURFACE
Blue dashed contours are 14' below MIN POOL SURFACE

MIN POOL DEPTHS
DEPTHS AND CONTOURS SHOWN ARE BASED ON DEPTH BELOW MIN POOL SURFACE

PRELIMINARY

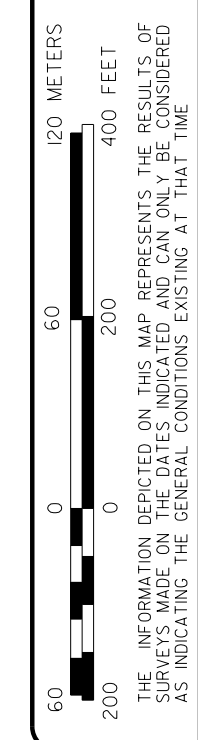



GAGE RECORD		VALLEY CITY
ZERO N.G.V.D.	MEEDOSA	480.0
MILE		61.3
MIN POOL		48.9
DATE		24 AUG 2020
		420.6 (1800)
		420.3 (1530)
ELEVATIONS ARE REFERRED TO NAVAL DATUMS AND BELOW 1000 FT. FOR WATER REFERENCE PLANE LAKE/POUND/SLU		

Survey Date: August 24, 2020
SUBMITTED:
Chief, Engr. Data. Mgmt. Sect.
File Name: 080200.mxd
Plot Date: 8/26/2020
Plot Scale: 1" = 200'

Surveyed by: PRAIRIE ENGINEERS	Drawn by: PCE	Reviewed by:	APPROVED:
	JLM		Chief, Geospatial Branch

U.S. ARMY ENGINEER DIVISION CORPS OF ENGINEERS ST. LOUIS, MISSOURI	ILLINOIS RIVER BASIN ILLINOIS RIVER
--	--

60 METERS 200 FEET 400 FEET	PRE DREDGE SURVEY RIVER MILES 63.5 - 61.5
-----------------------------------	--

PLATE NUMBER 02

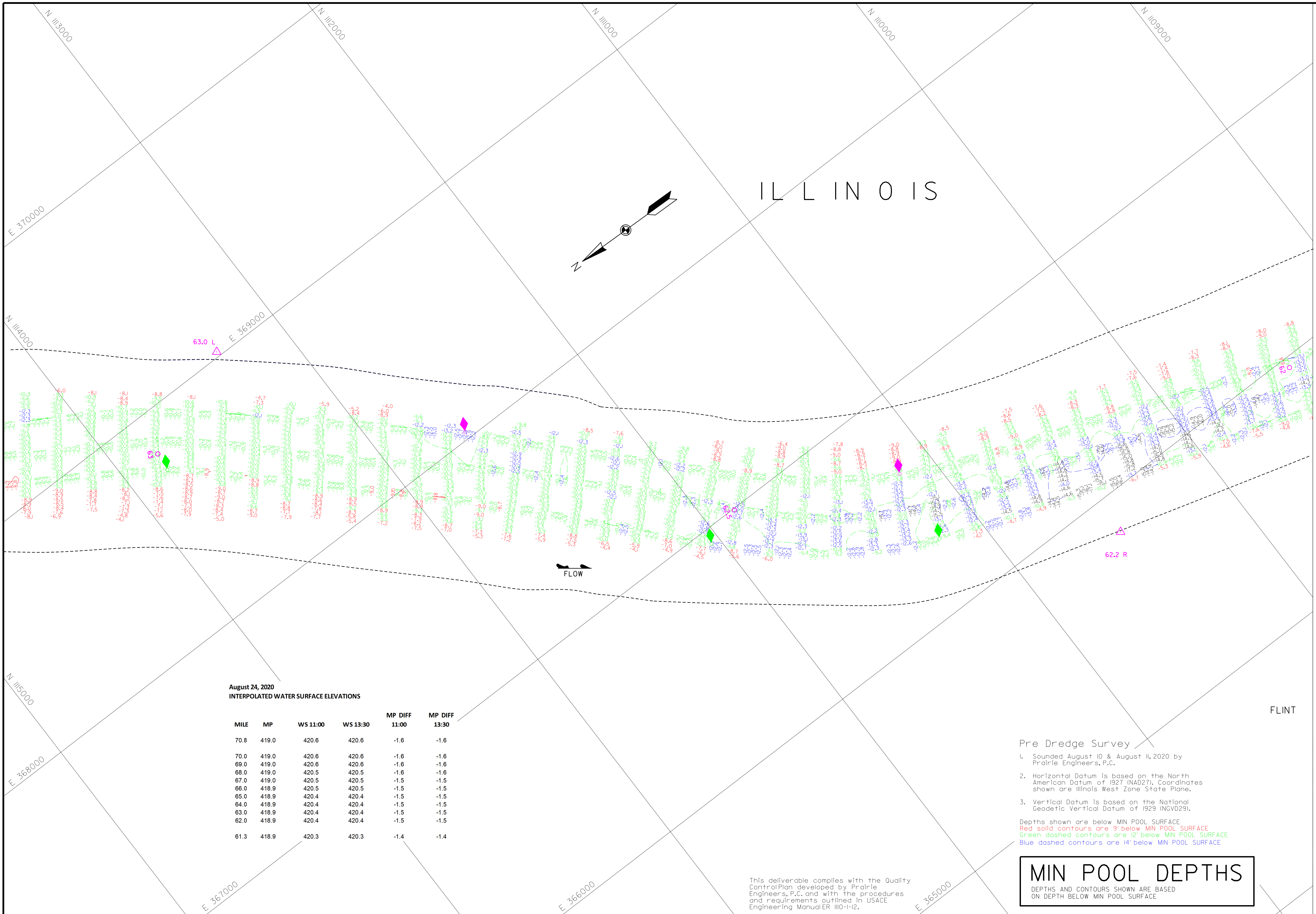

August 24, 2020
INTERPOLATED WATER SURFACE ELEVATIONS

MILE	MP	WS 11:00	WS 13:30	MP DIFF 11:00	MP DIFF 13:30
70.8	419.0	420.6	420.6	-1.6	-1.6
70.0	419.0	420.6	420.6	-1.6	-1.6
69.0	419.0	420.6	420.6	-1.6	-1.6
68.0	419.0	420.5	420.5	-1.6	-1.6
67.0	419.0	420.5	420.5	-1.5	-1.5
66.0	418.9	420.5	420.5	-1.5	-1.5
65.0	418.9	420.4	420.4	-1.5	-1.5
64.0	418.9	420.4	420.4	-1.5	-1.5
63.0	418.9	420.4	420.4	-1.5	-1.5
62.0	418.9	420.4	420.4	-1.5	-1.5
61.3	418.9	420.3	420.3	-1.4	-1.4

Pre Dredge Survey

- Sounded August 10 & August 11, 2020 by Prairie Engineers, P.C.
- Horizontal Datum is based on the North American Datum of 1927 (NAD27). Coordinates shown are Illinois West Zone State Plane.
- Vertical Datum is based on the National Geodetic Vertical Datum of 1929 (NGVD29).

Depths shown are below MIN POOL SURFACE
 Red solid contours are 9' below MIN POOL SURFACE
 Green dashed contours are 12' below MIN POOL SURFACE
 Blue dashed contours are 14' below MIN POOL SURFACE

MIN POOL DEPTHS
 DEPTHS AND CONTOURS SHOWN ARE BASED ON DEPTH BELOW MIN POOL SURFACE

This deliverable complies with the Quality Control Plan developed by Prairie Engineers, P.C. and with the procedures and requirements outlined in USACE Engineering Manual ER 1110-1-12.

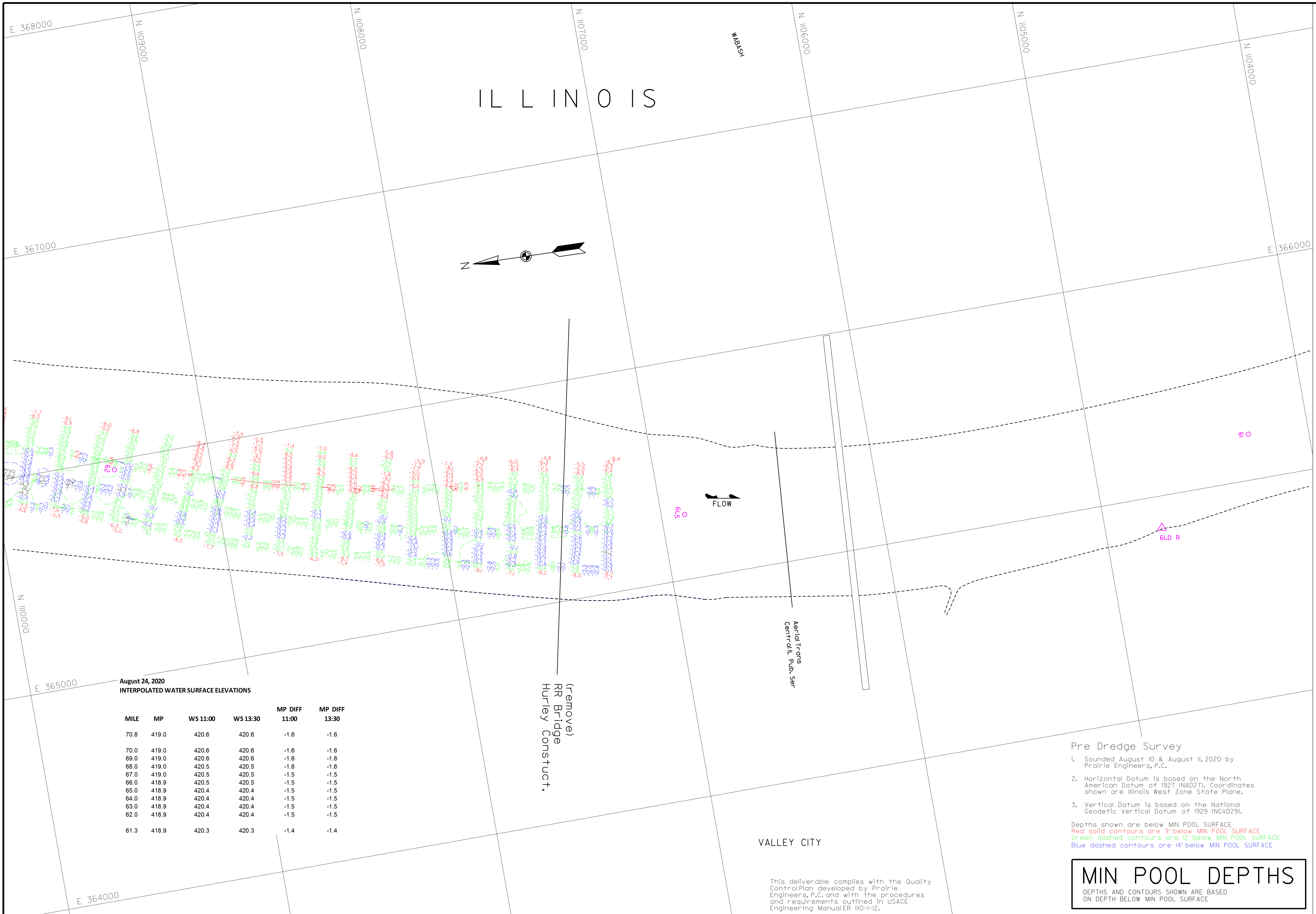

August 24, 2020
INTERPOLATED WATER SURFACE ELEVATIONS

MILE	MP	WS 11:00	WS 13:30	MP DIFF 11:00	MP DIFF 13:30
70.8	419.0	420.6	420.6	-1.6	-1.6
70.0	419.0	420.6	420.6	-1.6	-1.6
69.0	419.0	420.6	420.6	-1.6	-1.6
68.0	419.0	420.5	420.5	-1.6	-1.6
67.0	419.0	420.5	420.5	-1.5	-1.5
66.0	418.9	420.5	420.5	-1.5	-1.5
65.0	418.9	420.4	420.4	-1.5	-1.5
64.0	418.9	420.4	420.4	-1.5	-1.5
63.0	418.9	420.4	420.4	-1.5	-1.5
62.0	418.9	420.4	420.4	-1.5	-1.5
61.3	418.9	420.3	420.3	-1.4	-1.4

- Pre Dredge Survey
- Sounded August 10 & August 11, 2020 by Prairie Engineers, P.C.
 - Horizontal Datum is based on the North American Datum of 1927 (NAD27). Coordinates shown are Illinois West Zone State Plane.
 - Vertical Datum is based on the National Geodetic Vertical Datum of 1929 (NGVD29).

Depths shown are below MIN POOL SURFACE
 Red solid contours are 9' below MIN POOL SURFACE
 Green dashed contours are 12' below MIN POOL SURFACE
 Blue dashed contours are 14' below MIN POOL SURFACE

This deliverable complies with the Quality Control Plan developed by Prairie Engineers, P.C. and with the procedures and requirements outlined in USACE Engineering Manual ER 110-1-12.

MIN POOL DEPTHS

DEPTHS AND CONTOURS SHOWN ARE BASED ON DEPTH BELOW MIN POOL SURFACE

GAGE RECORD

ZERO N.G.V.D. MILE	WATER SURFACE	MEREDUSA	VALLEY CITY
		418.0	48.0
		70.8	61.3
		419.0	48.9
		420.6 (1850)	420.3 (1850)
		420.6 (1930)	420.3 (1930)

Elevations are reported in N.G.V.D. Contours are below 1850.5. Water reference plane is 1850.5.

Survey Date: August 24, 2020
 SUBMITTED:
 Chief, Engr. Data, Mgmt. Sect.
 File Name: 08e260.mxd
 Plot Date: 8/26/2020
 Plot Scale: 1" = 200'

Surveyed by: PRAIRIE ENGINEERS
 Drawn by: JAW
 Reviewed by: JAW
 APPROVED:
 Chief, Geospatial Branch

U.S. ARMY ENGINEER DIVISION
 CORPS OF ENGINEERS
 ST. LOUIS, MISSOURI
 ILLINOIS RIVER BASIN
 ILLINOIS RIVER

PRE DREDGE SURVEY
 RIVER MILES 63.5 - 61.5

PLATE NUMBER
 03