



ZERO N.G.V.D. MILE	WATER SURFACE	FLORENCE	PEARL
56.0	418.8	421.2	400.0
55.0	418.7	421.0	432.0
48.4	419.8	419.8	464.0
DATE	26 AUG 2020	421.2 (10:00)	418.7 (10:00)
ELEVATIONS ARE REFERRED TO NAVD83. CONTOURS ARE BELOW MIN POOL SURFACE. WATER REFERENCE PLANE: LAKE/PEARL/56.0			

Survey Date: August 26, 2020
 SUBMITTED:
 Chief, Engr. Data Mgmt. Sect.
 File Name: 0594620.ms.dwg
 Plot Date: 8/27/2020
 Plot Scale: 1" = 200'

Supervised by:
 PRAIRIE ENGINEERS
 Drawn by: PCE
 Checked by: JBF
 Reviewed by:
 APPROVED:
 Chief, Geospatial Branch

U.S. ARMY ENGINEER DIVISION
 CORPS OF ENGINEERS
 ST. LOUIS, MISSOURI
 ILLINOIS RIVER BASIN
 ILLINOIS RIVER

PRE DREDGE SURVEY
 RIVER MILES: 55.8 - 55.3

PLATE NUMBER
 1

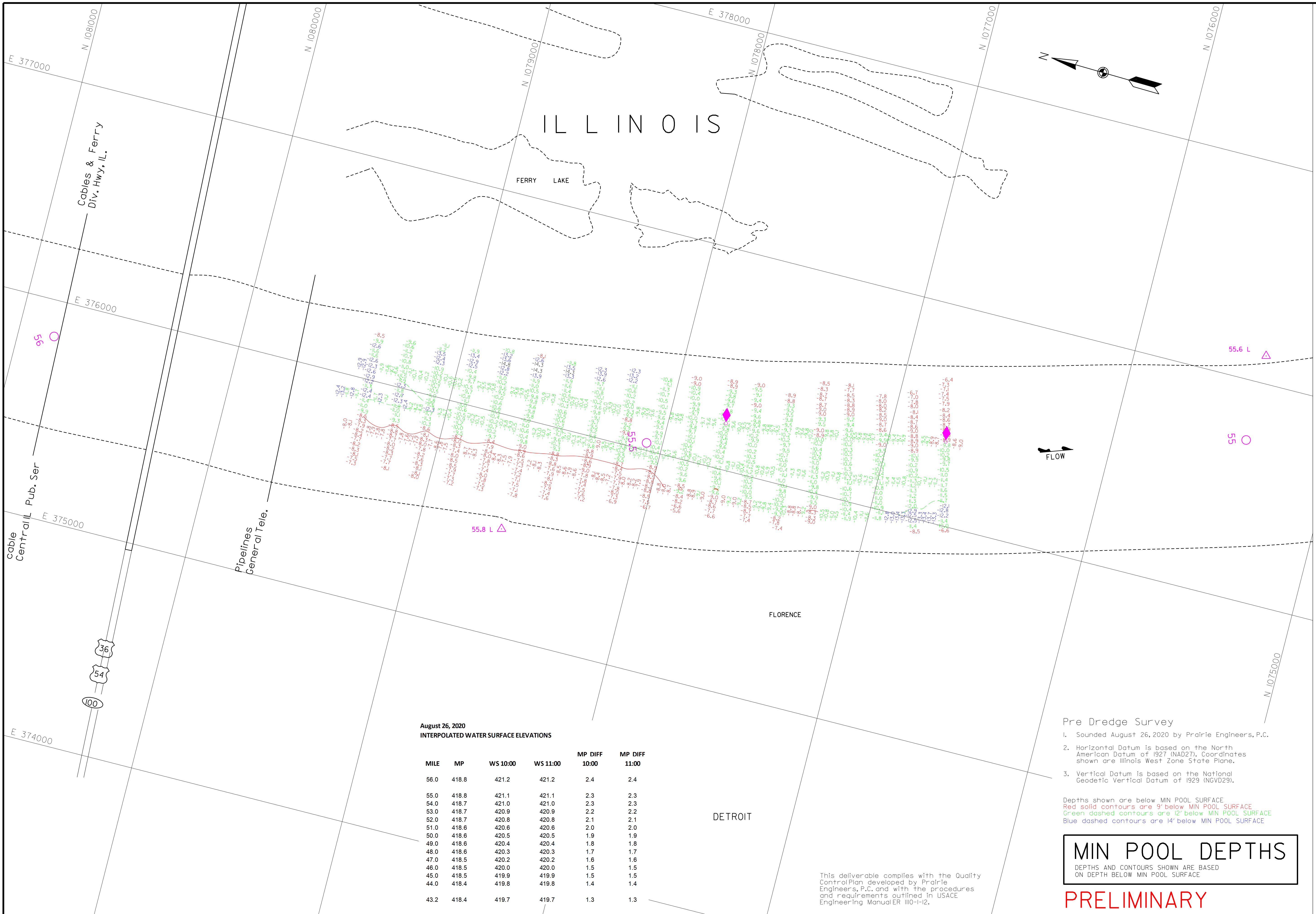

- Pre Dredge Survey
- Sounded August 26, 2020 by Prairie Engineers, P.C.
 - Horizontal Datum is based on the North American Datum of 1927 (NAD27). Coordinates shown are Illinois West Zone State Plane.
 - Vertical Datum is based on the National Geodetic Vertical Datum of 1929 (NGVD29).

Depths shown are below MIN POOL SURFACE
 Red solid contours are 9' below MIN POOL SURFACE
 Green dashed contours are 12' below MIN POOL SURFACE
 Blue dashed contours are 14' below MIN POOL SURFACE

MIN POOL DEPTHS
 DEPTHS AND CONTOURS SHOWN ARE BASED ON DEPTH BELOW MIN POOL SURFACE

PRELIMINARY

This deliverable complies with the Quality Control Plan developed by Prairie Engineers, P.C. and with the procedures and requirements outlined in USACE Engineering Manual 110-1-12.

