

CASE RECORD	
WATER SURFACE	PEARL
ZERO N.G.V.D.	400.0
MILE	43.2
MIN. POOL	48.4
DATE	19 AUG 2020
	48.7 (09:00)
	49.1 (13:00)
	49.3 (13:00)
ELEVATIONS ARE REFERRED TO NAZD - CONTOURS ARE BELOW 100'S FOR WATER REFERENCE PLANE (WATER) (ELEV. 42.5)	

SURVEY DATES August 19, 2020	
SUBMITTED:	Chief, Engr. Data, Mgmt. Sect.
FILE NAME:	0394920.sp.mxd
DATE:	8/19/2020
SCALE:	1" = 200'

SURVEYED BY: PRAIRIE ENGINEERS	
Drawn by:	BJB
Checked by:	BJB
Reviewed by:	
APPROVED:	Chief, Geospatial Branch

U.S. ARMY ENGINEER DIVISION  
CORPS OF ENGINEERS  
ST. LOUIS, MISSOURI

ILLINOIS RIVER BASIN  
ILLINOIS RIVER

60 0 60 200 400 METERS

THE INFORMATION DEPICTED ON THIS MAP REPRESENTS THE RESULTS OF A SURVEY CONDUCTED UNDER THE GENERAL CONDITIONS EXISTING AT THAT TIME.

PPE DREDGE SURVEY  
RIVER MILES 37.5 - 35.0

PLATE NUMBER  
01

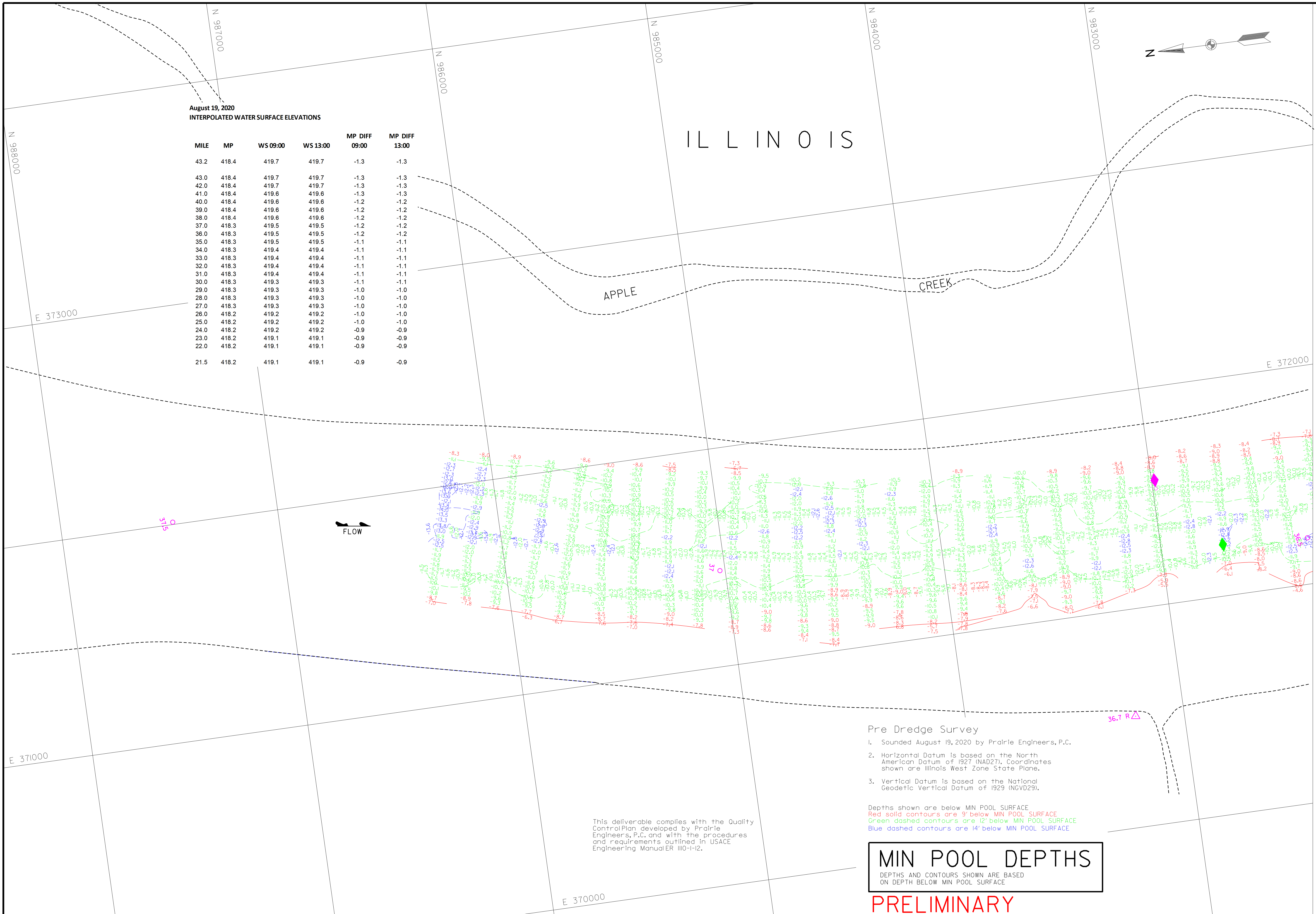

This deliverable complies with the Quality Control Plan developed by Prairie Engineers, P.C. and with the procedures and requirements outlined in USACE Engineering Manual ER 1110-1-12.

- Pre Dredge Survey**
- Sounded August 19, 2020 by Prairie Engineers, P.C.
  - Horizontal Datum is based on the North American Datum of 1927 (NAD27). Coordinates shown are Illinois West Zone State Plane.
  - Vertical Datum is based on the National Geodetic Vertical Datum of 1929 (NGVD29).

Depths shown are below MIN POOL SURFACE  
 Red solid contours are 9' below MIN POOL SURFACE  
 Green dashed contours are 12' below MIN POOL SURFACE  
 Blue dashed contours are 14' below MIN POOL SURFACE

- Pre Dredge Survey
- Sounded August 19, 2020 by Prairie Engineers, P.C.
  - Horizontal Datum is based on the North American Datum of 1927 (NAD27). Coordinates shown are Illinois West Zone State Plane.
  - Vertical Datum is based on the National Geodetic Vertical Datum of 1929 (NGVD29).

Depths shown are below MIN POOL SURFACE  
 Red solid contours are 9' below MIN POOL SURFACE  
 Green dashed contours are 12' below MIN POOL SURFACE  
 Blue dashed contours are 14' below MIN POOL SURFACE

**MIN POOL DEPTHS**  
 DEPTHS AND CONTOURS SHOWN ARE BASED ON DEPTH BELOW MIN POOL SURFACE

August 19, 2020  
 INTERPOLATED WATER SURFACE ELEVATIONS

MILE	MP	WS 09:00	WS 13:00	MP DIFF 09:00	MP DIFF 13:00
43.2	418.4	419.7	419.7	-1.3	-1.3
43.0	418.4	419.7	419.7	-1.3	-1.3
42.0	418.4	419.7	419.7	-1.3	-1.3
41.0	418.4	419.6	419.6	-1.3	-1.3
40.0	418.4	419.6	419.6	-1.2	-1.2
39.0	418.4	419.6	419.6	-1.2	-1.2
38.0	418.4	419.6	419.6	-1.2	-1.2
37.0	418.3	419.5	419.5	-1.2	-1.2
36.0	418.3	419.5	419.5	-1.2	-1.2
35.0	418.3	419.5	419.5	-1.1	-1.1
34.0	418.3	419.4	419.4	-1.1	-1.1
33.0	418.3	419.4	419.4	-1.1	-1.1
32.0	418.3	419.4	419.4	-1.1	-1.1
31.0	418.3	419.4	419.4	-1.1	-1.1
30.0	418.3	419.3	419.3	-1.1	-1.1
29.0	418.3	419.3	419.3	-1.0	-1.0
28.0	418.3	419.3	419.3	-1.0	-1.0
27.0	418.3	419.3	419.3	-1.0	-1.0
26.0	418.2	419.2	419.2	-1.0	-1.0
25.0	418.2	419.2	419.2	-1.0	-1.0
24.0	418.2	419.2	419.2	-0.9	-0.9
23.0	418.2	419.1	419.1	-0.9	-0.9
22.0	418.2	419.1	419.1	-0.9	-0.9
21.5	418.2	419.1	419.1	-0.9	-0.9

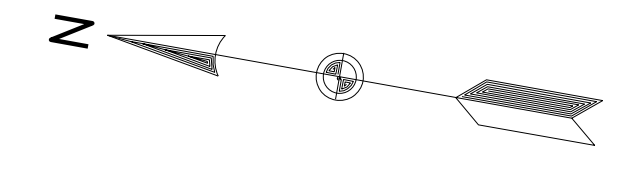
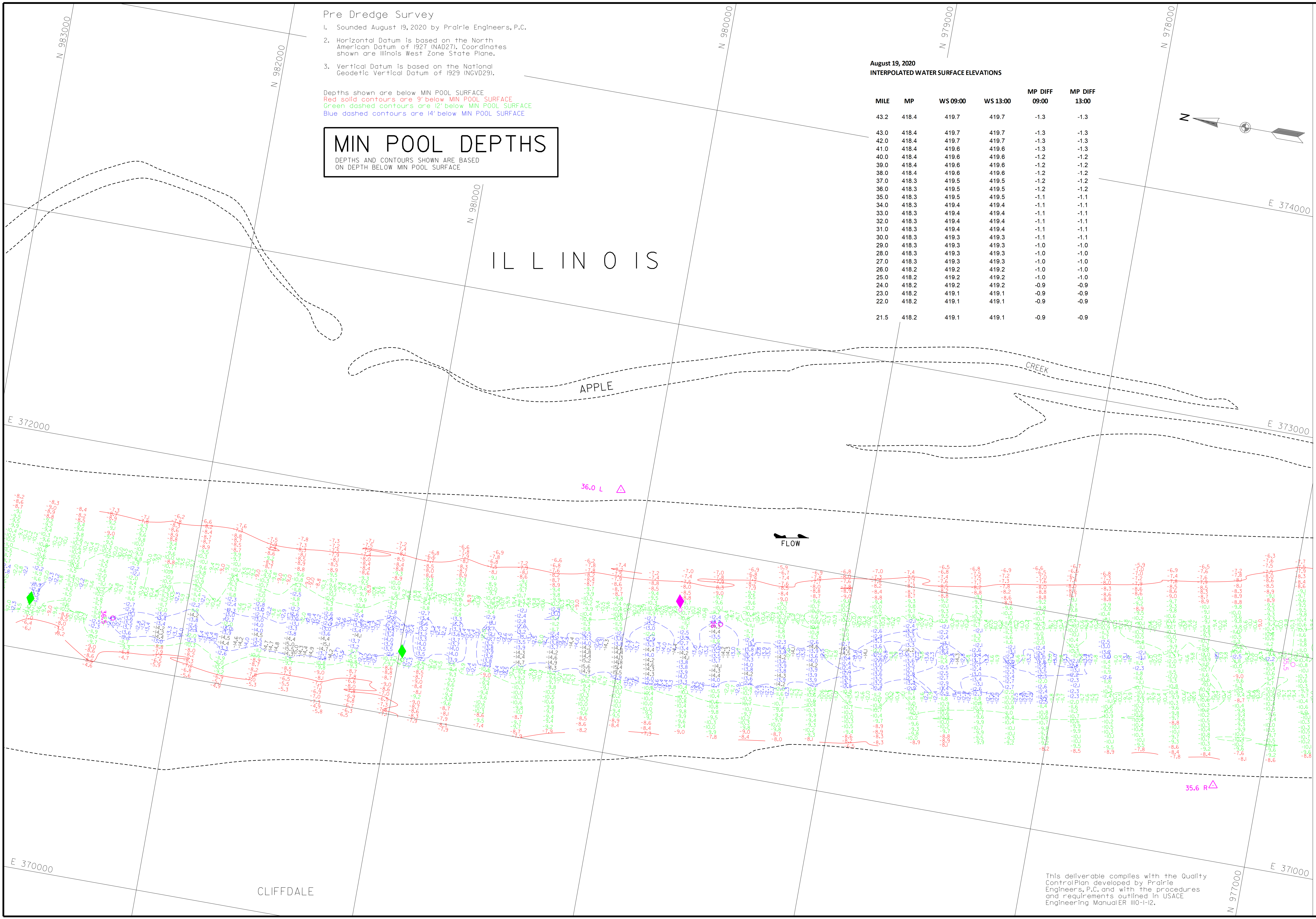

CAGE RECORD

WATER SURFACE	PEARL	HARDIN
400.0	400.0	400.0
43.2	43.2	43.2
48.4	48.4	48.4
19 AUG 2020	48.7 (09:00)	48.3 (09:00)
	48.7 (13:00)	48.3 (13:00)

ELEVATIONS ARE REFERRED TO NAZD. CONTOURS ARE BELOW WSPS. FOR WATER REFERENCE PLANE, WSPS = 400.0 (Z.S.)

Survey Date: August 19, 2020

Submitted: Chief, Engr. Data, Mgmt. Sect.

File Name: 039H20.mxd

Plot Date: 8/19/2020

Plot Scale: 1" = 200'

Approved: Chief, Geospatial Branch

U.S. ARMY ENGINEER DIVISION  
 CORPS OF ENGINEERS  
 ST. LOUIS, MISSOURI

ILLINOIS RIVER BASIN  
 ILLINOIS RIVER

PRE DREDGE SURVEY  
 RIVER MILES 37.5-35.0

PLATE NUMBER  
 02

This deliverable complies with the Quality Control Plan developed by Prairie Engineers, P.C. and with the procedures and requirements outlined in USACE Engineering Manual ER 1110-12.



This deliverable complies with the Quality Control Plan developed by Prairie Engineers, P.C. and with the procedures and requirements outlined in USACE Engineering Manual ER 110-1-12.

August 19, 2020  
INTERPOLATED WATER SURFACE ELEVATIONS

MILE	MP	WS 09:00	WS 13:00	MP DIFF 09:00	MP DIFF 13:00
43.2	418.4	419.7	419.7	-1.3	-1.3
43.0	418.4	419.7	419.7	-1.3	-1.3
42.0	418.4	419.7	419.7	-1.3	-1.3
41.0	418.4	419.6	419.6	-1.3	-1.3
40.0	418.4	419.6	419.6	-1.2	-1.2
39.0	418.4	419.6	419.6	-1.2	-1.2
38.0	418.4	419.6	419.6	-1.2	-1.2
37.0	418.3	419.5	419.5	-1.2	-1.2
36.0	418.3	419.5	419.5	-1.2	-1.2
35.0	418.3	419.5	419.5	-1.1	-1.1
34.0	418.3	419.4	419.4	-1.1	-1.1
33.0	418.3	419.4	419.4	-1.1	-1.1
32.0	418.3	419.4	419.4	-1.1	-1.1
31.0	418.3	419.4	419.4	-1.1	-1.1
30.0	418.3	419.3	419.3	-1.1	-1.1
29.0	418.3	419.3	419.3	-1.0	-1.0
28.0	418.3	419.3	419.3	-1.0	-1.0
27.0	418.3	419.3	419.3	-1.0	-1.0
26.0	418.2	419.2	419.2	-1.0	-1.0
25.0	418.2	419.2	419.2	-1.0	-1.0
24.0	418.2	419.2	419.2	-0.9	-0.9
23.0	418.2	419.1	419.1	-0.9	-0.9
22.0	418.2	419.1	419.1	-0.9	-0.9
21.5	418.2	419.1	419.1	-0.9	-0.9

- Pre Dredge Survey
- Sounded August 19, 2020 by Prairie Engineers, P.C.
  - Horizontal Datum is based on the North American Datum of 1927 (NAD27). Coordinates shown are Illinois West Zone State Plane.
  - Vertical Datum is based on the National Geodetic Vertical Datum of 1929 (NGVD29).

Depths shown are below MIN POOL SURFACE  
 Red solid contours are 9' below MIN POOL SURFACE  
 Green dashed contours are 12' below MIN POOL SURFACE  
 Blue dashed contours are 14' below MIN POOL SURFACE

**MIN POOL DEPTHS**  
 DEPTHS AND CONTOURS SHOWN ARE BASED ON DEPTH BELOW MIN POOL SURFACE

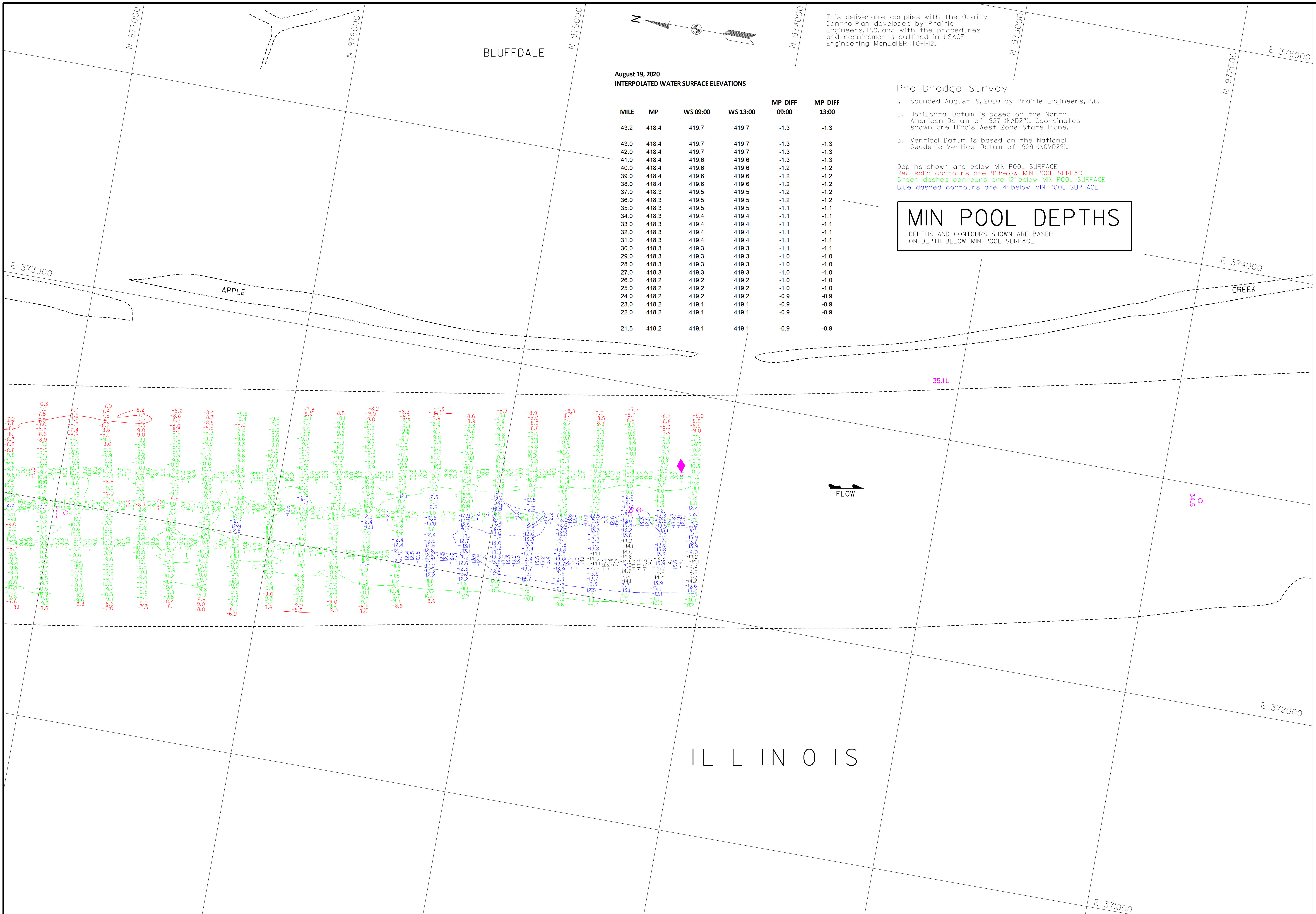

GAUGE RECORD

WATER SURFACE	PEARL	HARDIN
ZERO N.G.V.D. MILE	400.0	400.0
MIN POOL DATE	43.2	2LS
	418.4	46.2
	418.7 (09/20)	46.1 (09/20)
	418.7 (03/20)	46.1 (03/20)

ELEVATIONS ARE REFERRED TO N.G.V.D. CONTOURS ARE BELOW 100.0. MIN WATER REFERENCE PLANE LAMP: 100.0 (2.5)

Survey Date: August 19, 2020  
 SUBMITTED: Chief, Engr. Data, Mgmt. Sect.  
 File Name: 03PRD02.apr190320  
 Plot Date: 8/19/2020  
 Plot Scale: 1" = 200'

Surveyed by: PRAIRIE ENGINEERS  
 Drawn by: PCE  
 Reviewed by: Chief, Geospatial Branch  
 APPROVED:

U.S. ARMY ENGINEER DIVISION  
 CORPS OF ENGINEERS  
 ST. LOUIS, MISSOURI  
 ILLINOIS RIVER BASIN  
 ILLINOIS RIVER

60 0 200 400 METERS  
 200 0 400 FEET  
 THE INFORMATION DEPICTED ON THIS MAP REPRESENTS THE RESULTS OF A SURVEY CONDUCTED UNDER THE GENERAL CONDITIONS EXISTING AT THAT TIME.  
 PRE DREDGE SURVEY  
 RIVER MILES 37.5-35.0

PLATE NUMBER  
 03