

SEE PLATE NUMBER 32

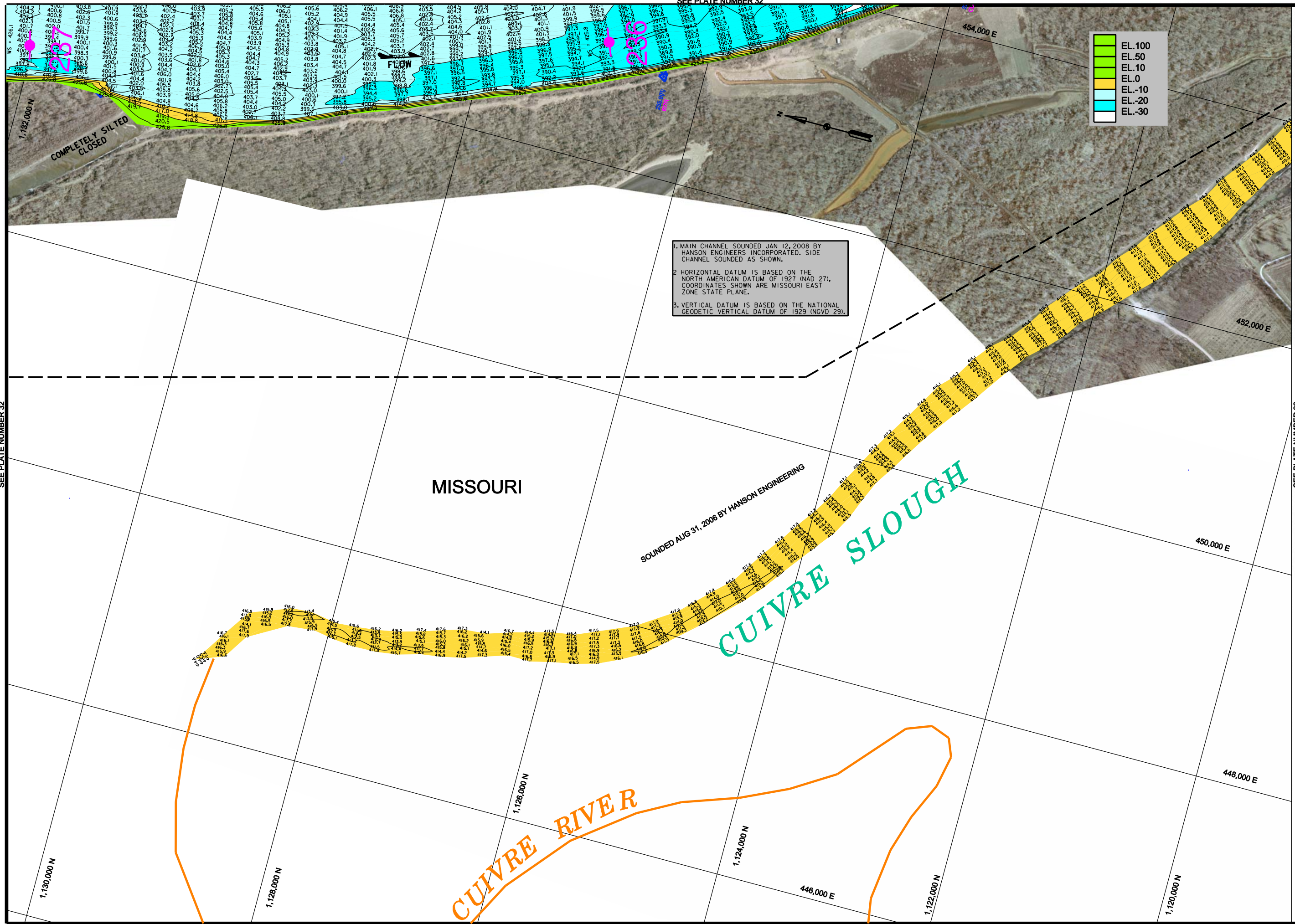

1. MAIN CHANNEL SOUNDED JAN 12, 2008 BY HANSON ENGINEERS INCORPORATED. SIDE CHANNEL SOUNDED AS SHOWN.
2. HORIZONTAL DATUM IS BASED ON THE NORTH AMERICAN DATUM OF 1927 (NAD 27). COORDINATES SHOWN ARE MISSOURI EAST ZONE STATE PLANE.
3. VERTICAL DATUM IS BASED ON THE NATIONAL GEODETIC VERTICAL DATUM OF 1929 (NGVD 29).



GAGE RECORD		ST. LOUIS
DIXON LANDING	L & O 25 (LOWER)	379.94
ZERO NGVD	410.00	241.2
MILE	228.3	179.6
L. W. R.	418.1	376.4
12 JAN 08	433.3	427.4
31 AUG 08	432.2	421.2

ELEVATIONS ARE REFERRED TO NAZD. COORDINATES ARE BELOW 1983-91 FOR WATER REFERENCE PLANE LA 800-194000 27.5J

SEE PLATE NUMBER 33	
Surveyed by: AS SHOWN	Survey Date: AS SHOWN
Checked by: VICTOR BERGMANN	Reviewed by: DAWN LAMM
Submitted: JAMES L. KEIM Chief, Eng. Data Mngt. Sect.	Checked by: JAMES KEIM
Approved: KEITH SHORT Chief, Geospatial Branch	Plot date: FEB 2010
File name: StLouisSurvey\Hydro\BDS\MSR_30F_2007.rdm	

U.S. ARMY ENGINEER DIVISION CORPS OF ENGINEERS ST. LOUIS, MISSOURI
UPPER MISSISSIPPI RIVER BASIN HYDROGRAPHIC SURVEY CUIVRE SLOUGH

DATE OF PHOTO MOSAIC: 22-24 FEB 2006
ST. LOUIS GAGE: -1.01
CAIRO GAGE: 31.30

PLATE NUMBER
32A