

Bechtel

Oak Ridge Corporate Center
151 Lafayette Drive
P.O. Box 350
Oak Ridge, Tennessee 37831-0350

Facsimile: (615) 220-2100

Job No. 14501
DOE Contract No. E
Code: 9808271039
ect 949 116

SLDS
Administrative
Record

FEB 21 1995

Mallinckrodt Chemical
Mallinckrodt and Second Streets
P.O. Box 5439
St. Louis, MO 63147

Attention: Mr. Tom Byrd

Subject: SLDS - Radon Monitoring Results From Building 116,
St. Louis Downtown Site

Dear Mr. Byrd:

In response to your request, we are providing radon monitoring results for Building 116. Routine environmental monitoring for radon began when detectors were first placed in the building in October of 1993. Since then, radon detectors have been collected in January of 1994, July of 1994, and January of 1995. The data for the most recently collected detectors are not yet available. Once received, these results will be provided to you. Also included are 3 figures indicating the locations of the radon detectors.

In addition, the external gamma exposure rate measurements for each of the TETLD locations (also shown on the enclosed figures) were less than the average measured background (58 mR/yr) for the period between January 1994 and July 1994.

If you have any questions, please contact me at (615) 576-1710.

Sincerely,

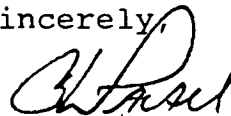

G. L. Palau
Project Manager - FUSRAP

GLP:kt:MO_0137

Enclosures: Radon Monitoring Results for Building 116.



Bechtel National, Inc.

| | | | |
|--|------------------------------|--|----------------|
| ACTION REQ'D | <input type="checkbox"/> YES | <input checked="" type="checkbox"/> NO | DUE DATE _____ |
| RESPONSE TO CHRON NO. _____ | | | |
| <input type="checkbox"/> FFA <input type="checkbox"/> Permit <input type="checkbox"/> Milestone <input type="checkbox"/> Ocr <input type="checkbox"/> CCN <input type="checkbox"/> CAR <input type="checkbox"/> Mid-Yr <input type="checkbox"/> Yr-End <input type="checkbox"/> Periodic Rpt | | | |

**Radon Measurements for Building 116
St. Louis Downtown Site (SLDS)**

| Location | Radon (pCi/L) July 1994 | Radon (pCi/L) Jan 1994 |
|---------------|-------------------------------|------------------------------|
| R0 (QC of R1) | 1.1 | 2.0 |
| R1 | 1.2 | 1.5 |
| R2 | 0.5 | |
| R3 | 0.5 | 0.6 |
| R4 | 1.4 | 1.3 |
| R5 | 0.2 | |
| R6 | 0.2 | |
| R7 | 0.6 | 0.5 |
| R8 | 0.8 | |
| R9 | 0.8 | |

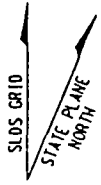

1. MAIN ENTRANCE AND TEXT
2. DOOR PASSAGEWAY
3. EMERGENCY EXIT ONLY
4. STAIRWAY ACCESS DOOR
5. LOADING DOCK DOOR, NOT AN EXIT
6. BOLTED DOOR NOT AN EXIT
7. SEALED DOOR NOT AN EXIT
8. BOLTED DOOR NOT AN EXIT
9. SEALED DOOR NOT AN EXIT
10. SEALED DOOR NOT AN EXIT
11. DOOR TO CONTAM. MATL. STORAGE AREA
12. DOOR TO CONTAMINATED MATL. STORAGE AREA

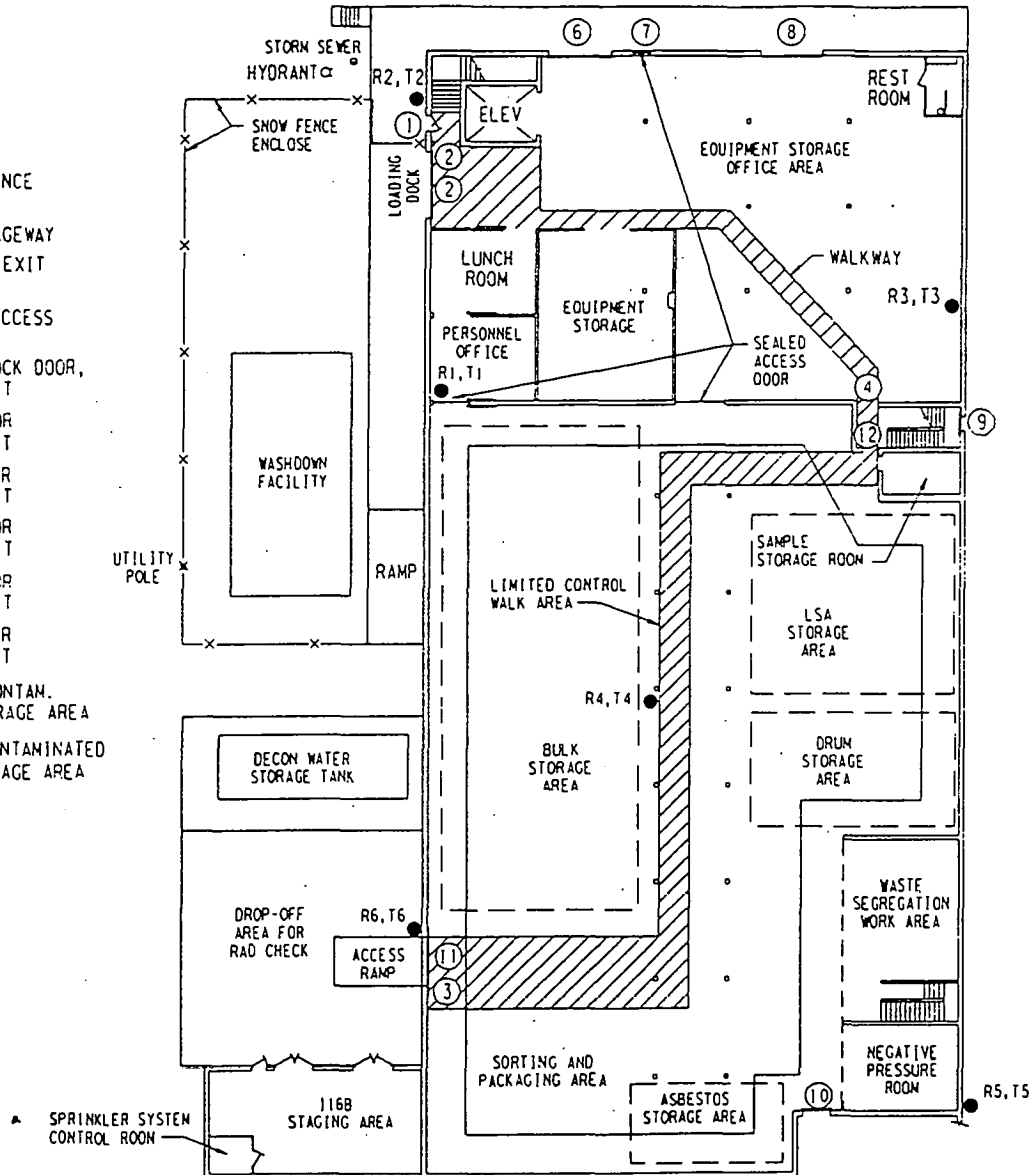

- DETECTOR LOCATION
- Tx TETLD, x = LOCATION
- Rx RADON, x = LOCATION

NOT TO SCALE

1J6F100.DGN

ATTACHMENT 1 RADON (R) AND TETLD (T) SURVEILLANCE LOCATIONS BUILDING 116, 1st FLOOR

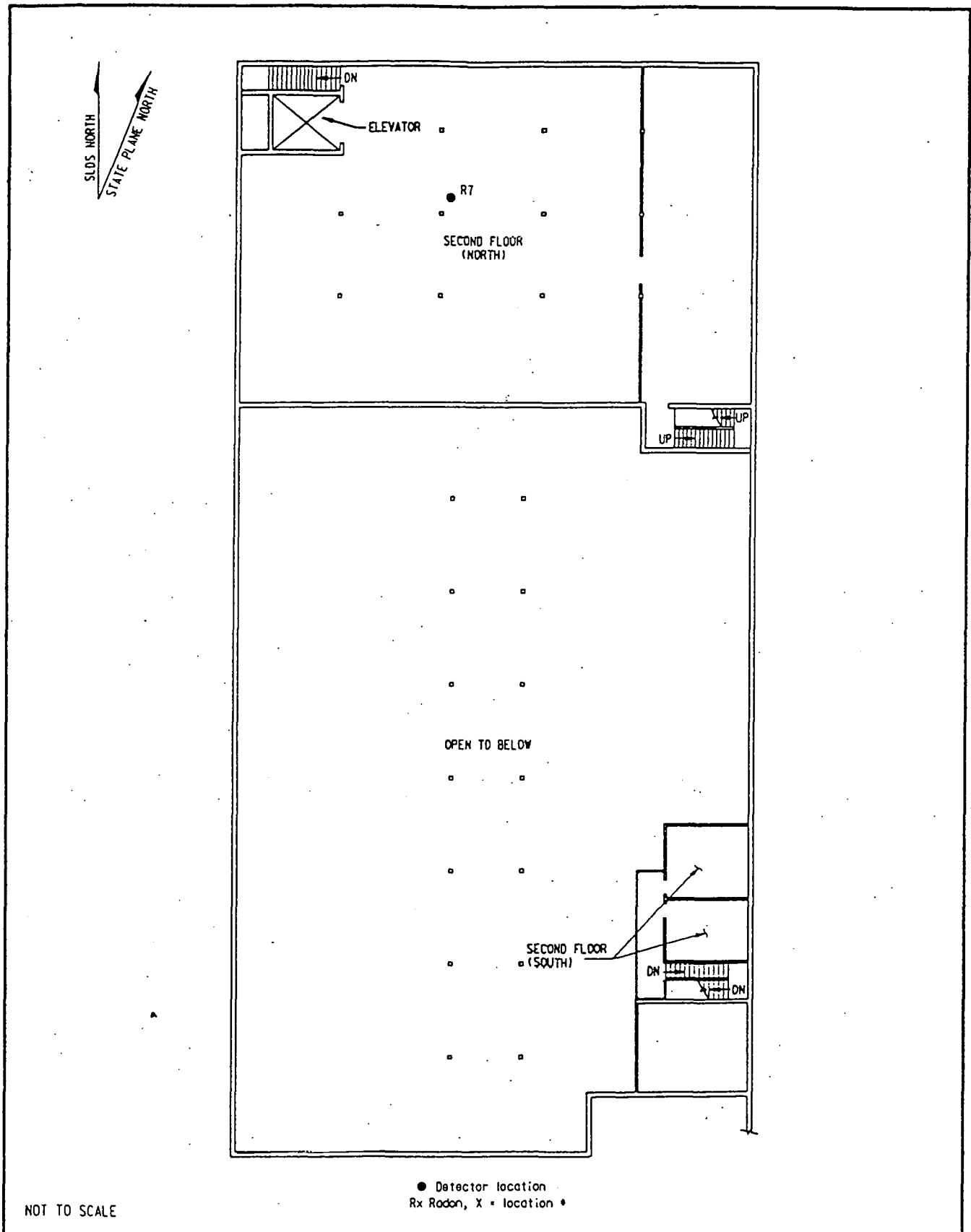

146F101.DGN

ATTACHMENT 2
RADON SURVEILLANCE LOCATIONS
BUILDING 116, 2nd FLOOR

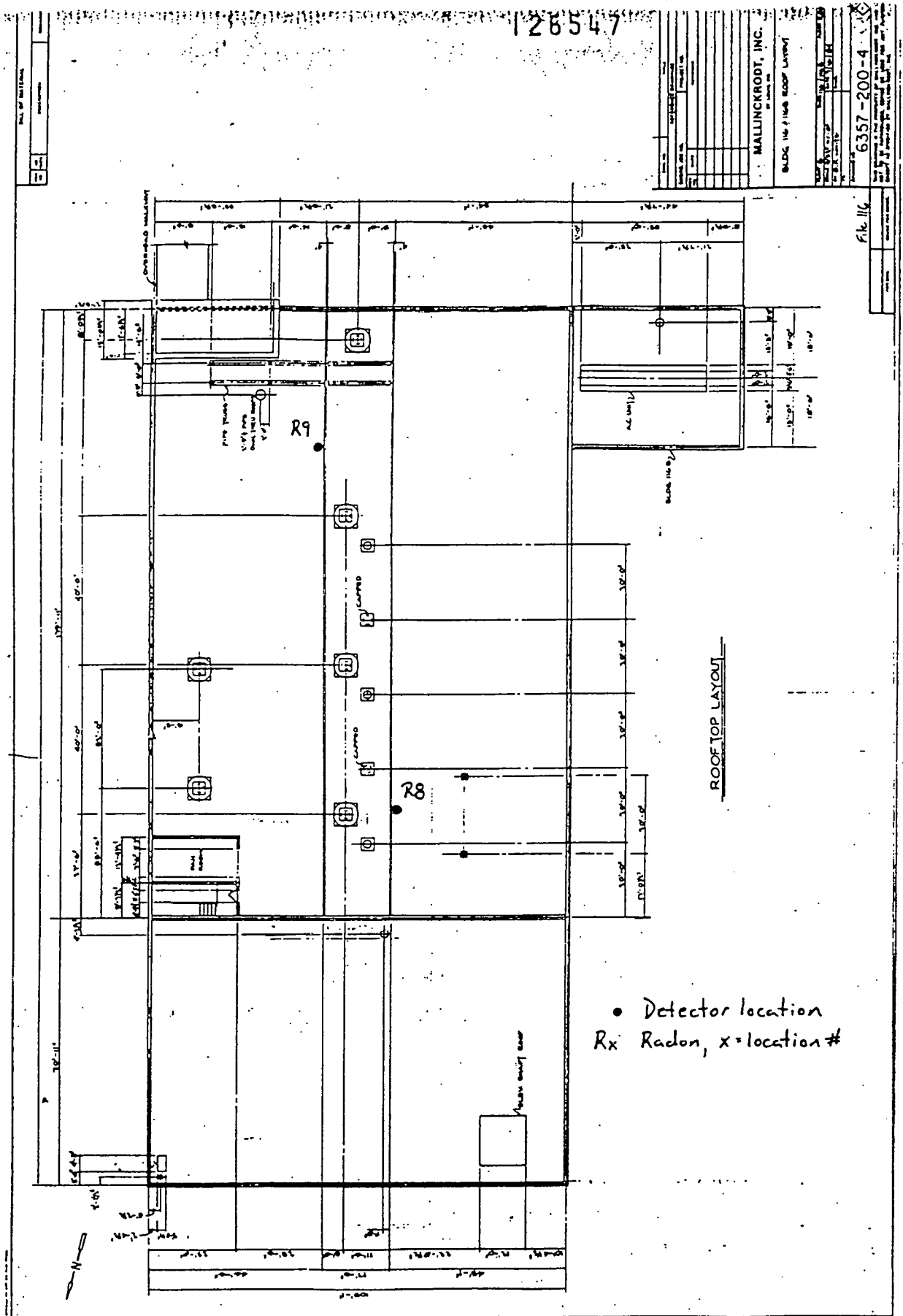

ATTACHMENT 3.
RADON SURVEILLANCE LOCATIONS
BUILDING 116 (ROOF)