

GAGE RECORD	
ST. LOUIS, MO	CHESTER L
379.84	34.05
379.8	109.8
L.M.R.P.	340.40
13 OCT 11	52.312(00) 52.2514(00) 6.9612(00) 4.2112(00) 4.2114(00)
Elevations are referred to M.S.L. - contours are below 1987.5. Low water reference plane is M.S.L. (1987) (1988) (2.5)	

Survey Date: October 13, 2011	Submitted: X
Drawn by: K	Reviewed by: X
Approved: X	Approved: X

U.S. ARMY ENGINEER DIVISION CORPS OF ENGINEERS ST. LOUIS, MISSOURI	UPPER MISSISSIPPI RIVER BASIN	MISSISSIPPI RIVER
--------------------------------------------------------------------------	-------------------------------	-------------------

PLATE NUMBER	XX
--------------	----

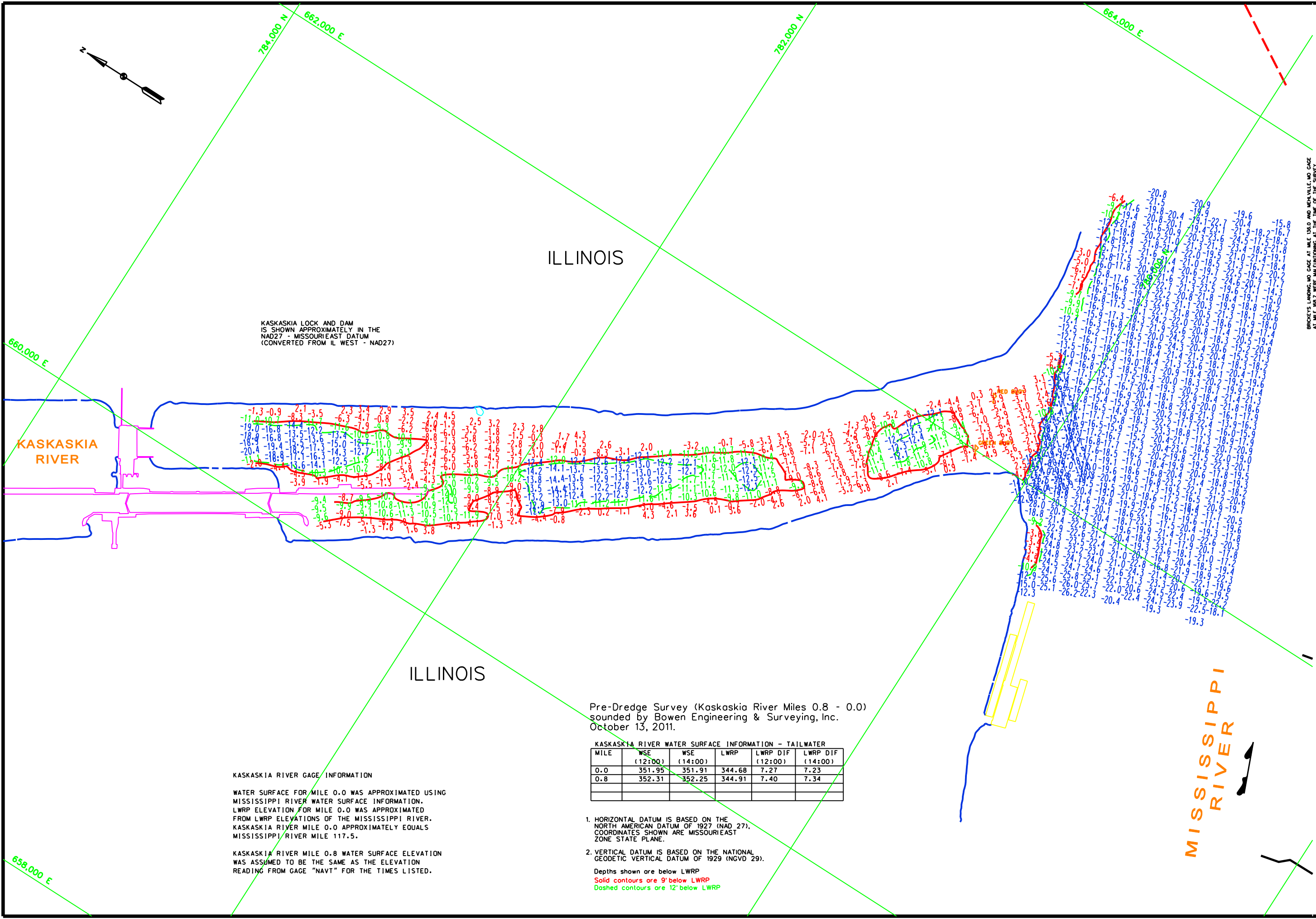

KASKASKIA LOCK AND DAM IS SHOWN APPROXIMATELY IN THE NAD27 - MISSOURIEAST DATUM (CONVERTED FROM IL WEST - NAD27)

ILLINOIS

KASKASKIA RIVER

ILLINOIS

MISSISSIPPI RIVER

Pre-Dredge Survey (Kaskaskia River Miles 0.8 - 0.0) sounded by Bowen Engineering & Surveying, Inc. October 13, 2011.

KASKASKIA RIVER WATER SURFACE INFORMATION - TAILWATER					
MILE	WSE (12:00)	WSE (14:00)	LWRP	LWRP DIF (12:00)	LWRP DIF (14:00)
0.0	351.95	351.91	344.68	7.27	7.23
0.8	352.31	352.25	344.91	7.40	7.34

KASKASKIA RIVER GAGE INFORMATION

WATER SURFACE FOR MILE 0.0 WAS APPROXIMATED USING MISSISSIPPI RIVER WATER SURFACE INFORMATION. LWRP ELEVATION FOR MILE 0.0 WAS APPROXIMATED FROM LWRP ELEVATIONS OF THE MISSISSIPPI RIVER. KASKASKIA RIVER MILE 0.0 APPROXIMATELY EQUALS MISSISSIPPI RIVER MILE 117.5.

KASKASKIA RIVER MILE 0.8 WATER SURFACE ELEVATION WAS ASSUMED TO BE THE SAME AS THE ELEVATION READING FROM GAGE "NAVT" FOR THE TIMES LISTED.

- HORIZONTAL DATUM IS BASED ON THE NORTH AMERICAN DATUM OF 1927 (NAD 27). COORDINATES SHOWN ARE MISSOURIEAST ZONE STATE PLANE.
 - VERTICAL DATUM IS BASED ON THE NATIONAL GEODETIC VERTICAL DATUM OF 1929 (NGVD 29).
- Depths shown are below LWRP
 Solid contours are 9' below LWRP
 Dashed contours are 12' below LWRP

BRICEY'S LANNING MO GAGE AT MILE 136.0 AND MEH.VILLE, MO GAGE AT MILE 165.7 WERE MALFUNCTIONING AT THE TIME OF THE SURVEY.