

GAGE RECORD		L & D 24, UPPER		L & D 24, LOWER	
LOUISIANA MO	437.33	421.81	421.81	421.81	421.81
ZERO N.G.V.D.	282.9	273.5	273.5	273.5	273.5
MILE	448.8	445.5	445.5	445.5	445.5
O.C.T. 2015	E:17300 E:10714(0)	21,307.00	21,714.00	X	X
OZ OCT 2015	X	X	X	X	X

ELEVATIONS ARE REFERRED TO N.G.V.D. - CONDITIONS ARE BELOW 1984.57' LOW WATER REFERENCE PLANE (L.W.R.P.) (14-000 C.F.S.)

U.S. ARMY ENGINEER DIVISION		CORPS OF ENGINEERS		ST. LOUIS, MISSOURI	
UPPER MISSISSIPPI RIVER BASIN	MISSISSIPPI RIVER	Survey Date:	OCTOBER 1 & 2, 2015	Drawn by:	X
		Reviewed by:	X	Checked by:	X
		Submitted:	X	Approved:	X
		File name:	273.6 - 274.5	Plot date:	10/15/15

170 0 100 240 METERS
400 0 800 FEET

THE INFORMATION DEPICTED ON THIS MAP REPRESENTS THE RESULTS OF SURVEYS CONDUCTED UNDER THE GENERAL CONDITIONS LISTED ON THE REVERSE SIDE OF THIS DRAWING.

HYDROGRAPHIC SURVEYS

MILE: 273.6 - 274.5

Mississippi River Gage Information

Date	Gage	Time	WS Elev	Min Pool	Difference
20151001	Lock & Dam 24 (Upper)	7:00	449.11	445.50	3.61
20151001	Lock & Dam 24 (Upper)	14:00	449.08	445.50	3.58
20151001	Louisiana, MO	7:00	449.44	448.80	0.64
20151001	Louisiana, MO	14:00	449.40	448.80	0.60

1. SOUNDED OCTOBER 1 & 2, 2015 BY BOWEN ENGINEERING AND SURVEYING.
2. HORIZONTAL DATUM IS BASED ON THE NORTH AMERICAN DATUM OF 1927 (NAD 27). COORDINATES SHOWN ARE MISSOURI EAST ZONE STATE PLANE.
3. VERTICAL DATUM IS BASED ON THE NATIONAL GEODETIC VERTICAL DATUM OF 1929 (NGVD 29).

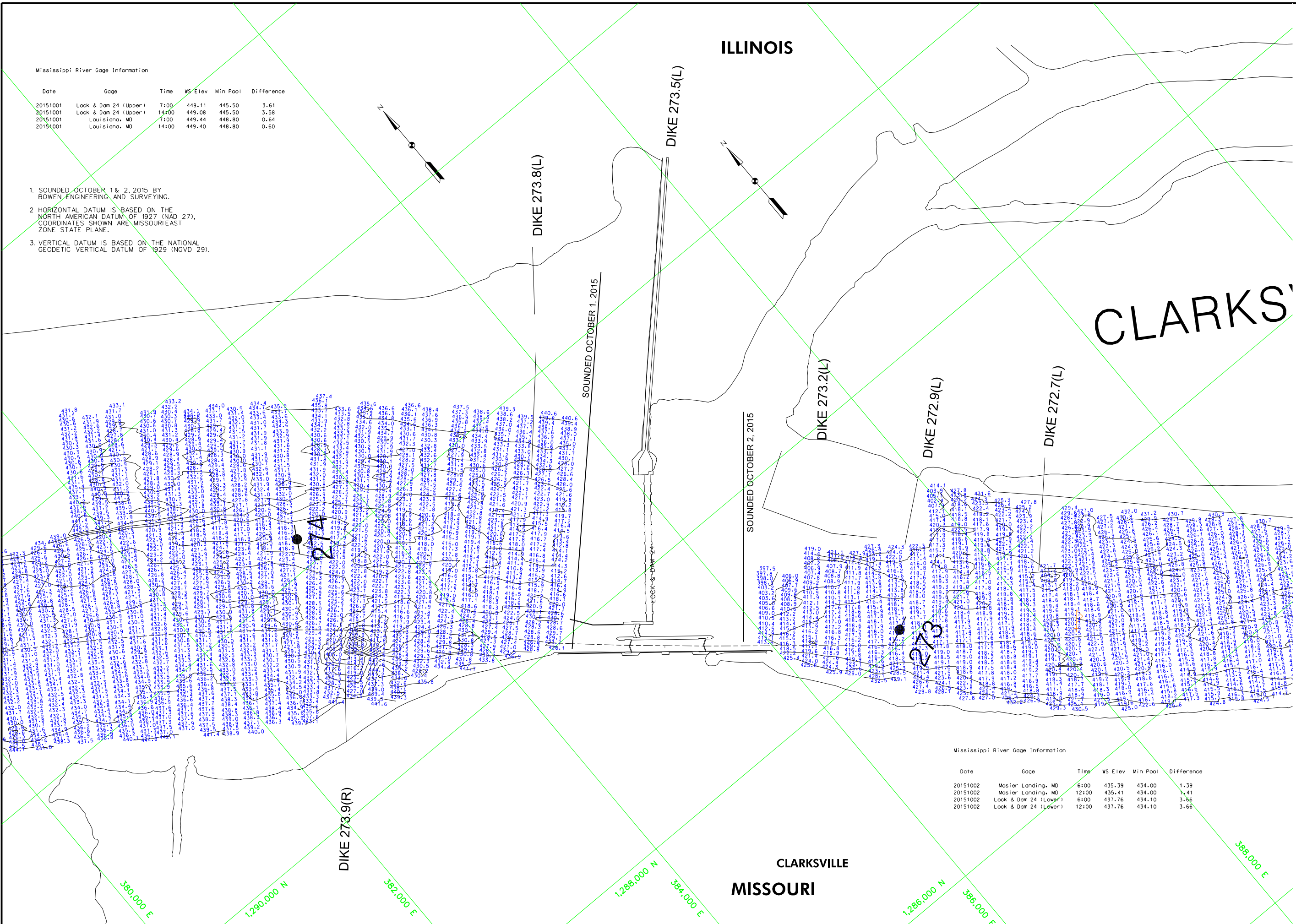

Mississippi River Gage Information

Date	Gage	Time	WS Elev	Min Pool	Difference
20151002	Mosier Landing, MD	6:00	435.39	434.00	1.39
20151002	Mosier Landing, MD	12:00	435.41	434.00	1.41
20151002	Lock & Dam 24 (Lower)	6:00	437.76	434.10	3.66
20151002	Lock & Dam 24 (Lower)	12:00	437.76	434.10	3.66

ILLINOIS



US Army Corps of Engineers
St. Louis District

1. SOUNDED OCTOBER 2, 2015 BY BOWEN ENGINEERING AND SURVEYING.
2. HORIZONTAL DATUM IS BASED ON THE NORTH AMERICAN DATUM OF 1927 (NAD 27). COORDINATES SHOWN ARE MISSOURI EAST ZONE STATE PLANE.
3. VERTICAL DATUM IS BASED ON THE NATIONAL GEODETIC VERTICAL DATUM OF 1929 (NGVD 29).

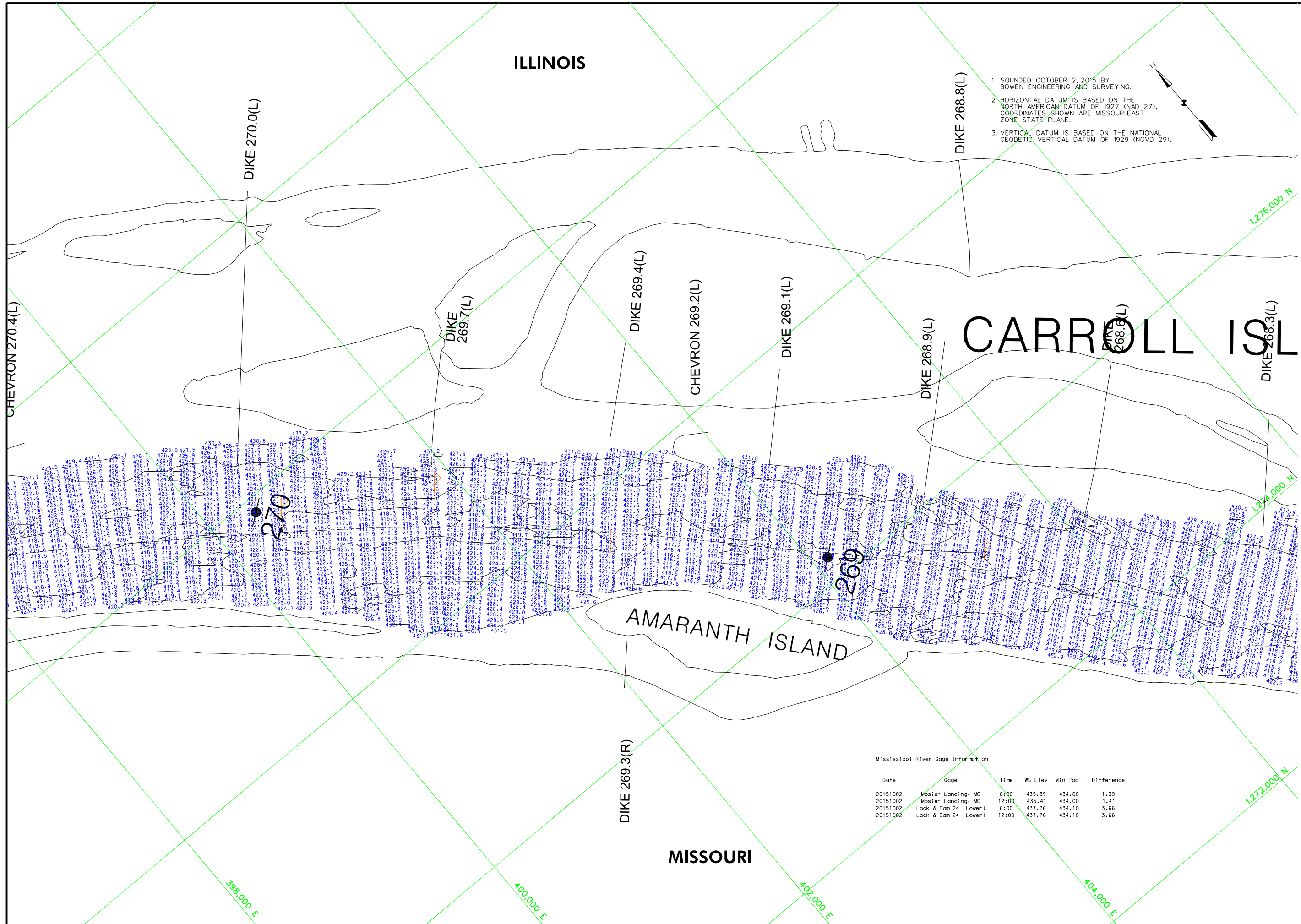
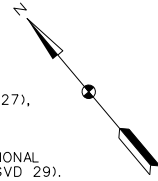

GAGE RECORD	
L & D	24 LOWER
ZERO N.G.V.D.	421.81
MILE	273.2
L.W.R.P.	434.1
02 OCT 2015	35.996(00) 35.412(20)
	X

Survey Date: OCTOBER 2, 2015	
Drawn by:	Reviewed by:
X	X
Submitted:	Approved:
X	X
File name:	Plot date:
UPPER MISSISSIPPI RIVER BASIN	MISSISSIPPI RIVER

U.S. ARMY ENGINEER DIVISION
CORPS OF ENGINEERS
ST. LOUIS, MISSOURI

HYDROGRAPHIC SURVEYS

MILE: 268.3 - 270.3

Mississippi River Gage Information

Date	Gage	Time	WS Elev	Min Pool	Difference
20151002	Mosier Landing, MO	6:00	435.39	434.00	1.39
20151002	Mosier Landing, MO	12:00	435.41	434.00	1.41
20151002	Lock & Dam 24 (Lower)	6:00	437.76	434.10	3.66
20151002	Lock & Dam 24 (Lower)	12:00	437.76	434.10	3.66

PLATE NUMBER

16

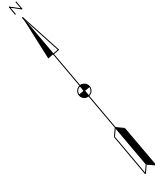

ILLINOIS

RIP RAP LANDING BOAT RAMP

RIP RAP LANDING

Mississippi River Gage Information

Date	Gage	Time	WS Elev	Min Pool	Difference
20151013	Mosier Landing, MD	8:00	434.96	434.00	0.96
20151013	Mosier Landing, MD	13:00	434.90	434.00	0.90
20151013	Lock & Dam 24 (Lower)	8:00	436.44	434.10	2.34
20151013	Lock & Dam 24 (Lower)	13:00	436.41	434.10	2.31

1. SOUNDED OCTOBER 13, 2015 BY BOWEN ENGINEERING AND SURVEYING.
2. HORIZONTAL DATUM IS BASED ON THE NORTH AMERICAN DATUM OF 1927 (NAD 27). COORDINATES SHOWN ARE MISSOURI EAST ZONE STATE PLANE.
3. VERTICAL DATUM IS BASED ON THE NATIONAL GEODETIC VERTICAL DATUM OF 1929 (NGVD 29).

MRS 265.7(L)

266

265

GRIMES ISLAND

MCCOY ISL

DIKE 266.2(R)
CHEVRON 266.1(R)

CHEVRON 266.0(R)

DIKE 265.9(R)

CHEVRON 265.8(R)

DIKE 265.6(R)

MISSOURI

SLIM ISLAND

WILLOW BAR

414,000 E

416,000 E

418,000 E

420,000 E

1,262,000 N

1,269,000 N

1,258,000 N



US Army Corps of Engineers
St. Louis District

ZERO N.G.V.D. L.W.R.P.	GAGE RECORD		L & D 24 LOWER 421.81	L & D 25 UPPER 407.0
	MOSELER 400.0	264.3		
13 OCT 2015	434.1	434.0	34.86(800) 14.90(1300)	X

ELEVATIONS ARE REFERRED TO M.S.L. - CONTOURS ARE BELOW 1984-87 LOW WATER REFERENCE PLANE (L.W.R.P.) (14.800 C.F.S.)

Surveyed by: BOWEN ENGINEERING	Survey Date: OCTOBER 13, 2015	Drawn by: X	Reviewed by: X	Checked by: X
U.S. ARMY ENGINEER DIVISION CORPS OF ENGINEERS ST. LOUIS, MISSOURI	UPPER MISSISSIPPI RIVER BASIN	MISSISSIPPI RIVER	APPROVED: X	Plot date: #8/8/16/16/16/16

1" = 240 METERS 1" = 800 FEET	HYDROGRAPHIC SURVEYS
MILE: 264.2 - 266.2	

PLATE NUMBER
18

GAGE RECORD	
L & D 24 LOWER	L & D 25 UPPER
421.81	407.0
273.2	241.5
434.1	429.7
14,878,000 (1,601,350)	14,868,000 (1,601,350)
14,877,000 (1,635,550)	14,867,000 (1,635,550)
	27,017,000 (2,030,500)

ZERO N.G.V.D. 400.0
MOSIER
MILE 263.0
13 OCT 2015
14 OCT 2015

ELEVATIONS ARE REFERRED TO M.S.L. - CONTOURS ARE BELOW 1956-57 LOW WATER REFERENCE PLANE (L.W.R.P.) (14,800 C.F.S.)

U.S. ARMY ENGINEER DIVISION CORPS OF ENGINEERS ST. LOUIS, MISSOURI	UPPER MISSISSIPPI RIVER BASIN MISSISSIPPI RIVER
Survey Date: OCTOBER 13 & 14, 2015	Drawn by: [Signature]
Reviewed by: [Signature]	Checked by: [Signature]
Submitted: [Signature]	Approved: [Signature]
File name: [Text]	Plot date: [Text]

HYDROGRAPHIC SURVEYS

MILE: 262.0 - 264.2

240 METERS
800 FEET

THE INFORMATION DEPICTED ON THIS MAP REPRESENTS THE RESULTS OF SURVEYS CONDUCTED IN ACCORDANCE WITH THE GENERAL CONDITIONS OF CONTRACT AND AS INDICATED BY THE GENERAL CONDITIONS OF CONTRACT.

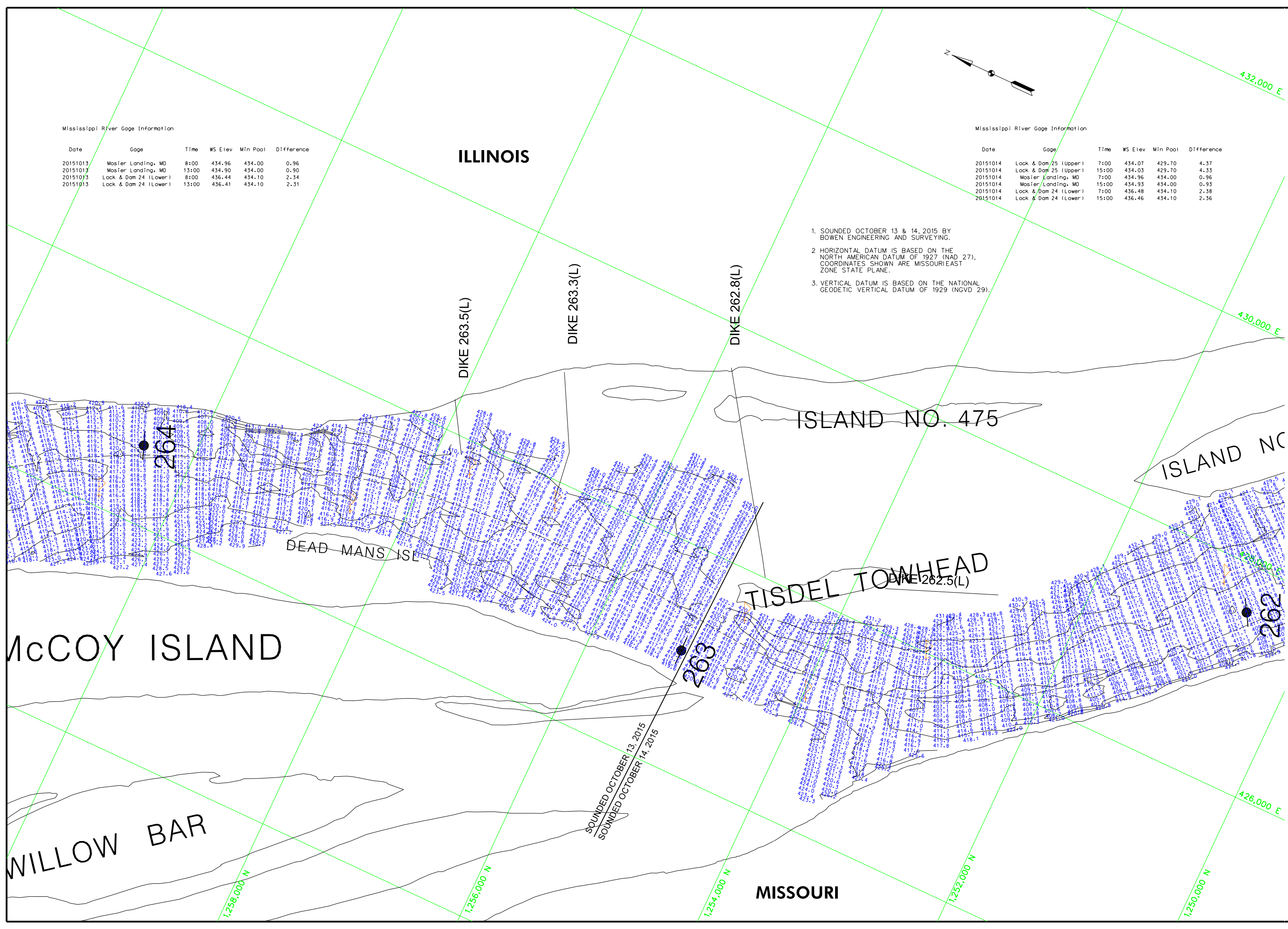

Mississippi River Gage Information

Date	Gage	Time	WS Elev	Min Pool	Difference
20151013	Mosier Landing, MD	8:00	434.96	434.00	0.96
20151013	Mosier Landing, MD	13:00	434.90	434.00	0.90
20151013	Lock & Dam 24 (Lower)	8:00	436.44	434.10	2.34
20151013	Lock & Dam 24 (Lower)	13:00	436.41	434.10	2.31

Mississippi River Gage Information

Date	Gage	Time	WS Elev	Min Pool	Difference
20151014	Lock & Dam 25 (Upper)	7:00	434.07	429.70	4.37
20151014	Lock & Dam 25 (Upper)	15:00	434.03	429.70	4.33
20151014	Mosier Landing, MD	7:00	434.96	434.00	0.96
20151014	Mosier Landing, MD	15:00	434.93	434.00	0.93
20151014	Lock & Dam 24 (Lower)	7:00	436.48	434.10	2.38
20151014	Lock & Dam 24 (Lower)	15:00	436.46	434.10	2.36

1. SOUNDED OCTOBER 13 & 14, 2015 BY BOWEN ENGINEERING AND SURVEYING.
2. HORIZONTAL DATUM IS BASED ON THE NORTH AMERICAN DATUM OF 1927 (NAD 27). COORDINATES SHOWN ARE MISSOURI EAST ZONE STATE PLANE.
3. VERTICAL DATUM IS BASED ON THE NATIONAL GEODETIC VERTICAL DATUM OF 1929 (NGVD 29).

SOUNDED OCTOBER 13, 2015
SOUNDED OCTOBER 14, 2015

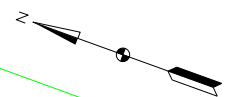
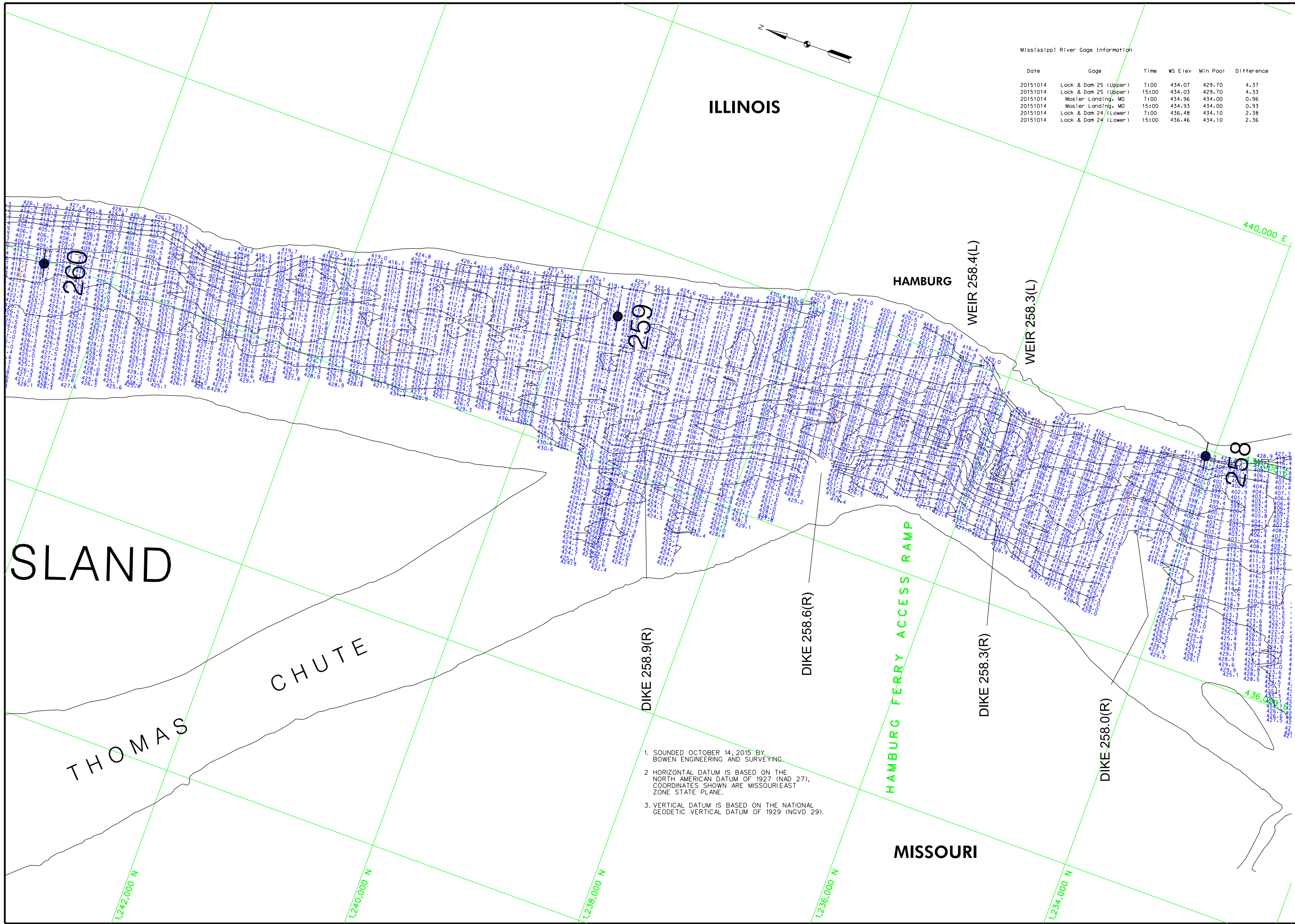

Mississippi River Gage Information

Date	Gage	Time	WS Elev	Min Pool	Difference
20151014	Lock & Dam 25 (Upper)	7:00	434.07	429.70	4.37
20151014	Lock & Dam 25 (Upper)	15:00	434.03	429.70	4.33
20151014	Mosier Landing, MD	7:00	434.96	434.00	0.96
20151014	Mosier Landing, MD	15:00	434.93	434.00	0.93
20151014	Lock & Dam 24 (Lower)	7:00	436.48	434.10	2.38
20151014	Lock & Dam 24 (Lower)	15:00	436.46	434.10	2.36

GAGE RECORD	
L & D 24 LOWER	L & D 25 UPPER
MOSIER	MOSIER
400.0	407.0
421.81	415.0
273.2	241.5
434.1	429.7
14.677(20) 14.531(5(50))	14.677(20) 14.531(5(50))
14.677(20) 14.531(5(50))	14.677(20) 14.531(5(50))

ELEVATIONS ARE REFERRED TO M.S.L. - CONTOURS ARE BELOW 1000 FT. LOW WATER REFERENCE PLANE (L.W.R.P.) (M.S.L. 14.531(5(50))

U.S. ARMY ENGINEER DIVISION CORPS OF ENGINEERS ST. LOUIS, MISSOURI	
UPPER MISSISSIPPI RIVER BASIN	MISSISSIPPI RIVER
FILE NAME: 257-9-260.DWG	PLOT DATE: 10/14/2015
DESIGNED BY: BOWEN ENGINEERING	REVIEWED BY: BOWEN ENGINEERING
DRAWN BY: BOWEN ENGINEERING	CHECKED BY: BOWEN ENGINEERING
SUBMITTED: X	APPROVED: X

HYDROGRAPHIC SURVEYS

1" = 240 METERS
1" = 800 FEET

THE INFORMATION DEPICTED ON THIS MAP REPRESENTS THE RESULTS OF SURVEYS CONDUCTED UNDER THE GENERAL CONDITIONS ESTABLISHED BY THE U.S. ARMY ENGINEER DIVISION.

MILE: 257-9-260.0

PLATE NUMBER

21

1. SOUNDED OCTOBER 14, 2015 BY BOWEN ENGINEERING AND SURVEYING.
2. HORIZONTAL DATUM IS BASED ON THE NORTH AMERICAN DATUM OF 1927 (NAD 27). COORDINATES SHOWN ARE MISSOURI EAST ZONE STATE PLANE.
3. VERTICAL DATUM IS BASED ON THE NATIONAL GEODETIC VERTICAL DATUM OF 1929 (NGVD 29).

Mississippi River Gage Information

Date	Gage	Time	WS Elev	Min Pool	Difference
20151014	Lock & Dam 25 (Upper)	7:00	434.07	429.70	4.37
20151014	Lock & Dam 25 (Upper)	15:00	434.03	429.70	4.33
20151014	Mosier Landing, MD	7:00	434.96	434.00	0.96
20151014	Mosier Landing, MD	15:00	434.93	434.00	0.93
20151014	Lock & Dam 24 (Lower)	7:00	436.48	434.10	2.38
20151014	Lock & Dam 24 (Lower)	15:00	436.46	434.10	2.36

Mississippi River Gage Information

Date	Gage	Time	WS Elev	Min Pool	Difference
20151102	Lock & Dam 25 (Upper)	11:00	434.06	429.70	4.36
20151102	Lock & Dam 25 (Upper)	15:00	434.03	429.70	4.33
20151102	Mosier Landing, MD	11:00	435.66	434.00	1.66
20151102	Mosier Landing, MD	15:00	435.64	434.00	1.64



US Army Corps of Engineers
St. Louis District

GAGE RECORD	
L & D 24 LOWER	L & D 25 UPPER
ZERO NGVD	MOSIER
421.81	400.0
273.2	260.3
434.1	241.5
434.0	429.7
14.677(20) 14.657(50)	14.677(20) 14.657(50)
34.867(30) 34.847(50)	34.867(30) 34.847(50)
54.867(30) 54.847(50)	54.867(30) 54.847(50)
74.867(30) 74.847(50)	74.867(30) 74.847(50)

SURVEY DATA	
OCT 14, AND NOV. 2, 2015	
Drawn by: BOWEN ENGINEERING	Checked by: []
Reviewed by: []	APPROVED: []
SUBMITTED: []	Plot date: []
U.S. ARMY ENGINEER DIVISION CORPS OF ENGINEERS ST LOUIS, MISSOURI	
UPPER MISSISSIPPI RIVER BASIN MISSISSIPPI RIVER	

HYDROGRAPHIC SURVEYS	
170	240 METERS
400	800 FEET
THE INFORMATION DEPICTED ON THIS MAP REPRESENTS THE RESULTS OF SURVEYS CONDUCTED UNDER THE AUTHORITY OF THE U.S. ARMY CORPS OF ENGINEERS AND IS NOT TO BE USED FOR ANY OTHER PURPOSE WITHOUT THE WRITTEN PERMISSION OF THE DISTRICT ENGINEER.	
MILE: 255.9 - 257.9	

PLATE NUMBER
22



ILLINOIS

MISSOURI

WESTPORT

BULLNOSE
257.1(L)

DIKE 256.8(L)
MRS 256.8(L)

KELLY ISLAND

WESTPORT ISLAND

WESTPORT CHUTE

1. SOUNDED OCT. 14 AND NOV. 2 2015 BY BOWEN ENGINEERING AND SURVEYING.
2. HORIZONTAL DATUM IS BASED ON THE NORTH AMERICAN DATUM OF 1927 (NAD 27). COORDINATES SHOWN ARE MISSOURI EAST ZONE STATE PLANE.
3. VERTICAL DATUM IS BASED ON THE NATIONAL GEODETIC VERTICAL DATUM OF 1929 (NGVD 29).

ILLINOIS

1. SOUNDED NOVEMBER 2, 2015 BY BOWEN ENGINEERING AND SURVEYING.
2. HORIZONTAL DATUM IS BASED ON THE NORTH AMERICAN DATUM OF 1927 (NAD 27). COORDINATES SHOWN ARE MISSOURI EAST ZONE STATE PLANE.
3. VERTICAL DATUM IS BASED ON THE NATIONAL GEODETIC VERTICAL DATUM OF 1929 (NGVD 29).

Mississippi River Gage Information

Date	Gage	Time	WS Elev	Min Pool	Difference
20151102	Lock & Dam 25 (Upper)	11:00	434.06	429.70	4.36
20151102	Lock & Dam 25 (Upper)	15:00	434.03	429.70	4.33
20151102	Mosier Landing, MD	11:00	435.66	434.00	1.66
20151102	Mosier Landing, MD	15:00	435.64	434.00	1.64



GAGE RECORD	
L & D 24 LOWER	LMO 25 UPPER
421.81	407.0
273.2	241.5
434.1	429.7
X	35.66(100) 35.64(100) 27.06(100) 27.03(100)
ELEVATIONS ARE REFERRED TO U.S.C.S. CONTIGUOUS ARE BELOW 1985-81 LOW WATER REFERENCE PLANE U.S.C.S. 1985-81 U.S.C.S. 1985-81 U.S.C.S.	

SURVEY DATA	
NOVEMBER 2, 2015	
Drawn by: X	Reviewed by: X
Submitted: X	Approved: X
File name: 255.9	

HYDROGRAPHIC SURVEYS	
MILE: 253.8 - 255.9	

PLATE NUMBER
23

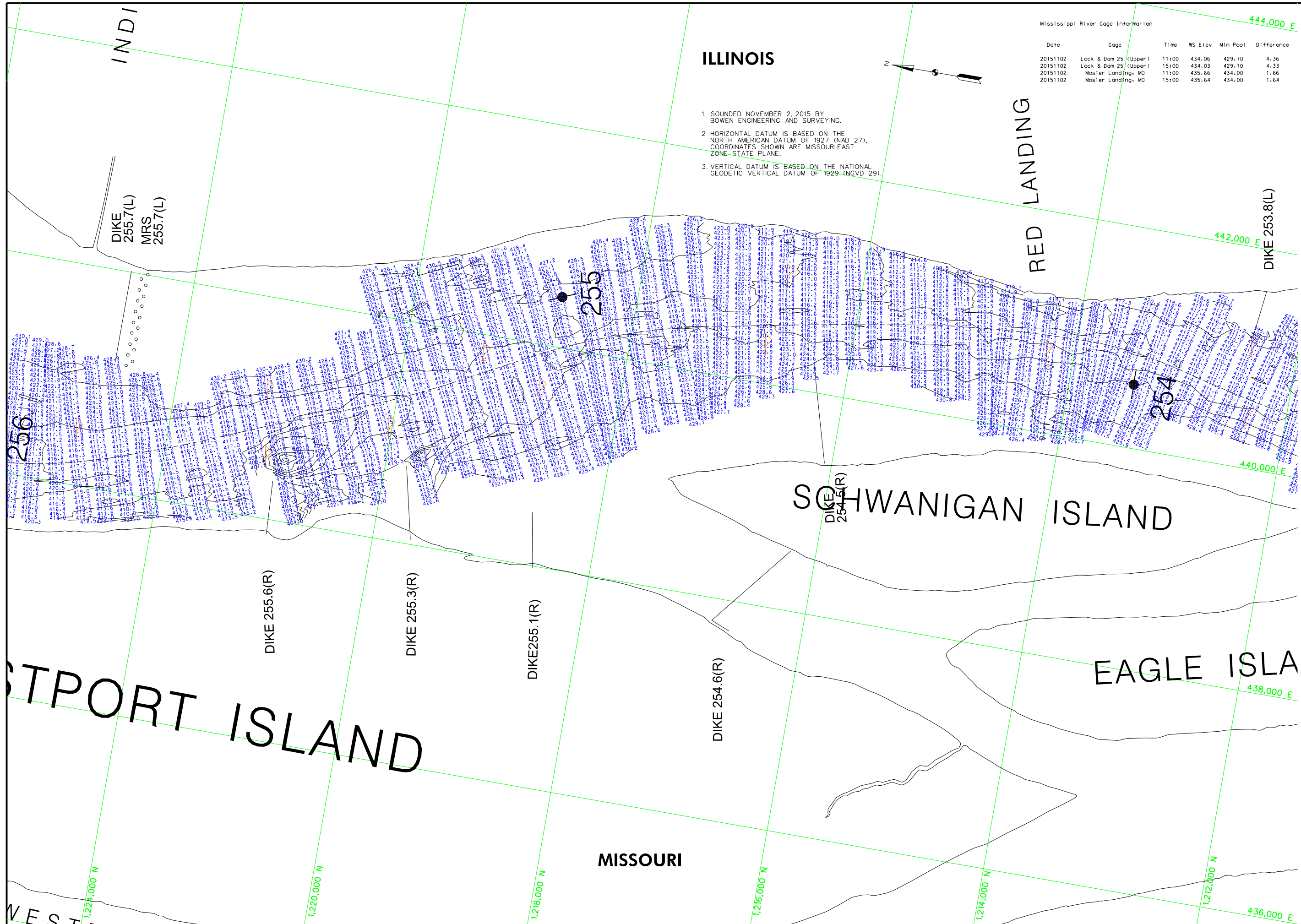



US Army Corps of Engineers
St. Louis District

ILLINOIS

Mississippi River Gage Information

Date	Gage	Time	WS Elev	Min Pool	Difference
20151102	Lock & Dam 25 (Upper)	11:00	434.06	429.70	4.36
20151102	Lock & Dam 25 (Upper)	15:00	434.03	429.70	4.33
20151102	Mosier Landing, MD	11:00	435.66	434.00	1.66
20151102	Mosier Landing, MD	15:00	435.64	434.00	1.64

Mississippi River Gage Information

Date	Gage	Time	WS Elev	Min Pool	Difference
20151103	Lock & Dam 25 (Upper)	8:00	434.04	429.70	4.34
20151103	Lock & Dam 25 (Upper)	15:00	434.03	429.70	4.33
20151103	Mosier Landing, MD	8:00	435.79	434.00	1.79
20151103	Mosier Landing, MD	15:00	435.80	434.00	1.80

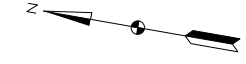

1. SOUNDED NOVEMBER 2 & 3, 2015 BY BOWEN ENGINEERING AND SURVEYING.
2. HORIZONTAL DATUM IS BASED ON THE NORTH AMERICAN DATUM OF 1927 (NAD 27). COORDINATES SHOWN ARE MISSOURI/EAST ZONE STATE PLANE.
3. VERTICAL DATUM IS BASED ON THE NATIONAL GEODETIC VERTICAL DATUM OF 1929 (NGVD 29).

DIKE 253.8(L)

DIKE 253.5(L)

DIKE 253.1(L)

SOUNDED NOVEMBER 2, 2015
SOUNDED NOVEMBER 3, 2015

253

252

E ISLAND

FOUR ACRE ISLAND

STERLING ISLAND

MISSOURI

NORTON WOOD ACCESS AREA

GAGE RECORD		L & D 24 LOWER		LMO 25 UPPER	
ZERO NGVD	421.81	MOSEER	400.0	407.0	407.0
MILE	273.2		263.1	241.5	241.5
L.W.R.P.	434.1		434.0	429.7	429.7
02 NOV 2015	X		X	X	X
03 NOV 2015	X		X	X	X

U.S. ARMY ENGINEER DIVISION CORPS OF ENGINEERS ST. LOUIS, MISSOURI		U.P.P.E.R. MISSISSIPPI RIVER BASIN		MISSISSIPPI RIVER	
Drawn by:	Reviewed by:	Submitted:	Approved:	File name:	Plot date:
X	X	X	X	20151103	20151103

HYDROGRAPHIC SURVEYS	
MILE: 251.7 - 253.5	

PLATE NUMBER
24

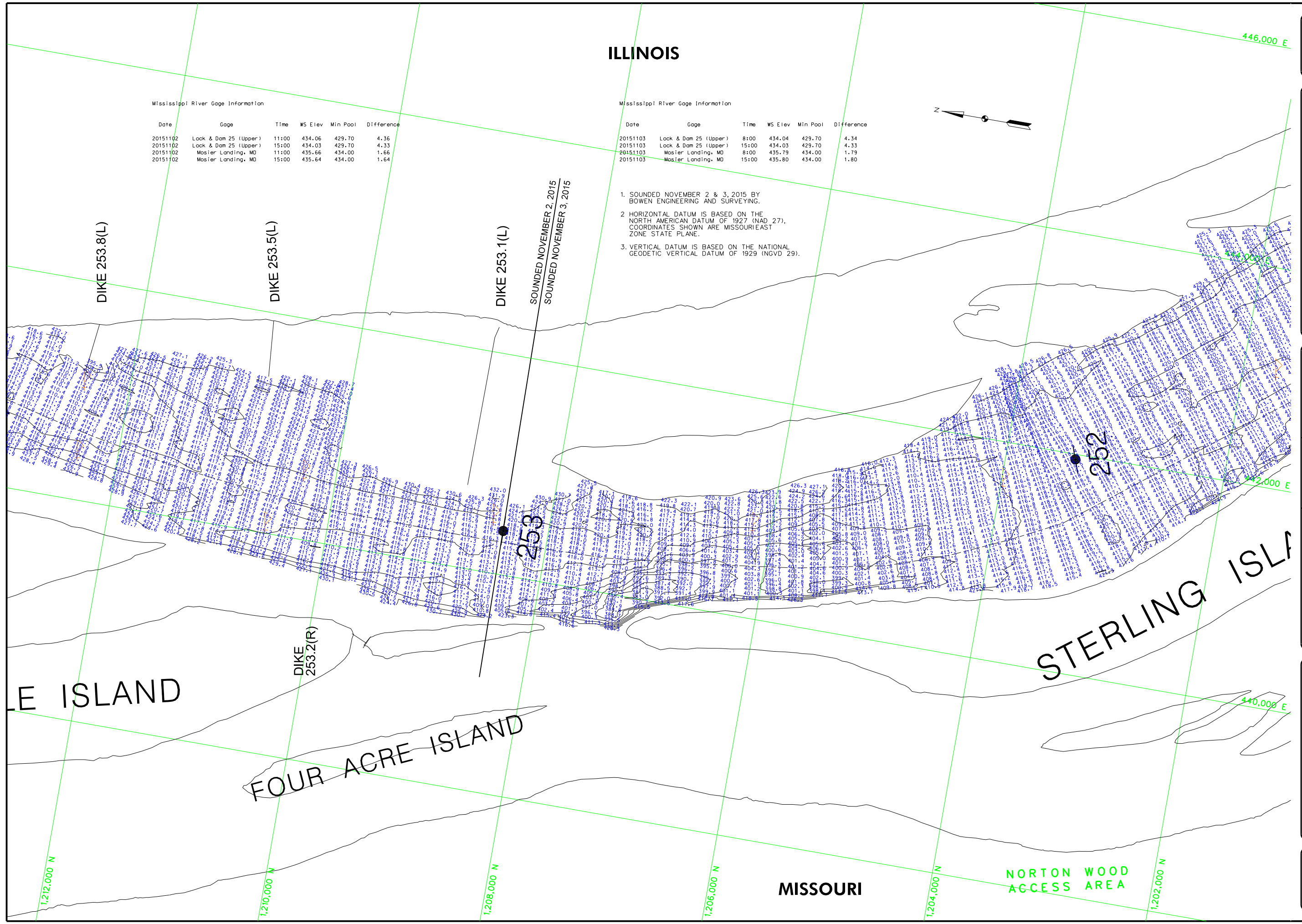

ILLINOIS

- 1. SOUNDED NOVEMBER 3, 2015 BY BOWEN ENGINEERING AND SURVEYING.
- 2. HORIZONTAL DATUM IS BASED ON THE NORTH AMERICAN DATUM OF 1927 (NAD 27). COORDINATES SHOWN ARE MISSOURI EAST ZONE STATE PLANE.
- 3. VERTICAL DATUM IS BASED ON THE NATIONAL GEODETIC VERTICAL DATUM OF 1929 (NGVD 29).



Mississippi River Gage Information

Date	Gage	Time	WS Elev	Mfn Pool	Difference
20151103	Lock & Dam 25 (Upper)	8:00	434.04	429.70	4.34
20151103	Lock & Dam 25 (Upper)	15:00	434.03	429.70	4.33
20151103	Mosier Landing, MO	8:00	435.79	434.00	1.79
20151103	Mosier Landing, MO	15:00	435.80	434.00	1.80

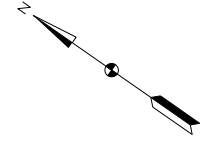

GAGE RECORD	
L & D 24 LOWER	MOSEY
421.81	400.0
273.2	260.1
434.1	434.0
X	X
35.798(30) 15.80(5(30))	27.048(30) 27.03(5(30))

DATE: 03 NOV 2015

ELEVATIONS ARE REFERRED TO I.C.E.A. - CONDITIONS ARE BELOW 1985-31 LOW WATER REFERENCE PLANE (L.W.R.P.) (1985) (L.S.)

SURVEYED BY		SURVEY DATE	
Drawn by	Reviewed by	NOVEMBER 3, 2015	NOVEMBER 3, 2015
X	X		
SUBMITTED:		APPROVED:	
X	X	X	X
FILE NAME: #BX2551103001.DWG		PLOT DATE: #BX2551103001.DWG	

U.S. ARMY ENGINEER DIVISION
CORPS OF ENGINEERS
ST. LOUIS, MISSOURI

UPPER MISSISSIPPI RIVER BASIN
MISSISSIPPI RIVER

170	0	100	240 METERS
400	0	800	FEET

THE INFORMATION DEPICTED ON THIS MAP REPRESENTS THE RESULTS OF SURVEYS CONDUCTED BY THE DISTRICT OF ST. LOUIS, MISSOURI, AND IS NOT TO BE USED FOR ANY OTHER PURPOSE WITHOUT THE EXPRESS WRITTEN PERMISSION OF THE DISTRICT OF ST. LOUIS, MISSOURI.

HYDROGRAPHIC SURVEYS

MILE: 249.8 - 251.7

PLATE NUMBER

25

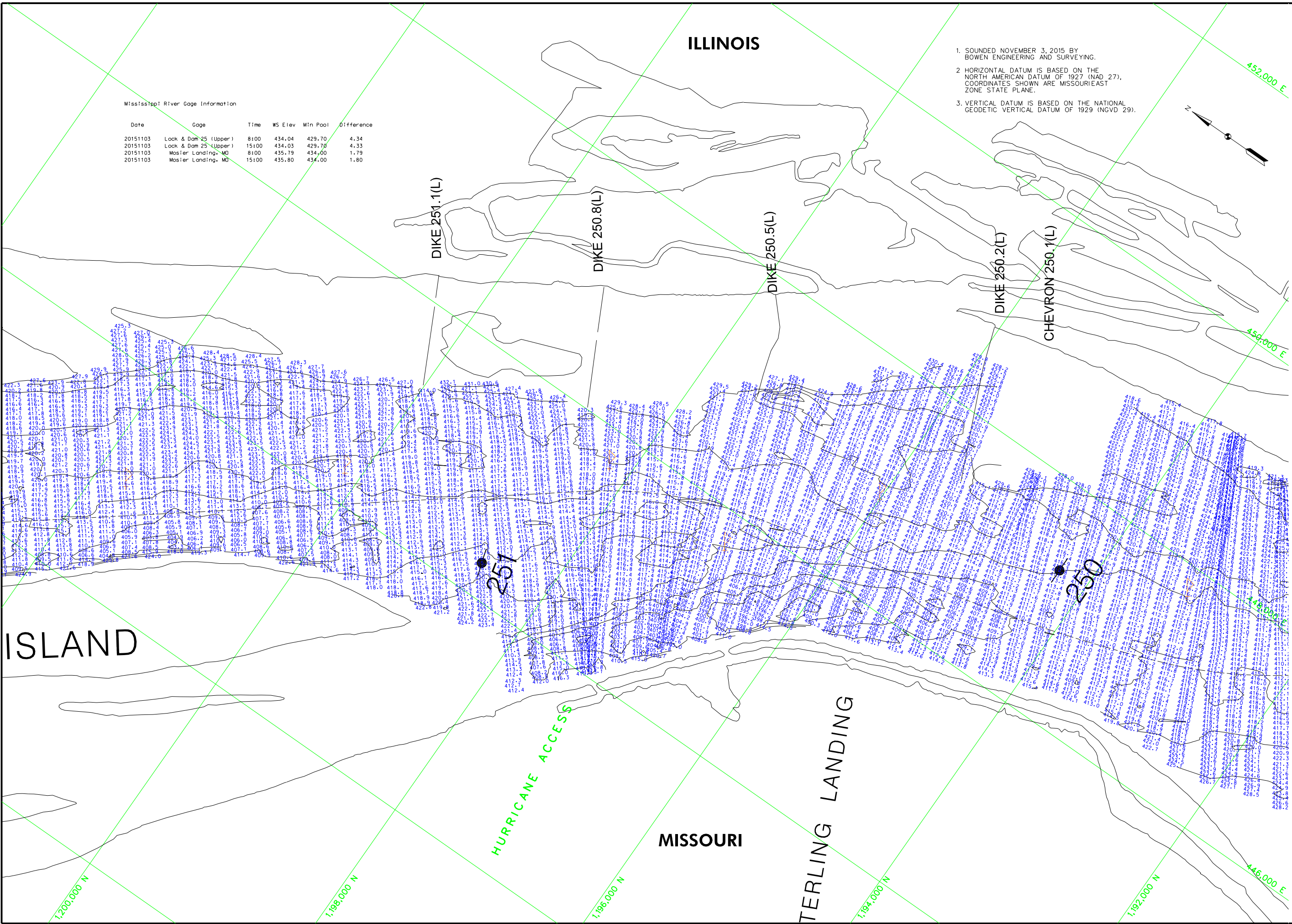

ISLAND

HURRICANE ACCESS

STERLING LANDING

MISSOURI

DIKE 251.1(L)

DIKE 250.8(L)

DIKE 250.5(L)

DIKE 250.2(L)

CHEVRON 250.1(L)

251

250

1,200,000 N

1,198,000 N

1,196,000 N

1,194,000 N

1,192,000 N

452,000 E

450,000 E

448,000 E

446,000 E



ILLINOIS

Mississippi River Gage Information

Date	Gage	Time	WS Elev	Min Pool	Difference
20151104	Lock & Dam 25 (Upper)	8:00	434.05	429.70	4.35
20151104	Lock & Dam 25 (Upper)	15:00	434.00	429.70	4.30
20151104	Mosier Landing, MO	8:00	436.22	434.00	2.22
20151104	Mosier Landing, MO	15:00	436.22	434.00	2.22

1. SOUNDED NOVEMBER 4, 2015 BY BOWEN ENGINEERING AND SURVEYING.
2. HORIZONTAL DATUM IS BASED ON THE NORTH AMERICAN DATUM OF 1927 (NAD 27). COORDINATES SHOWN ARE MISSOURI EAST ZONE STATE PLANE.
3. VERTICAL DATUM IS BASED ON THE NATIONAL GEODETIC VERTICAL DATUM OF 1929 (NGVD 29).

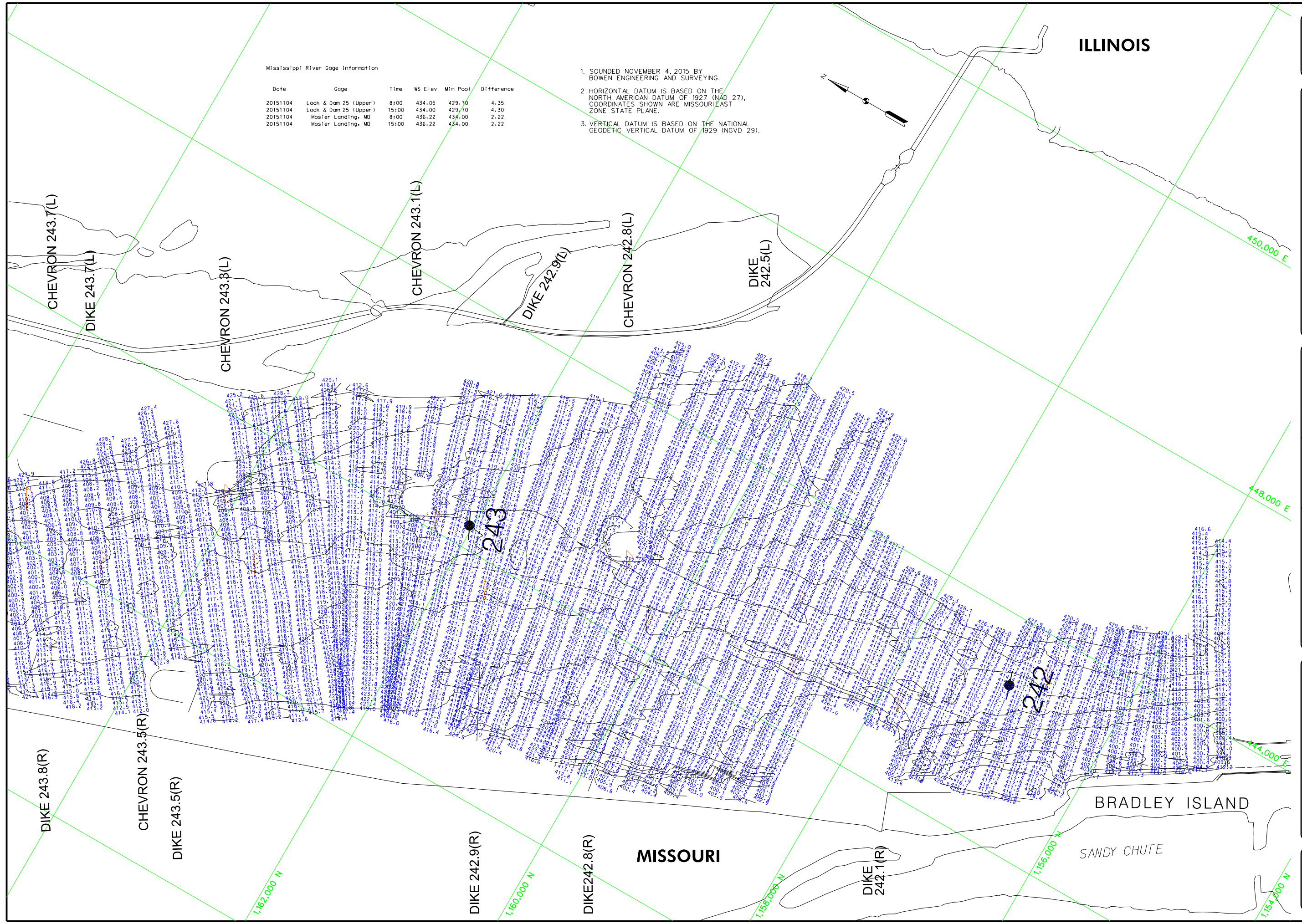
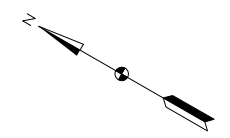

GAGE RECORD

L & D	24 LOWER	MOSIER	LMO 25 UPPER
ZERO NGVD	421.81	400.0	407.0
MILE	273.2	260.1	241.5
L.W.R.P.	434.1	434.0	429.7
04 NOV 2015	X	38.22(8:00), 38.22(15:00)	27.05(8:00), 27.05(15:00)

ELEVATIONS ARE REFERRED TO S.C.S. - CONTOURS ARE BELOW 1985-51 LOW WATER REFERENCE PLANE (L.W.R.P.) 1985-51

Surveyed by: BOWEN ENGINEERING	Survey Date: NOVEMBER 4, 2015	Drawn by: X	Reviewed by: X	Cad by: X
SUBMITTED: X		APPROVED: X		Plot date: #DATE/TIME/###
U.S. ARMY ENGINEER DIVISION CORPS OF ENGINEERS ST. LOUIS, MISSOURI				
UPPER MISSISSIPPI RIVER BASIN MISSISSIPPI RIVER				

170 0 100 240 METERS
400 0 400 800 FEET

THE INFORMATION DEPICTED ON THIS MAP REPRESENTS THE RESULTS OF SURVEYS CONDUCTED UNDER THE GENERAL CONDITIONS SPECIFIED IN THE CONTRACT DOCUMENTS. THE GENERAL CONDITIONS SPECIFIED IN THE CONTRACT DOCUMENTS SHALL BE CONSIDERED AS INDICATING THE GENERAL CONDITIONS OF CONTRACT.

HYDROGRAPHIC SURVEYS

MILE: 241.6 - 243.7

MISSOURI

BRADLEY ISLAND

SANDY CHUTE